

OFFICE OF THE
DOUGLAS COUNTY SURVEYOR

L-014

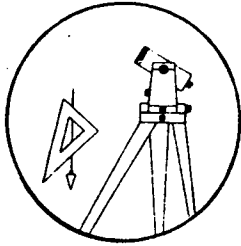

Station: L 501 T 31 S, R 2 W, Sec 14
Set By (Agency): USC&GS
Date Set: 1949
Recovered By R.S., S.J.F.
Date Recovered Feb. 17, 1984
Recovered By _____
Date Recovered _____
Recovered By _____
Date Recovered _____

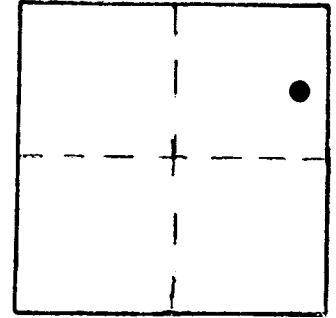

VERTICAL CONTROL CORPSCOM 6 NAVD88 1353.884 FT.

Elevation: 1,350.375 NGS Line # 129 USGS Line # _____ OSHD Line # _____
Precision: 2nd. Agency: USC&GS Proj. # _____ Date: 1957

HORIZONTAL CONTROL

South Zone State Plane Coordinates: Y(Northing) 452717 X(Easting) 4277118
Precision: GIS SCALED Agency: DCSO Proj. # _____ Date: 2014
Approximate Geographic Position: Latitude _____ Longitude _____

DESCRIPTION and TO REACH

SKETCH

A USC&GS disk stamped "501 1949" set flush on a large boulder.

To Reach:

Go to Drew Store at Drew, IN T31S, R2W Sec. 14; monument is northeast from northeast corner of store and across State Highway 227.

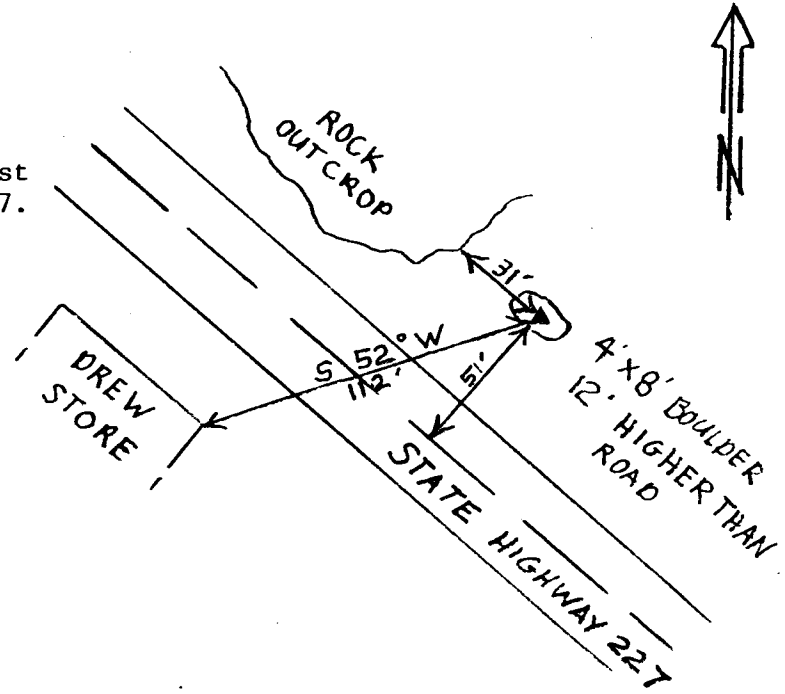

Reference Marks:

Note: For further information, contact the Douglas County Surveyor's Office, Room 205 Douglas County Justice Building, Roseburg, OR 97470. Phone 440-4278. Douglas County residents outside the Roseburg calling area, dial toll free 1-800-452-0991.