

OFFICE OF THE  
DOUGLAS COUNTY SURVEYOR

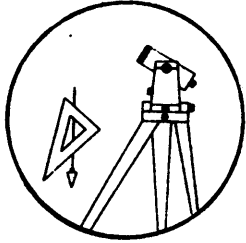

L-013

Station: L 500 T 30 S, R 3W, Sec 25  
 Set By (Agency): USC&GS  
 Date Set: 1949  
 Recovered By JP-RS  
 Date Recovered 3-18-82  
 Recovered By RWS, STE FIDOK 5/29/98  
 Date Recovered \_\_\_\_\_  
 Recovered By \_\_\_\_\_  
 Date Recovered \_\_\_\_\_

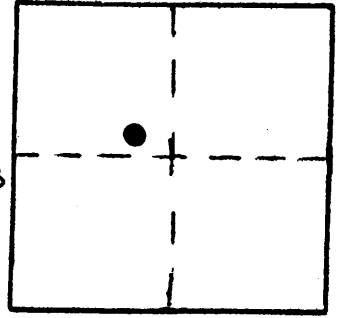

VERTICAL CONTROL NGVD 29

Elevation: 946.865 NGS Line # 130 USGS Line # \_\_\_\_\_ OSHD Line # \_\_\_\_\_  
 Precision: 2nd Agency: USC&GS Proj. # \_\_\_\_\_ Date: 1957

HORIZONTAL CONTROL

South Zone State Plane Coordinates: Y(Northing) \_\_\_\_\_ X(Easting) \_\_\_\_\_  
 Precision: \_\_\_\_\_ Agency: \_\_\_\_\_ Proj. # \_\_\_\_\_ Date: \_\_\_\_\_  
 Approximate Geographic Position: Latitude 42° 56' 18" Longitude 123° 00' 40"

DESCRIPTION and TO REACH

Found: A standard USC&GS disk stamped "L 500 1949" set in a 12" diam. concrete post 6" above the ground.

To reach: From the intersection of St. Hwy. 227 and BLM Rd. 30-3-26.0 (Corn Creek) in T30S R3W sec. 26, proceed Easterly along St. Hwy. 227 .95 miles to monument on the left.

SKETCH

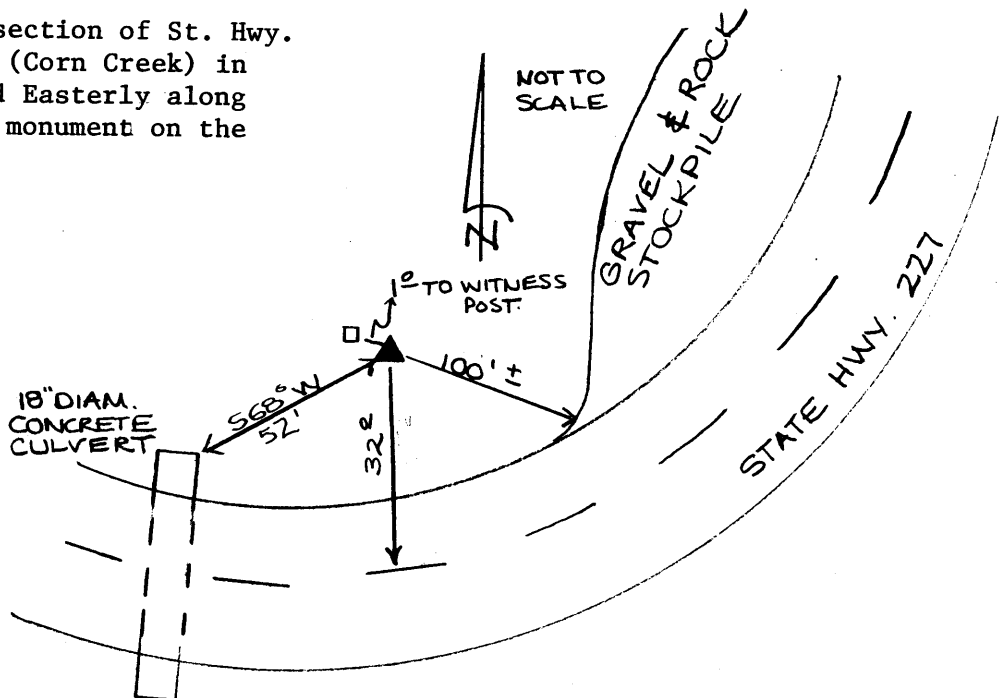

Reference Marks:

Note: For further information, contact the Douglas County Surveyor's Office, Room 205 Douglas County Justice Building, Roseburg, OR 97470. Phone 440-4278. Douglas County residents outside the Roseburg calling area, dial toll free 1-800-452-0991.