

# Douglas County Geodetic Data Sheet

T 25 R 05 S 04

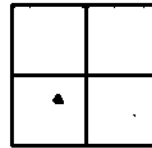

Station: L 10  
 Date Set: 1917 Set By (Agency): USGS  
 Last Date Recovered: 09/00/1993

Designation: L-002

## VERTICAL CONTROL

NGVD 29 Elevation:	430.173 Feet		
Precision:	1ST ORDER	Agency: USC&GS	Project: Date: 1957
NAVD 88 Elevation:	132.189 Meters		
Precision:	1ST ORDER	Agency: USGS	Project: Date: 1988
NGS Line #	USGS Line #	OSHD Line #	File #

## HORIZONTAL CONTROL

OCS 27	Y(Northing): 652,114.56	X(Easting): 1,256,720.07	Lat	Long:
Precision:	1/25,000	Agency: DCSO	Project: 2006	Date: 1981
OCS 83	Y(Northing): 652,080.03	X(Easting): 4,177,679.39	Lat: 43°25'18"	Long: 123°17'58"
Precision:	Agency:	Project:	Date:	
OCS 83/91	Y(Northing):	X(Easting):	Lat:	Long:
Precision:	Agency:	Project:	Date:	
OCS 27 Scaled Latitude:	43°25'19"	OCS 27 Scaled Longitude:	123°17'54"	

## DESCRIPTION:

A 4 INCH DIAMETER USGS DISK STAMPED; PRIM TRAV STA NO9 429 L 10 B 1903 1917; SET IN CONCRETE APPROX 2 INCHES BELOW MOWN LAWN SURFACE.

## COMMENTS:

GO TO THE INTERSECTION OF STATE HWY 99 AND LOCUST ST IN T25S R5W SEC 4 - IN OAKLAND. MONUMENT IS WESTERLY OF INTERSECTION IN SMALL PARK.

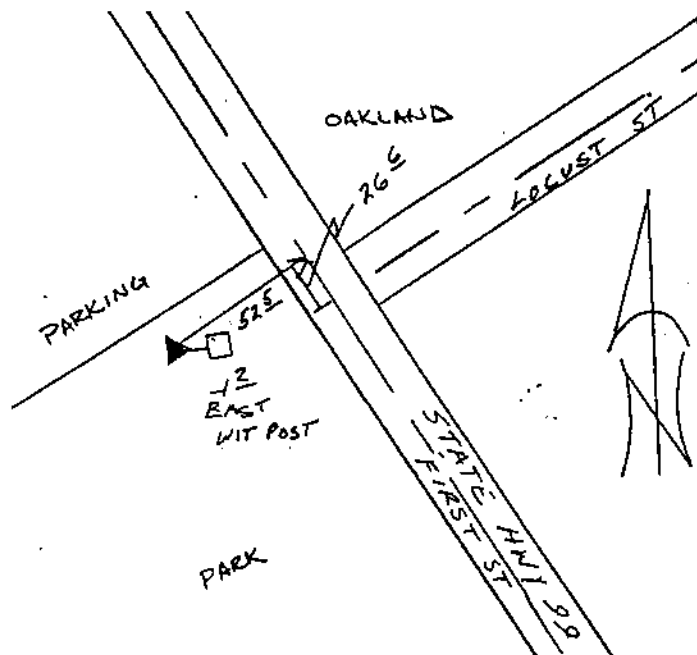

Note: For further information contact the Douglas County Surveyors Office, Room 105A Douglas County Courthouse, Roseburg, OR 97470. Phone 440-4272 or Fax (541)957-8150. Douglas County Residents outside Roseburg calling area, dial toll free 1-800-224-1619.