

OFFICE OF THE
DOUGLAS COUNTY SURVEYOR

Station: K476 T 26 S, R 3 W, Sec 12
 Set By (Agency): USC&GS
 Date Set: 1941
 Recovered By SJF, RWS
 Date Recovered June 26, 1986
 Recovered By _____
 Date Recovered _____
 Recovered By _____
 Date Recovered _____

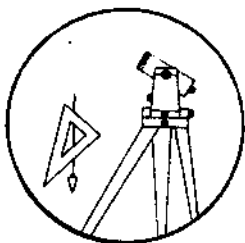

K-035

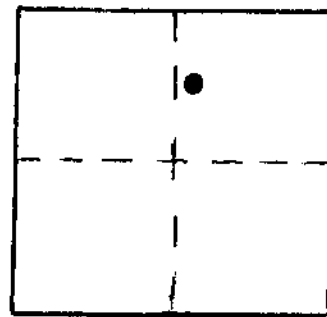

VERTICAL CONTROL NGVD 29

Elevation: 787.367 ft. NGS Line # 94 USGS Line # _____ OSHD Line # _____
 Precision: 1st. Agency: USC&GS Proj. # 2013 Date: 1961

HORIZONTAL CONTROL

South Zone State Plane Coordinates: Y(Northing) _____ X(Easting) _____
 Precision: _____ Agency: _____ Proj. # _____ Date: _____
 Approximate Geographic Position: Latitude _____ Longitude _____

DESCRIPTION and TO REACH

SKETCH

A USC&GS disk stamped "K476 1941"
set flush in a 7x3x2 foot high rock outcrop.

TO REACH:

From the intersection of North Umpqua Highway (State Highway 138) and Swiftwater Road (USFS Rd. #26-3-1.1) in T26S,R3W,Sec. 1 proceed southeasterly along North Umpqua Highway 0.6 miles to monument on right.

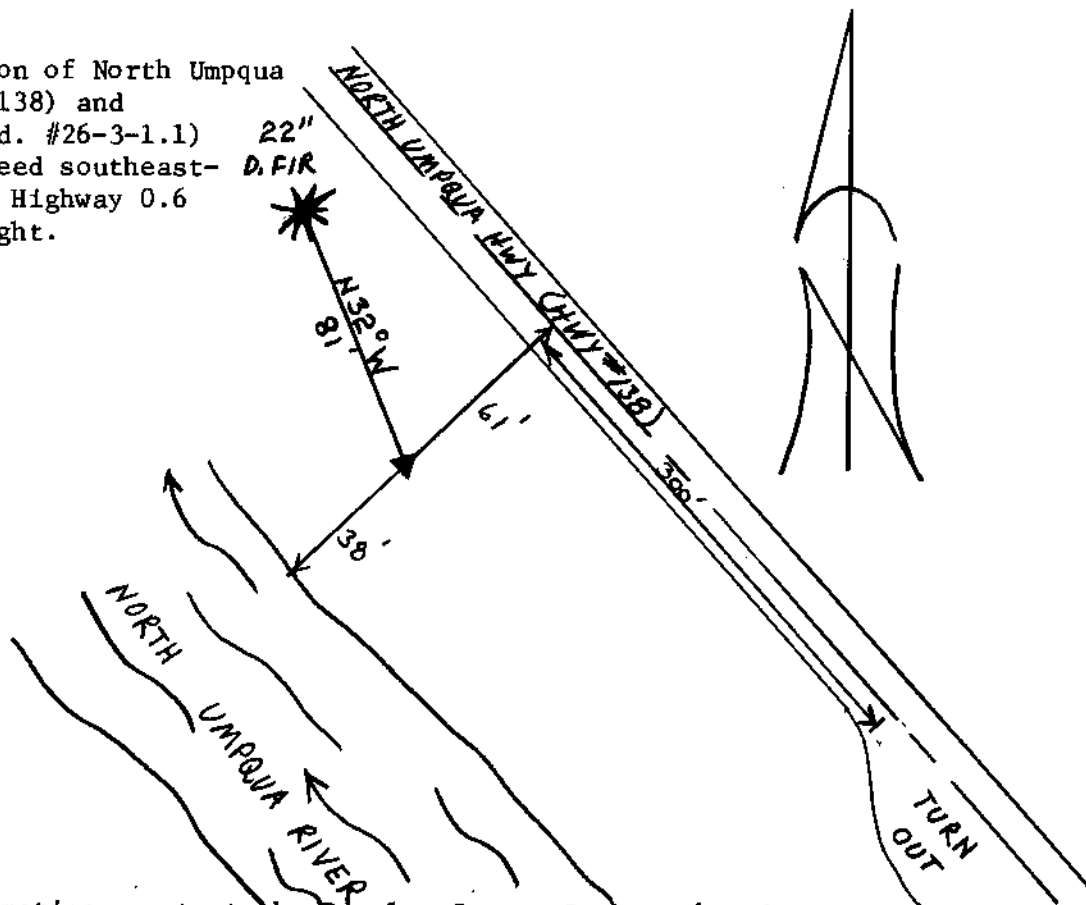

Reference Marks:

Note: For further information, contact the Douglas County Surveyor's Office, Room 205 Douglas County Justice Building, Roseburg, OR 97470. Phone 440-4278. Douglas County residents outside the Roseburg calling area, dial toll free 1-800-452-0991.