

OFFICE OF THE  
DOUGLAS COUNTY SURVEYOR

Station: KOW 1979 T 27 S, R 5 W, Sec 20  
 Set By (Agency): DCSO  
 Date Set: 1979  
 Recovered By JP, RS  
 Date Recovered 8/10/83  
 Recovered By DCSO 7/98  
 Date Recovered \_\_\_\_\_  
 Recovered By \_\_\_\_\_  
 Date Recovered \_\_\_\_\_

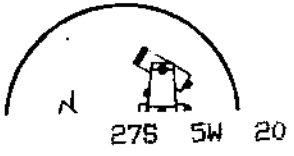
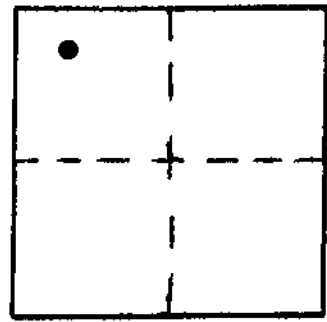

K-029  
KOW

NAD 576163.51 4169639.34  
83 43°12'46" 123°19'12"

NGVD 29

VERTICAL CONTROL

Elevation: 489<sup>13</sup> NGS Line # \_\_\_\_\_ USGS Line # \_\_\_\_\_ OSHD Line # \_\_\_\_\_  
 Precision: 3<sup>rd</sup> Agency: DCSO Proj. # 2007 Date: 7/98

HORIZONTAL CONTROL OCS 27

South Zone State Plane Coordinates: Y(Northing) 576,198.76 X(Easting) 1,248,681.03  
 Precision: 1/25,000 Agency: DCSO Proj. # 2008 Date: 1980  
 Approximate Geographic Position: Latitude 43°12'47" Longitude 123°19'08"

DESCRIPTION and TO REACH

SKETCH

DESCRIPTION:

A DCSO disk stamped "KOW 1979" set flush in concrete sidewalk.

TO REACH:

From the intersection of Diamond Lake Blvd. and NE Cummins St. proceed westerly along Diamond Lake Blvd. 196 ft. to monument on left.

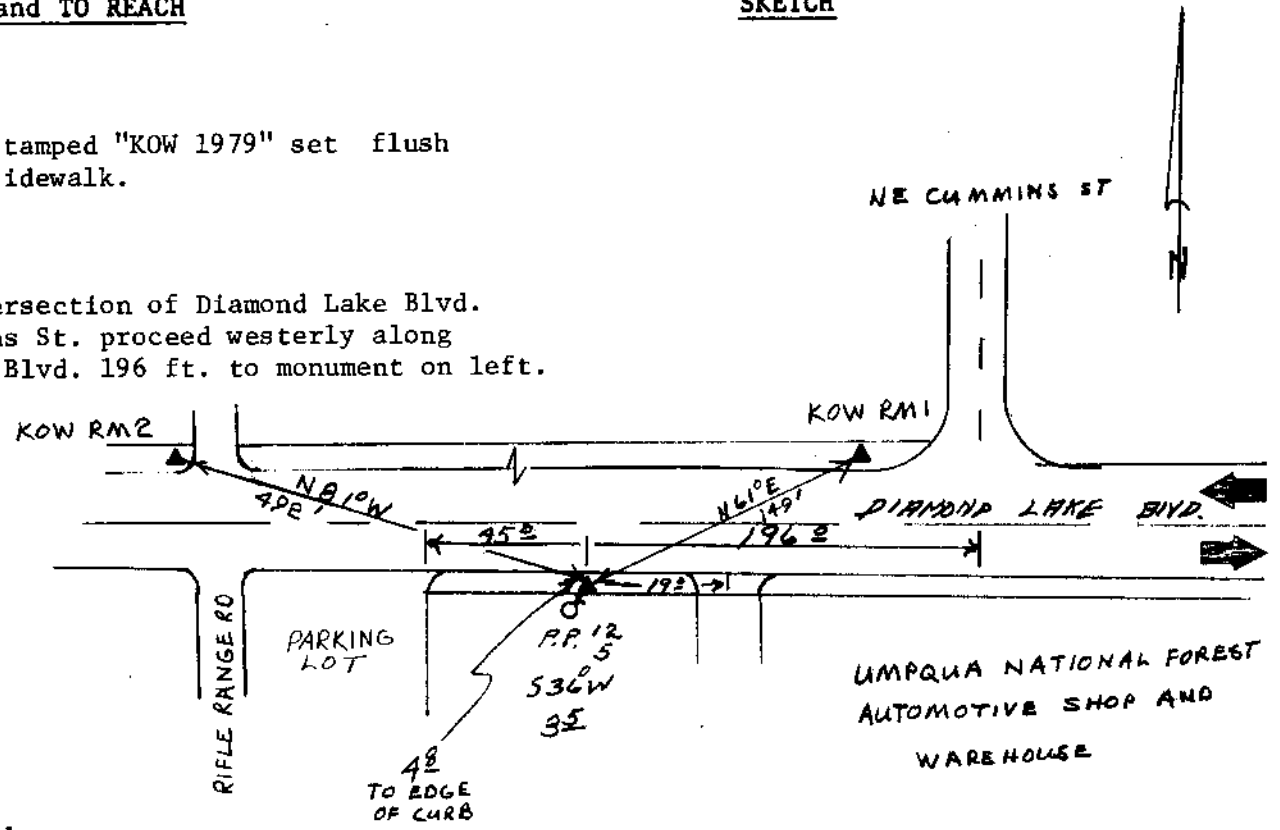

Reference Marks:

A DCSO disk stamped "KOW RM1 1979" bears N 62°39'49" E, 148.72 ft. (grid) **ELEV. 491<sup>16</sup> 3<sup>rd</sup>**  
 A DCSO disk stamped "KOW RM2 1979" bears N 78°45'22" W, 491.95 ft. (grid) **ELEV. 481<sup>11</sup> 3<sup>rd</sup>**

Note: For further information, contact the Douglas County Surveyor's Office, Room 205 Douglas County Justice Building, Roseburg, OR 97470. Phone 440-4278. Douglas County residents outside the Roseburg calling area, dial toll free 1-800-452-0991.