

OFFICE OF THE
DOUGLAS COUNTY SURVEYOR

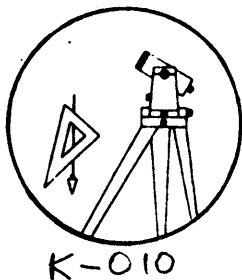

Station: K 499 T 30 S, R 5 W , Sec 17
 Set By (Agency): USC&GS
 Date Set: 1949
 Recovered By RS, PB
 Date Recovered 10/25/83
 Recovered By RWS - SJF
 Date Recovered 2-5-02
 Recovered By _____
 Date Recovered _____

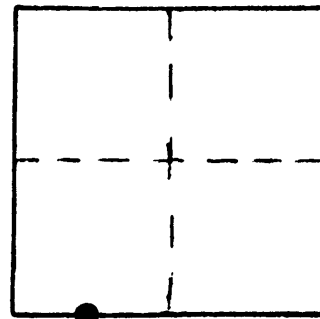

VERTICAL CONTROL NGVD 29

Elevation: 666.029 NGS Line # 130 USGS Line # _____ OSHD Line # _____
 Precision: 2nd Agency: USC&GS Proj. # _____ Date: 1957

HORIZONTAL CONTROL

South Zone State Plane Coordinates: Y(Northing) _____ X(Easting) _____
 Precision: _____ Agency: _____ ~~FILE~~ Proj. # R022600D Date: _____
 Approximate Geographic Position: Latitude 42° 57' 21.1" Longitude 123° 19' 05.9"

DESCRIPTION and TO REACH

SKETCH

DESCRIPTION:

A disk stamped "K 499 1949" set on a concrete filled tile protruding 4 in. above ground.

TO REACH:

From the Gazley Rd. (Co. Rd. #35A, exit #102) overpass of I-5 in T30S, R5W, Sec.19, proceed easterly along Gazley Rd. 0.6 miles to monument on the left.

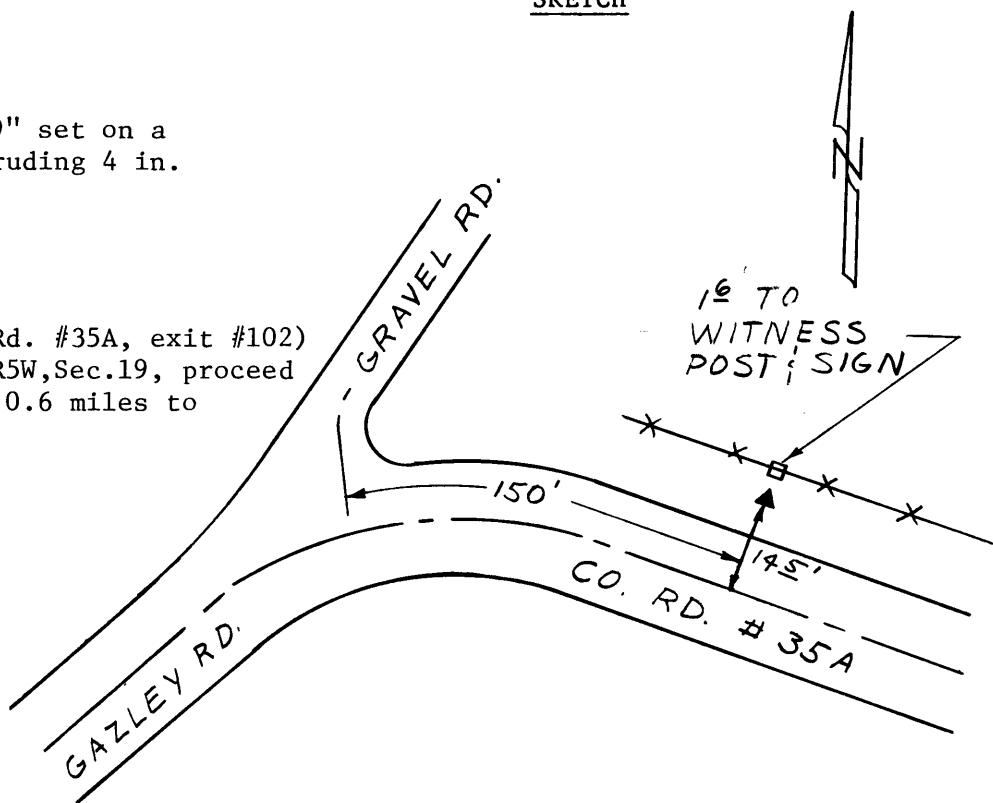

Reference Marks:

Note: For further information, contact the Douglas County Surveyor's Office, Room 205 Douglas County Justice Building, Roseburg, OR 97470. Phone 440-4278. Douglas County residents outside the Roseburg calling area, dial toll free 1-800-452-0991.