

OFFICE OF THE  
DOUGLAS COUNTY SURVEYOR

Station: J 739

T22S R5W Sec. 17

Date Set: 1987

Set By (Agency): NGS

DCSO Designation: J-044

Date Recovered: 8-93

Recovered By: RWS S.JF

Date Recovered: \_\_\_\_\_

Recovered By: \_\_\_\_\_

Date Recovered: \_\_\_\_\_

Recovered By: \_\_\_\_\_

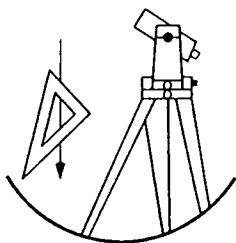
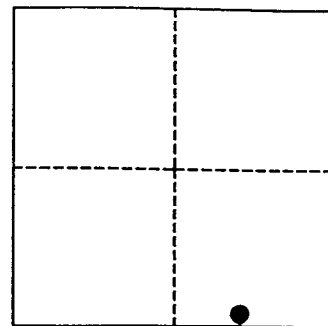

VERTICAL CONTROL

~~NGVD 29~~ <sup>NAVD 88</sup> Elevation: 347.953 FEET      NAVD 88 Elevation: 106.056 METERS

NGS Line # L25035    USGS LINE # \_\_\_\_\_    OSHD Line # \_\_\_\_\_    FILE # \_\_\_\_\_

Precision: 1ST ORDER    Agency: NGS    Proj: \_\_\_\_\_    Date: 1988

HORIZONTAL CONTROL

O.C.S. 27    Y(Northing): \_\_\_\_\_    O.C.S. 83    Y(Northing): 735211

(South Zone)    X(Easting): \_\_\_\_\_    (South Zone)    X(Easting): 4177042

Precision: GIS SCALED    Agency: DCSO    Proj: \_\_\_\_\_    Date: 2014

Approx. O.C.S. 27 Geographic Position:    Latitude: 43°38'59"    Longitude: 123°18'43"

Approx. O.C.S. 83 Geographic Position:    Latitude: \_\_\_\_\_    Longitude: \_\_\_\_\_

Found: A 9/16 inch diameter stainless steel rod set under a 6 - 7/8 inch diameter aluminum collar and access cover, set in concrete, rim of access cover collar is stamped "J 739 1987". Flush with ground.

To reach: From the intersection of Boswell Road (Co. Rd. #54) and Eagle Valley Road (Co. Rd. #389) (also old Hwy 99N) in T22S R5W Sec. 21 proceed northwesterly along state Hwy 99 1.15 miles to mile point 1.1 (from drain) and monument on left.

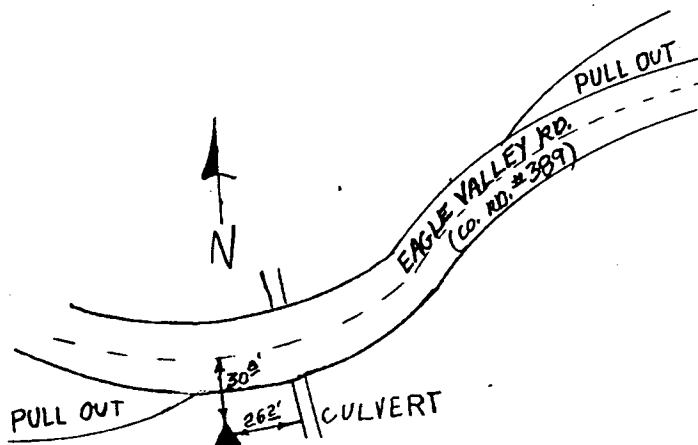

Note: For further information contact the Douglas County Surveyors Office, Room 205 Douglas County Justice Building, Roseburg, OR 97470. Phone 440-4272. Douglas County Residents outside Roseburg calling area, dial toll free 1-800-477-0991.