

OFFICE OF THE
DOUGLAS COUNTY SURVEYOR

Station: JIM T 27 S, R 3 W, Sec 3
 Set By (Agency): DCSO
 Date Set: 1972
 Recovered By RWS,SJF
 Date Recovered 11/20/84
 Recovered By Harry Heislein (USFS)
 Date Recovered Fall 1985
 Recovered By _____
 Date Recovered _____



j-023
JIM

27S 3W 3

NAD 586138.71 4246513.80
 83 43°14'49" 123° 1'59"

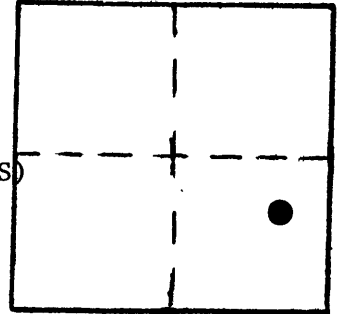

VERTICAL CONTROL

Elevation: _____ NGS Line # _____ USGS Line # _____ OSHD Line # _____
 Precision: _____ Agency: _____ Proj. # _____ Date: _____

HORIZONTAL CONTROL NAD 27

South Zone State Plane Coordinates: Y(Northing) 586,174.83 X(Easting) 1,325,553.96
 Precision: 1/25,000 Agency: DCSO Proj. # 2004-1 CS#57/3 Date: 1973
 Approximate Geographic Position: Latitude 43°14'50" Longitude 123°01'55"

DESCRIPTION and TO REACH

SKETCH

A DCSO disk stamped "JIM 1972" set in a 8" dia. concrete filled tile protruding 6 in. above ground.

TO REACH:

From the intersection of Little River Rd. (Co.Rd.#17) and Cavitt Creek Rd. (Co.Rd.#85) in T27S,R3W,Sec.2, proceed southerly along Cavitt Creek Rd. 0.15 miles to its intersection with Jim Creek Rd. (BLM Rd. #27-3-11); proceed southwesterly 1.7 miles along Jim Creek Rd. to its intersection with BLM Rd. #27-3-10.1; proceed northeasterly 2.15 miles along BLM Rd. #27-3-10.1 to monument on right.

Shown on USGS Quads: Dixonville 15' Quad.
 Lane Mtn. 7 1/2' Quad.

Reference Marks:

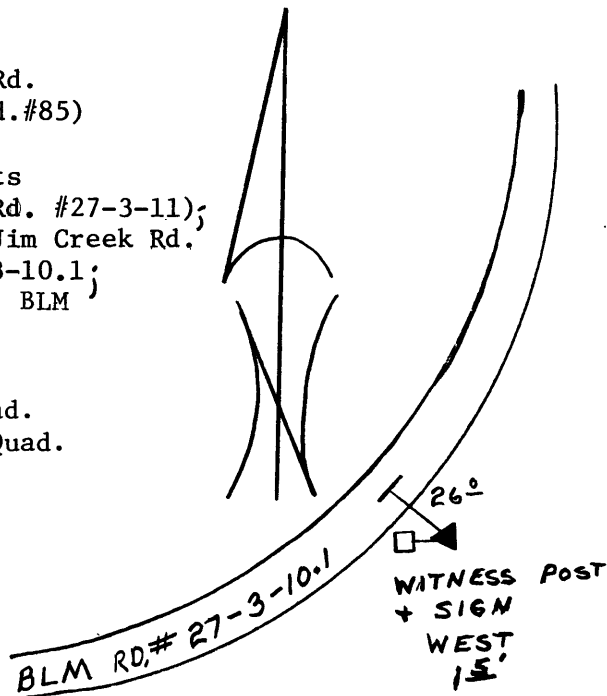

Note: For further information, contact the Douglas County Surveyor's Office, Room 205 Douglas County Justice Building, Roseburg, OR 97470. Phone 440-4278. Douglas County residents outside the Roseburg calling area, dial toll free 1-800-452-0991.