

OFFICE OF THE
DOUGLAS COUNTY SURVEYOR

Station: Jane
 Date Set: 1974
 Set By (Agency): DCSO
 Date Recovered: 8-19-91
 Recovered By: SJF
 Date Recovered: _____
 Recovered By: _____
 Date Recovered: _____
 Recovered By: _____

T 26 S, R 6W, Sec 18



J-017
JANE

26S 6W 18

NAD 612539.39 4136031.97
 83 49°18'34" 129°27' 3"

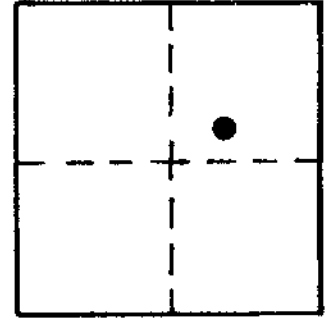

VERTICAL CONTROL NGS/D 29

Elevation: 427.836 NGS Line # _____ USGS Line # _____ OSHD Line # _____
 Precision: 2nd Agency: DCSO Proj. # 2007 Date: 1991

HORIZONTAL CONTROL

South Zone O.C.S. 27: Y(Northing) 612,574.31 X(Easting) 1,215,073.28
 South Zone O.C.S. 83: Y(Northing) _____ X(Easting) _____
 Precision: 1/25,000 Agency: DCSO Proj. # 2006 River Floodplain Date: 1974
 Approx. NAD 83 Geographic Position: Latitude _____ Longitude _____

DESCRIPTION and TO REACH

Found: A standard DCSO cap stamped "Jane 1974" set flush in top of 8" O.D. 42" concrete-filled belltile. Mon. protrudes approx. 6" above ground and is approx. 2 ft. higher than road surface near the westerly R/W fenceline
 To reach: From the intersection of Upper Cleveland Rapids Rd. (Co. Rd. #208A) and Garden Vly. Rd. (Co. Rd. #6) in T26S, R6W, sec. 20. proceed northerly along Garden Valley Rd. 1.05 mi. to mon. on lt. at approx. milepost 9.6 and about 300 ft. southerly from intersection with Turkey Crk. Ln.

SKETCH

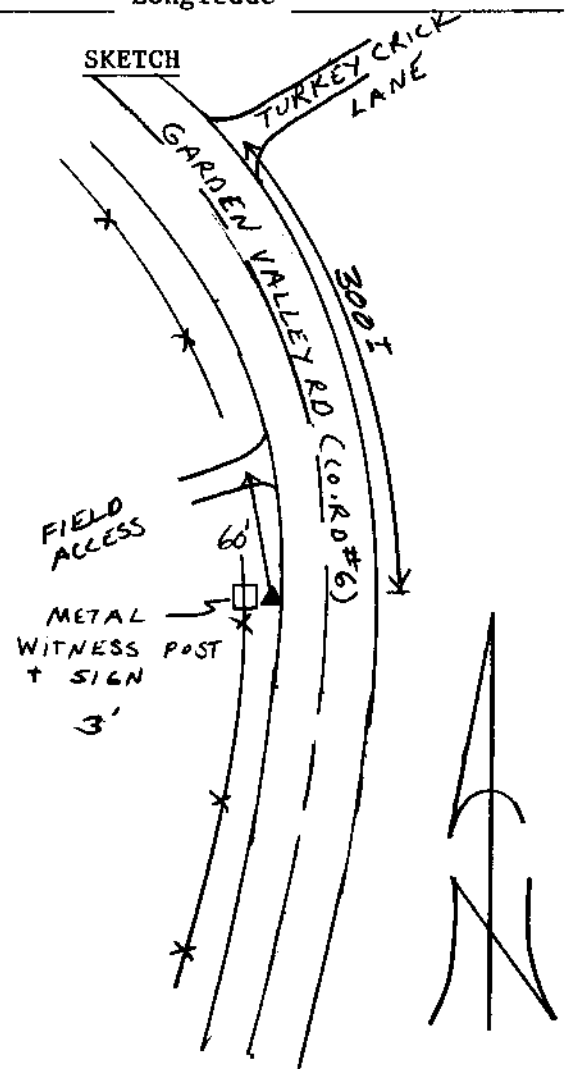

Reference Marks:

Note: For further information, contact the Douglas County Surveyor's Office, Room 205 Douglas County Justice Building, Roseburg, OR 97470. Phone 440-4278. Douglas County residents outside the Roseburg calling area, dial toll free 1-800-452-0991.