

OFFICE OF THE  
DOUGLAS COUNTY SURVEYOR

Station: HOPPE  
Date Set: 1998

T 27 S, R 5W, Sec 19

H-069

Set By (Agency): CITY OF ROSEBURG  
Date Recovered: JUNE 27 1998  
Recovered By: SJF

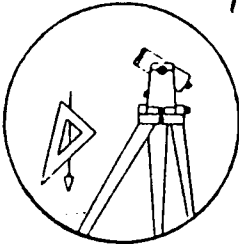
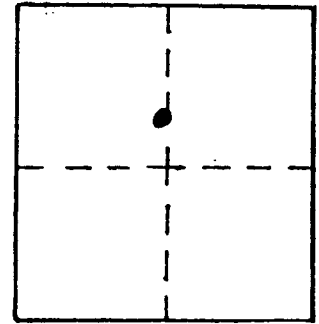

- Found
- New
- Reset
- Not Found
- Referenced
- Destroyed

VERTICAL CONTROL

Elevation: 558.89 NGS Line # \_\_\_\_\_ USGS Line # \_\_\_\_\_ OSHD Line # \_\_\_\_\_  
Precision: 3rd Agency: DCSO CS# 66/57 Proj. # 2007 Date: 1998

HORIZONTAL CONTROL CORPSCON6 NAVD88 562.36 FT.

South Zone O.C.S. 27: Y(Northing) \_\_\_\_\_ X(Easting) \_\_\_\_\_

South Zone O.C.S. 83: Y(Northing) 575141 X(Easting) 4165200

Precision: GIS SCALED Agency: DCSO Proj. # \_\_\_\_\_ Date: 2014

Approx. NAD 83 Geographic Position: Latitude 43° 12' 06" Longitude 123° 20' 09"  
12-59 20-13

DESCRIPTION and TO REACH

A 1 INCH DIAMETER CITY OF ROSEBURG DISK SET FLUSH IN TOP OF CONCRETE CURBING EDGING A CONCRETE SIDEWALK.

MONUMENT IS AT THE INTERSECTION OF SE DOUGLAS AVENUE (CO. RD. #4A) AND SE CLAIRE STREET IN T27S, R5W, SEC. 19.

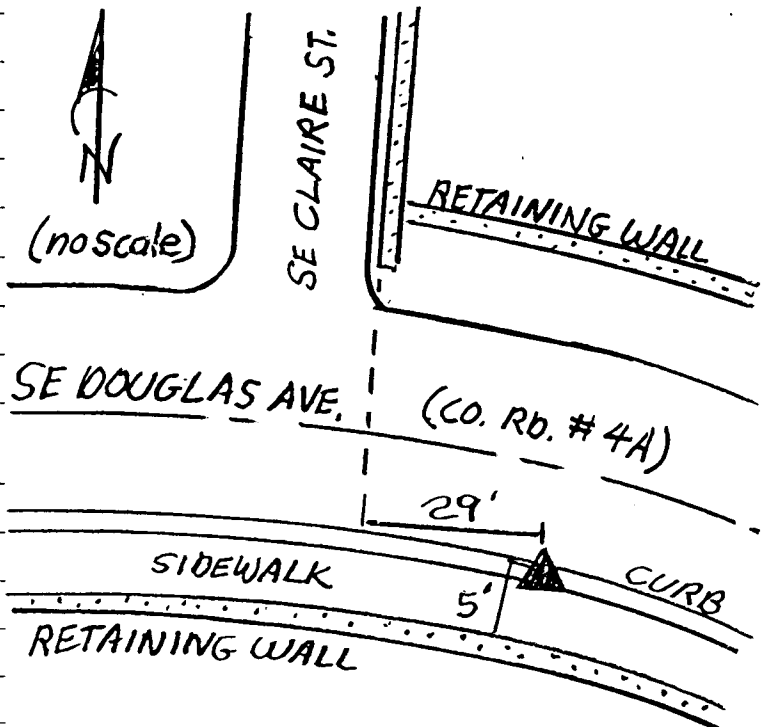

Reference Marks: