

OFFICE OF THE
DOUGLAS COUNTY SURVEYOR

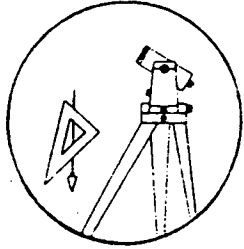

DESIG. H-062

Station: HEWES
Date Set: 1990
Set By (Agency): DCSO
Date Recovered: 1/8/91
Recovered By: SJF - TF
Date Recovered: _____
Recovered By: _____
Date Recovered: _____
Recovered By: _____

T 29 S, R 4W , Sec 8

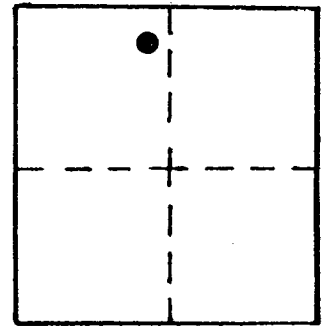

VERTICAL CONTROL

Elevation: 800.642 NGS Line # _____ USGS Line # _____ OSHD Line # _____

Precision: 2nd Agency: DCSO Proj. # 2007 Date: 1991

HORIZONTAL CONTROL CORPSCON6 NAVD88 804.068 FT. CS 66/43

South Zone O.C.S. 27: Y(Northing) _____ X(Easting) _____

South Zone O.C.S. 83: Y(Northing) 523038 X(Easting) 4200276

Precision: _____ Agency: _____ Proj. # _____ Date: _____

Approx. NAD ⁸³ Geographic Position: Latitude 43°04'12" Longitude 123°11'51"

DESCRIPTION and TO REACH

A standard DCSO disk stamped "HEWES 1990" set in a 8" x 40" concrete filled belltile protruding 6" above ground.

To reach:

From the intersection of North Myrtle Rd. (Co. Rd. #15) and Bilger Creek Rd. (Co. Rd. #103) in T29S, R5W, sec. 14 proceed northeasterly along North Myrtle Rd. 4.10 mi. to mon. on the left.

SKETCH

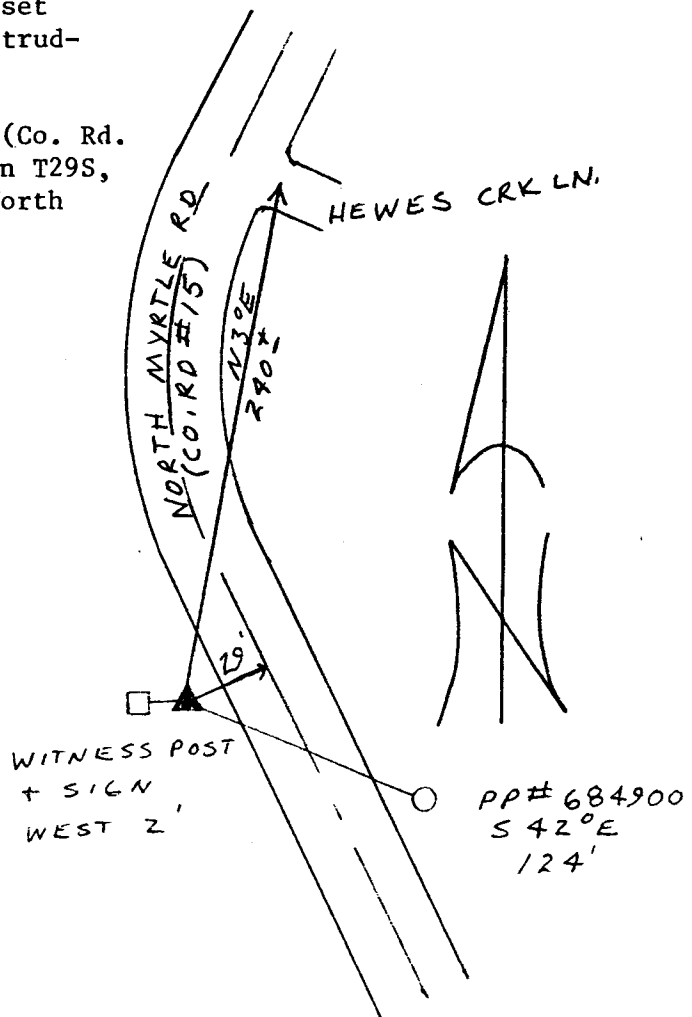

Reference Marks:

Note: For further information, contact the Douglas County Surveyor's Office, Room 205 Douglas County Justice Building, Roseburg, OR 97470. Phone 440-4278. Douglas County residents outside the Roseburg calling area, dial toll free 1-800-452-0991.