

OFFICE OF THE
DOUGLAS COUNTY SURVEYOR

Station: HINKLE T 24 S, R 3W, Sec 31

Set By (Agency): DCSO

Date Set: 1975

Recovered By RWS, S.J.F

Date Recovered 2/24/87

Recovered By _____

Date Recovered _____

Recovered By _____

Date Recovered _____

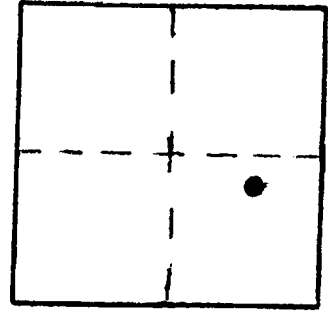

H-043
HINKLE

24S 3W 31

NAD 656587.68 4232633.01
83 43°26'20" 123° 5'36"

H-043

VERTICAL CONTROL NAVD 29 CORPSCOM 6 NAVD 08 849.092 FT

Elevation: 845.455 NGS Line # _____ USGS Line # _____ OSHD Line # _____

Precision: 2nd Agency: DCSO Proj. # 6011-1 Date: 1975

HORIZONTAL CONTROL

NAVD 27
South Zone State Plane Coordinates: Y(Northing) 656,623.13 X(Easting) 1,311,672.60

Precision 1/25,000 Agency: DCSO Proj. # 6011-1 Date: 1975

Approximate Geographic Position: Latitude 43°26'21" Longitude 123°05'32"

DESCRIPTION and TO REACH

SKETCH

A DCSO disk stamped "HINKLE 1975" set in a 8 in. dia. concrete filled belltile, protrudes 2 in. above ground.

TO REACH:

Go to the intersection of Hinkle Creek Rd. (Co.Rd. #281) and Nonpariel Rd. (Co.Rd. #19) in T24S,R3W,Sec.31. Monument is at northeast corner of intersection.

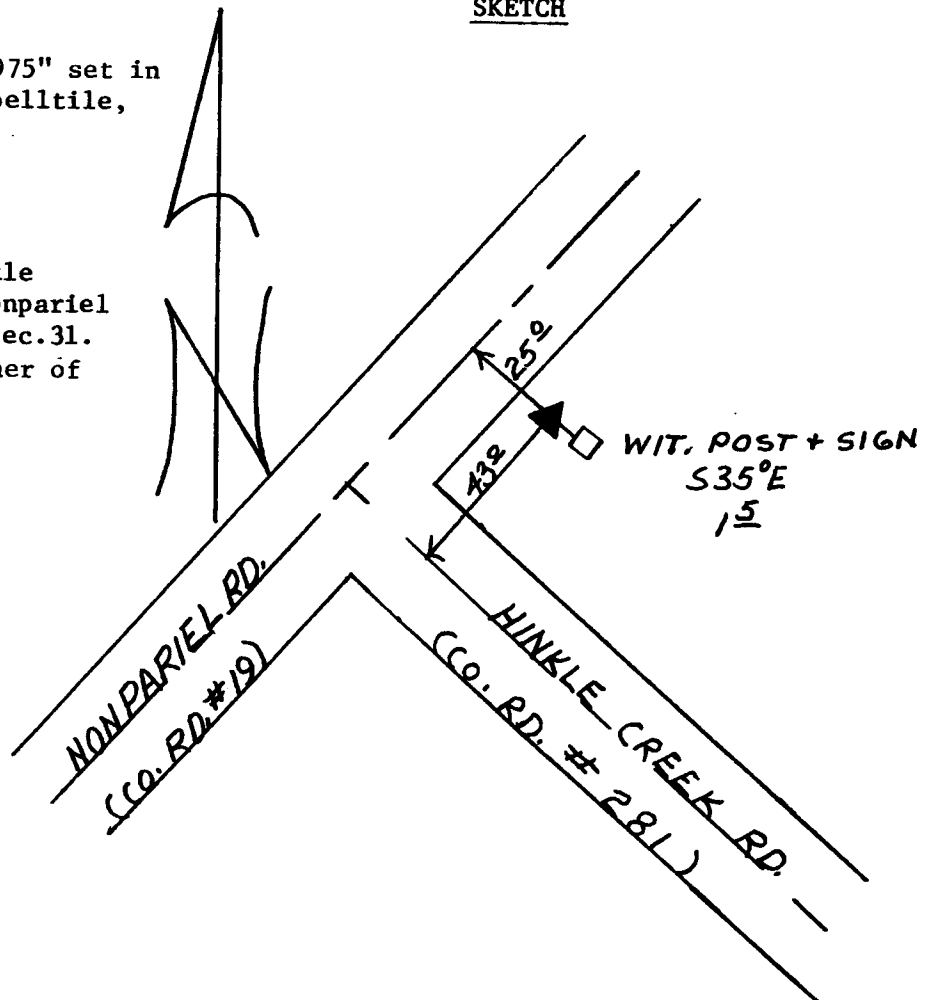

Reference Marks:

Note: For further information, contact the Douglas County Surveyor's Office, Room 205 Douglas County Justice Building, Roseburg, OR 97470. Phone 440-4278. Douglas County residents outside the Roseburg calling area, dial toll free 1-800-452-0991.