

OFFICE OF THE
DOUGLAS COUNTY SURVEYOR



H-018 28S 6W 4
Happy Valley Baseline B

NAD 558735.99 4146261.00
83 43°9'46" 123° 24' 20"

Station: "B" HAPPY VALLEY BASELINE T28 S, R 6W , Sec 4

Set By (Agency): DCSO

Date Set: 1972

Recovered By RWS

Date Recovered 5/1/85

Recovered By

Date Recovered

Recovered By

Date Recovered

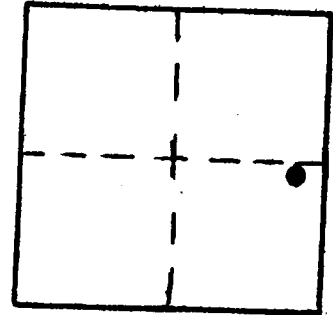

VERTICAL CONTROL NGVD 29 CORPSCON 6 NAVD88 489.02 FT.

Elevation: 485.588 ft. NGS Line # USGS Line # OSHD Line #

Precision: 2nd Agency: DCSO Proj. # 2013 Date: 1985

HORIZONTAL CONTROL OCS 27 CS 66/61

South Zone State Plane Coordinates: Y(Northing) 558,771.12 X(Easting) 1,225,302.60

Precision: 1:25,000 Agency: DCSO Proj. # 2015 Date: 1990

Approximate Geographic Position: Latitude 43° 09' 47" Longitude 123° 24' 16"

DESCRIPTION and TO REACH

SKETCH

DESCRIPTION:

A DCSO disk stamped "HAPPY VALLEY BASELINE B 1972" set in a 6" dia. concrete filled belltile approx. 1 ft. below surface of graveled shoulder.

TO REACH:

From the intersection of Carnes Rd. (Co. Rd. #16) and Happy Valley Rd. (Co. Rd. #26) in T28S, R6W, S.2c.2; proceed westerly along Happy Valley Rd. approx. 1.28 miles to monument on left.

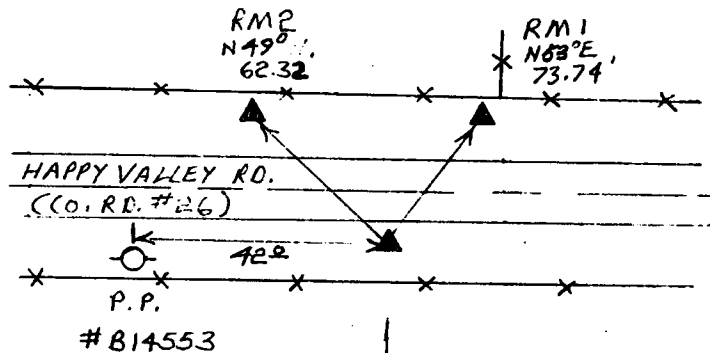

Reference Marks:

A DCSO disk stamped "HAPPY VALLEY BASELINE STA B RM1" bears N53°E, 73.74' (geod.), elev. 481.851 ft.

A DCSO disk stamped "HAPPY VALLEY BASELINE STA B RM2" bears N49°W, 62.32' (geod.), elev. 482.975 ft.

Note: For further information, contact the Douglas County Surveyor's Office, Room 205 Douglas County Justice Building, Roseburg, OR 97470. Phone 440-4278. Douglas County residents outside the Roseburg calling area, dial toll free 1-800-452-0991.