

OFFICE OF THE
DOUGLAS COUNTY SURVEYOR

Station: GOLF 2
 Date Set: 1993
 Set By (Agency): RUPPERT, LS #866
 DCSO Designation: G-080
 Date Recovered: 3-9-94
 Recovered By: SJF
 Date Recovered: _____
 Recovered By: _____
 Date Recovered: _____
 Recovered By: _____

T29S R5W Sec. 34

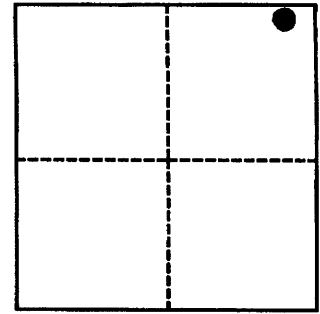
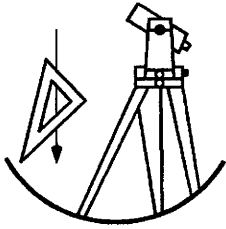

VERTICAL CONTROL

NGVD 29 Elevation: 633.87 FEET NAVD 88 Elevation: 637.29 FEET
 NGS Line # _____ USGS LINE # _____ OSHD Line # _____ FILE # _____
 Precision: 3RD ORDER Agency: CTY MYRTLE CRK Proj: C.S. 63/136-5 Date: 1993

HORIZONTAL CONTROL

O.C.S. 27 Y(Northing): _____ O.C.S. 83 Y(Northing): _____
 (South Zone) X(Easting): _____ (South Zone) X(Easting): _____
 Precision: _____ Agency: _____ Proj: _____ Date: _____
 Approx. O.C.S. 27 Geographic Position: Latitude: _____ Longitude: _____
 Approx. O.C.S. 83 Geographic Position: Latitude: _____ Longitude: _____

Found: A 2 inch diameter brass cap marked "GOLF 2 LS 866 1993" on a 3/4 inch I.D. iron pipe, protruding approx. 1 inch above ground level and set in concrete.

To reach: From the intersection of Neal Lane (Co. Rd. #124) and Days Creek Cut-Off Rd. (Co. Rd. #42) in T29S R5W Sec27 proceed southeasterly along Co. Rd. #42 approx. 0.5 miles to monument on right.

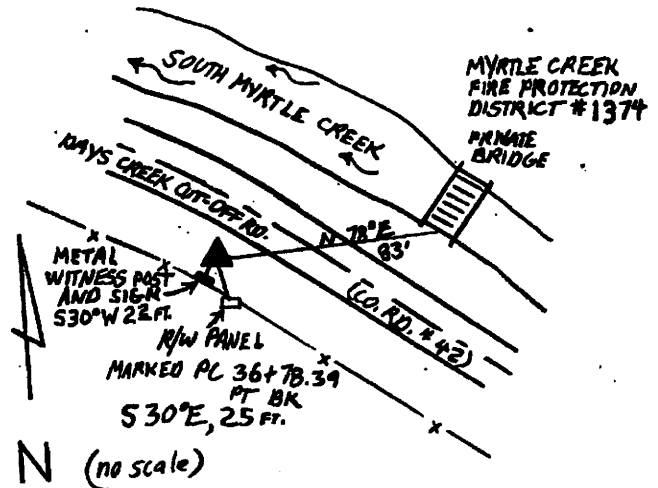

Note: For further information contact the Douglas County Surveyors Office, Room 205 Douglas County Justice Building, Roseburg, OR 97470. Phone 440-4272. Douglas County Residents outside Roseburg calling area, dial toll free 1-800-477-0991.