

OFFICE OF THE
DOUGLAS COUNTY SURVEYOR

Station: Gunderson T 27 S, R 2W, Sec 8

Set By (Agency): DCSO

Date Set: 1974

Recovered By KR-TP

Date Recovered 6-3-82

Recovered By RWS-SJF 1999

Date Recovered _____

Recovered By _____

Date Recovered _____

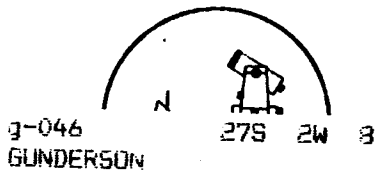
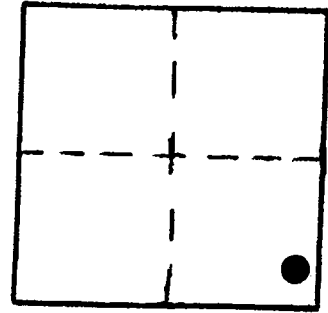

NAD 580090.43 4267363.18
83 43°13'56" 122°57'15"

VERTICAL CONTROL NGVD 29 CORPSCON 6 NAVD 88, 1046.26 FEET
Elevation: 1042.59 NGS Line # _____ USGS Line # _____ OSHD Line # _____
Precision: 3rd Agency: DCSO Proj. # CS66/5b Date: 1999

HORIZONTAL CONTROL NAD 27
South Zone State Plane Coordinates: Y(Northing) 580,126.80 X(Easting) 1,346,403.44
Precision: 1/25,000 Agency: DCSO Proj. # 2004-1 CS56/2 Date: 1974
Approximate Geographic Position: Latitude 43°13'56" Longitude 122°57'11"

DESCRIPTION and TO REACH

SKETCH

Found: A standard DCSO disc set in a concrete filled bell tile stamped "Gunderson 1974" protruding 0.5 ft. above the ground.

To reach: From the intersection of New Bridge Rd. (Co. Rd. #82A) and Little River Rd. (Co. Rd. #17) in T27S R3W sec. 12 proceed Easterly along Little River Rd. 3.2 mi. to monument on the right.

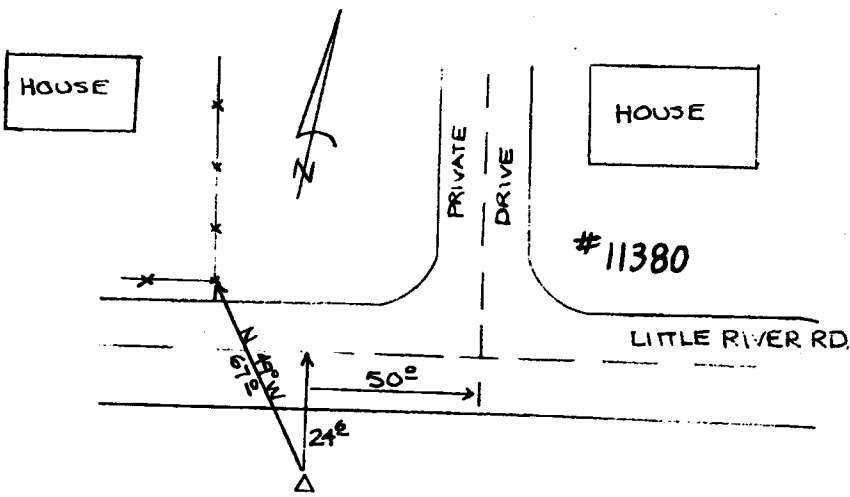

Reference Marks:

Note: For further information, contact the Douglas County Surveyor's Office, Room 205 Douglas County Justice Building, Roseburg, OR 97470. Phone 440-4278. Douglas County residents outside the Roseburg calling area, dial toll free 1-800-452-0991.