

OFFICE OF THE  
DOUGLAS COUNTY SURVEYOR

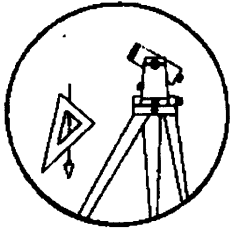

Station: G-476 T 26 S, R 3 W, Sec 18  
 Set By (Agency): USC&GS  
 Date Set: 1941  
 Recovered By LEM  
 Date Recovered 5/80  
 Recovered By \_\_\_\_\_  
 Date Recovered \_\_\_\_\_  
 Recovered By \_\_\_\_\_  
 Date Recovered \_\_\_\_\_

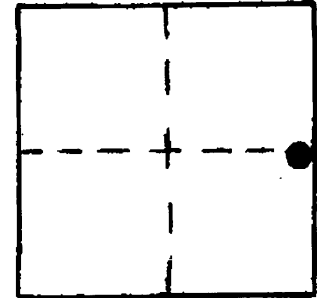

G 003

VERTICAL CONTROL NGVD 29 CORPSCOM 6 NAVD 88 714.913 FT  
 Elevation: 711.340 NGS Line # 94 USGS Line # \_\_\_\_\_ OSHD Line # \_\_\_\_\_  
 Precision: 1st Agency: USC&GS Proj. # \_\_\_\_\_ Date: 1961

HORIZONTAL CONTROL  
 South Zone State Plane Coordinates: Y(Northing) \_\_\_\_\_ X(Easting) \_\_\_\_\_  
 Precision: \_\_\_\_\_ Agency: \_\_\_\_\_ Proj. # \_\_\_\_\_ Date: \_\_\_\_\_  
 Approximate Geographic Position: Latitude \_\_\_\_\_ Longitude \_\_\_\_\_

DESCRIPTION and TO REACH

Station is a standard USC&GS disk stamped "G 476 1941" located in the northeast corner of a 2'x2' concrete footing for a water tank (tank now gone). A witness post and sign bears S60°W 1 ft..

To Reach: From the intersection of Hwy 138 and Glide Loop Rd. (at the USFS Glide Ranger Station and Colliding Rivers Park), proceed northeasterly along Glide Loop Rd. approx. 1.1 mi. to the monument location on the right.

SKETCH

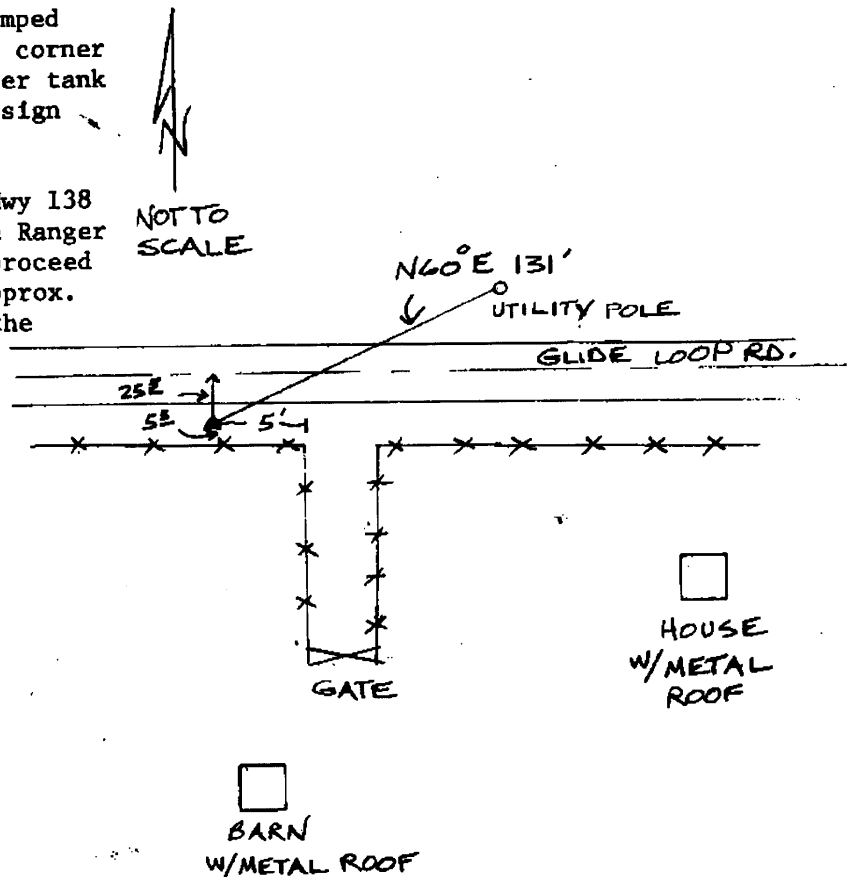

Reference Marks:



Note: For further information, contact the Douglas County Surveyor's Office, Room 205 Douglas County Justice Building, Roseburg, OR 97470. Phone 440-4278. Douglas County residents outside the Roseburg calling area, dial toll free 1-800-452-0991.

OFFICE OF THE  
DOUGLAS COUNTY SURVEYOR

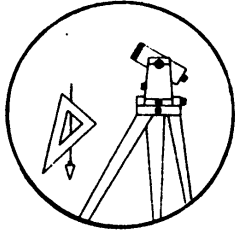

G-004

Station: G 500 T 30 S, R 3W , Sec 34  
 Set By (Agency): USC&GS  
 Date Set: 1949  
 Recovered By JP-RS  
 Date Recovered 3-17-82  
 Recovered By 5-29-98  
 Date Recovered \_\_\_\_\_  
 Recovered By \_\_\_\_\_  
 Date Recovered \_\_\_\_\_

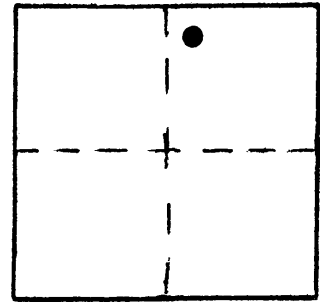

VERTICAL CONTROL NGVD 29

Elevation: 912.291 NGS Line # 130 USGS Line # \_\_\_\_\_ OSHD Line # \_\_\_\_\_  
 Precision: 2nd Agency: USC&GS Proj. # \_\_\_\_\_ Date: 1957

HORIZONTAL CONTROL

South Zone State Plane Coordinates: Y(Northing) \_\_\_\_\_ X(Easting) \_\_\_\_\_  
 Precision: \_\_\_\_\_ Agency: \_\_\_\_\_ Proj. # \_\_\_\_\_ Date: \_\_\_\_\_  
 Approximate Geographic Position: Latitude 42° 55' 50" Longitude 123° 02' 55"

DESCRIPTION and TO REACH

SKETCH

Found: A standard USC&GS disk set in 12" concrete post marked "G 500 1949". Witness sign and post are directly along Westerly side. Station is .3ft above ground and about level with the road surface.

To reach: From the junction of St. Hwy. #227 and BLM Rd. 30-3-26.0 (Corn Creek) in T30S R3W sec. 26 proceed Westerly along St. Hwy. #227 1.45 miles to station on the left or the southerly side of road.

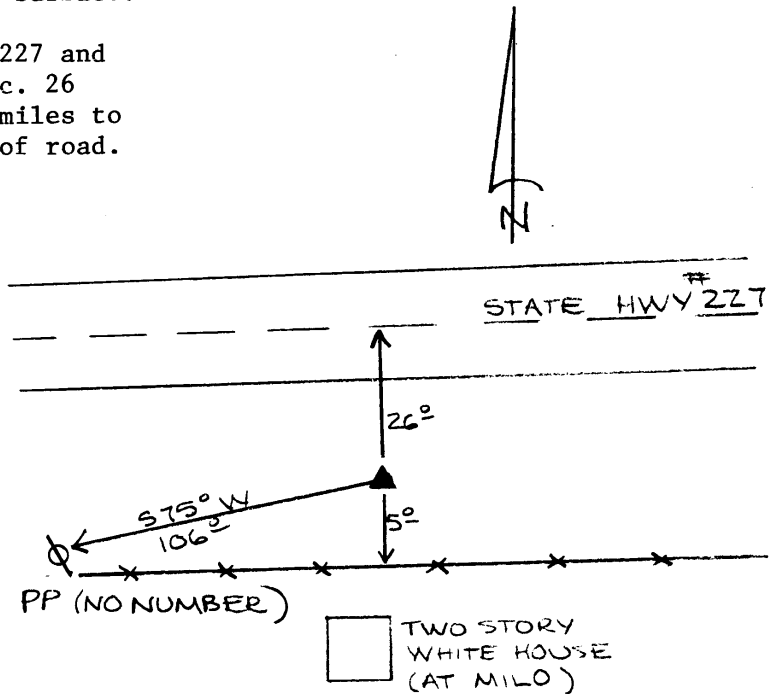

Reference Marks:

Note: For further information, contact the Douglas County Surveyor's Office, Room 205 Douglas County Justice Building, Roseburg, OR 97470. Phone 440-4278. Douglas County residents outside the Roseburg calling area, dial toll free 1-800-452-0991.

OFFICE OF THE  
DOUGLAS COUNTY SURVEYOR

Station: G 554 T 28 S, R 6 W, Sec 22  
Set By (Agency): U.S.C. & G.S.  
Date Set: 1954  
Recovered By RS, SJF  
Date Recovered June 19, 1984  
Recovered By \_\_\_\_\_  
Date Recovered \_\_\_\_\_  
Recovered By \_\_\_\_\_  
Date Recovered \_\_\_\_\_

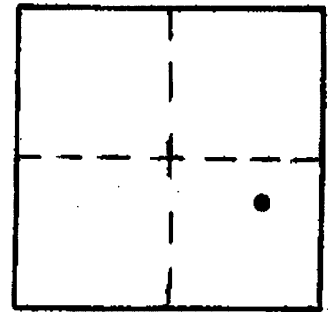
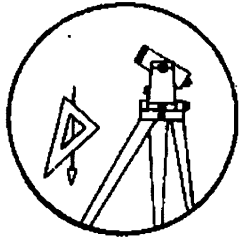

G-005

VERTICAL CONTROL NGVD 29 CORPSCON 6 NAVD 88 524.358 FT

Elevation: 520.918 Ft. NGS Line # 6 USGS Line # \_\_\_\_\_ OSHD Line # \_\_\_\_\_  
Precision: 1st. Agency: USC&GS Proj. # \_\_\_\_\_ Date: 1957

HORIZONTAL CONTROL

South Zone State Plane Coordinates: Y(Northing) \_\_\_\_\_ X(Easting) \_\_\_\_\_  
Precision: \_\_\_\_\_ Agency: \_\_\_\_\_ Proj. # \_\_\_\_\_ Date: \_\_\_\_\_  
Approximate Geographic Position: Latitude \_\_\_\_\_ Longitude \_\_\_\_\_

DESCRIPTION and TO REACH

A U.S.C. & G.S. disk stamped "G 554 1954"  
set flush in a concrete culvert headwall.

TO REACH:

From the intersection of Roberts Creek Road (Co. Rd. #16) and Roberts Mountain Road (Co. Rd. #123) in T28S, R6W, Sec. 14, proceed southerly along Roberts Mountain Road approximately 0.85 miles to Southern Pacific Rail Road crossing C565.5. From crossing C565.5 proceed, on foot, south-westerly along S. P. railline approximately 0.8 miles to monument on right. Monument lies in northeast end of a concrete culvert head-wall approximately 10 feet lower than tracks.

SKETCH  
(no scale)

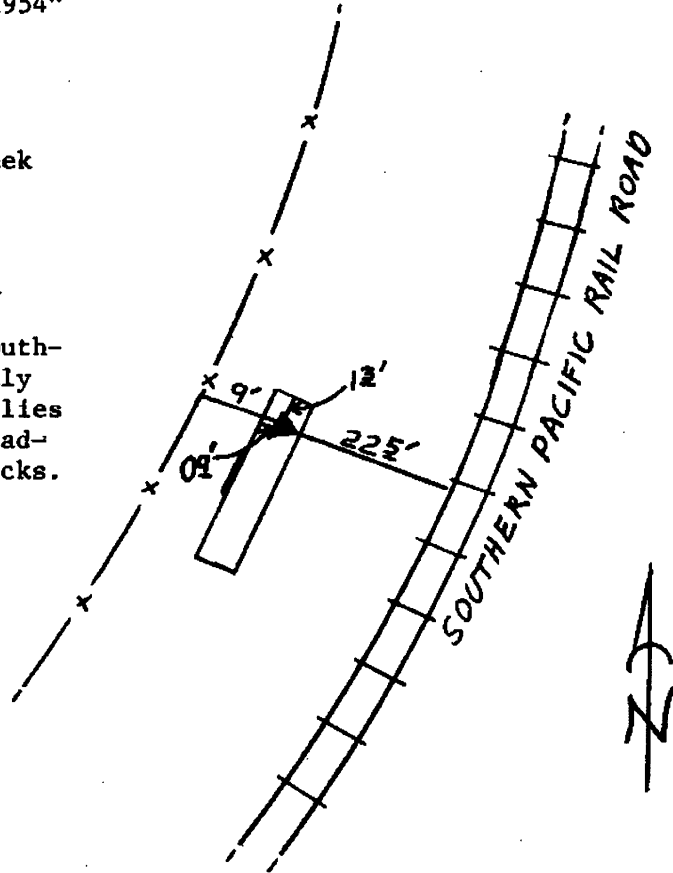

Reference Marks:

Note: For further information, contact the Douglas County Surveyor's Office, Room 205 Douglas County Justice Building, Roseburg, OR 97470. Phone 440-4278. Douglas County residents outside the Roseburg calling area, dial toll free 1-800-452-0991.

OFFICE OF THE

g-006  
G-666

24S 5W 29

DOUGLAS COUNTY SURVEYOR

NAD 666553.73 4172206.59  
83 43°27'40" 123°19'19"

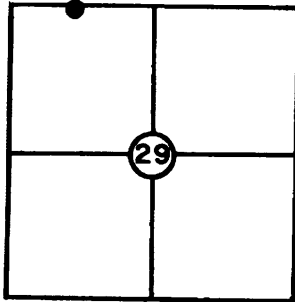

T 24 S, R 5W, Sec. 29

Station: G-666

Set By (Agency): OSHD

Date: 1975 (FD OK 1991)

NGVD 29 486.80  
Elevation: ~~486.796~~

VERTICAL CONTROL CORPSON 6 NAVD 88 490.33 F1

OSHD  
NGS(USC&GS) Line # \_\_\_\_\_ USGS Line # 369

Order  
Of Precision 3rd Agency: OSHD Proj. #: \_\_\_\_\_ Date: 1956

HORIZONTAL CONTROL

OCS 27  
Oregon State Plane Coordinates: Y(Northing) 666,588.12 X(Easting) 1,251,247.06  
(South Zone)

Order  
Of Precision 1/25,000 Agency: DCSO Proj. #: 2010-4 Date: 1978

Approximate Geographic Position: Latitude= 43°27'40" Longitude= 123°19'15"

DESCRIPTION: A standard OSHD brass cap  
stamped "B-666 1975" set on top of the curb  
at the NW'stly corner of the Metz Hill  
overpass across I-5.

SKETCH

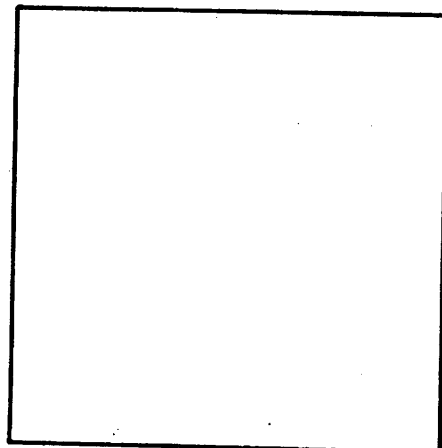

VICINITY: At Metz Hill interchange along  
I-5.

NOTE: For Possible Further Information On This Station, Please Contact The Douglas County Surveyors Office, Rm. 205 Douglas County Justice Bldg., Roseburg, OR. 97470 Phone 672-3311 Ext. 272.. Douglas County residents outside the Roseburg calling area dial toll free 1-800-452-0991.

OFFICE OF THE  
DOUGLAS COUNTY SURVEYOR

Station: GAGING STATION R.M. T 27 S, R 6 E, Sec 30

Set By (Agency): U.S.G.S.

Date Set: UNKNOWN

Recovered By FLI (DCSO)

Date Recovered 7-19-84

Recovered By \_\_\_\_\_

Date Recovered \_\_\_\_\_

Recovered By \_\_\_\_\_

Date Recovered \_\_\_\_\_

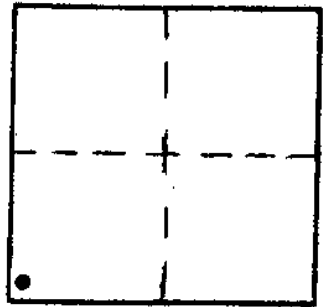

g-008 27S 6E 30  
GAGING STATION RM

NAD 557826.24 4476865.81  
83 43°11' 7" 122° 9' 59"

VERTICAL CONTROL

Elevation: \_\_\_\_\_ NGS Line # \_\_\_\_\_ USGS Line # \_\_\_\_\_ OSHD Line # \_\_\_\_\_

Precision: \_\_\_\_\_ Agency: \_\_\_\_\_ Proj. # \_\_\_\_\_ Date: \_\_\_\_\_

HORIZONTAL CONTROL OCS 27

South Zone State Plane Coordinates: Y(Northing) 557,864.19 X(Easting) 1,555,904.36

Precision: 1/25,000 Agency: DCSO/USFS Proj. # 2008-1 CS62/23 Date: 1984

Approximate Geographic Position: Latitude 43°11'07" Longitude 122°09'55"

DESCRIPTION and TO REACH

At outlet of Diamond Lake, N.W. corner of lake.

Brass cap in top of the remains of concrete riprap wall, 1.0 ft. above water.

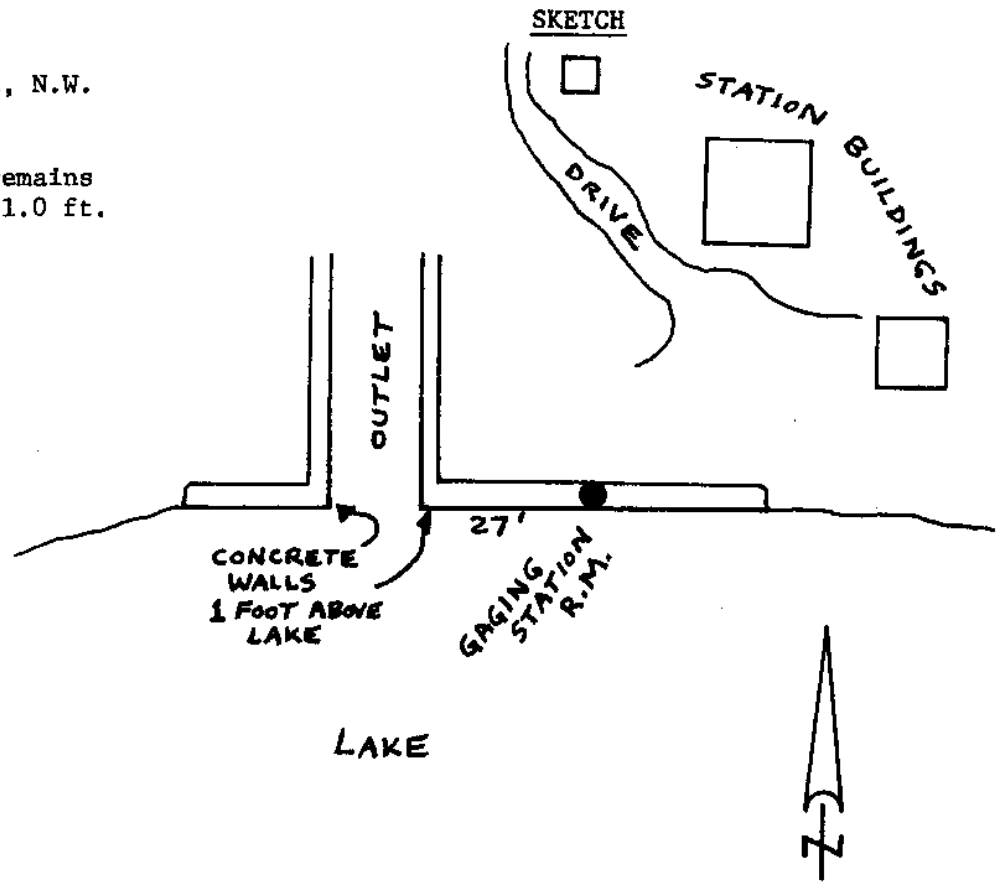

Reference Marks:

Note: For further information, contact the Douglas County Surveyor's Office, Room 205 Douglas County Justice Building, Roseburg, OR 97470. Phone 440-4278. Douglas County residents outside the Roseburg calling area, dial toll free 1-800-452-0991.

OFFICE OF THE  
DOUGLAS COUNTY SURVEYOR

9-15  
GARY

22 S 6 W 15

430  
20

740629.73  
43127.15'

4156767-27  
1235808.86

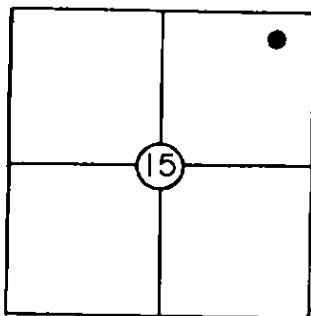

T 22 S, R 6W, Sec. 15

Station: Gary

Set By (Agency): DCSO

Date: 1978

VERTICAL CONTROL

Elevation: \_\_\_\_\_ NGS(USC&GS) Line # \_\_\_\_\_ USGS Line # \_\_\_\_\_

Order  
Of Precision \_\_\_\_\_ Agency: \_\_\_\_\_ Proj. #: \_\_\_\_\_ Date: \_\_\_\_\_

HORIZONTAL CONTROL

Oregon State Plane Coordinates: Y(Northing) 740629.73 X(Easting) 1,235,808.86  
(South Zone)

Order  
Of Precision 1/50,000 Agency: DCSO Proj. #: 2008 Date: 1979

Approximate Geographic Position: Latitude= \_\_\_\_\_ Longitude= \_\_\_\_\_

DESCRIPTION: B.C. in belltile stamped "Gary 1978"

Cap is 54' N. of Hwy. 38 centerline at inter-

section of Co. Rd. #66 and Hwy. 38, and 2.5'

S. of witness post in fenceline.

SKETCH

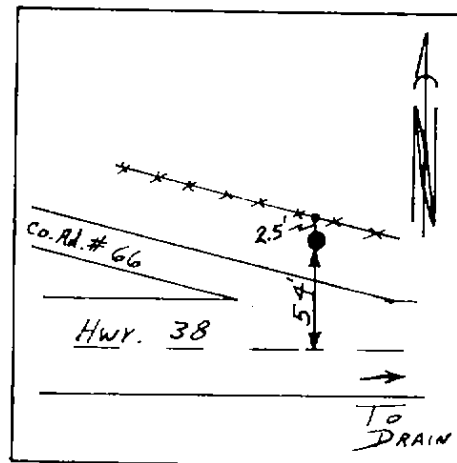

VICINITY: Approx. 3.8 mi. W'stly along Hwy.

38 from the intersection of Hwys 38 & 99 in Drain.

NOTE: For Possible Further Information On This Station, Please Contact The Douglas County Surveyors Office, Rm. 205 Douglas County Justice Bldg., Roseburg, OR. 97470 Phone 672-3311 Ext. 272. Douglas County residents outside the Roseburg calling area dial toll free 1-800-452-0991.

OFFICE OF THE  
DOUGLAS COUNTY SURVEYOR

g-017 26S 6W 25  
GAS 1972  
NAD 603200.68 4160883.09  
83 43°17'10" 123°21'23"

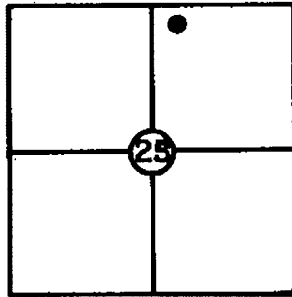

T 26 S, R 6W, Sec. 25  
Station: Gas  
Set By (Agency): DCSO  
Date: 1972

NGVD 29

VERTICAL CONTROL CORPSCON 6 NAVD 88 531.958 FT

Elevation: 528.471 NGS(USC&GS) Line # \_\_\_\_\_ USGS Line # \_\_\_\_\_

Order  
Of Precision 2nd Agency: DCSO Proj. #: 2006 Date: 1974

HORIZONTAL CONTROL

OCS 27

Oregon State Plane Coordinates: Y(Northing) 603,235.65 X(Easting) 1,239,924.12  
(South Zone)

Order  
Of Precision 1/25,000 Agency: DCSO Proj. #: 2006 Date: 1974

Approximate Geographic Position: Latitude= \_\_\_\_\_ Longitude= \_\_\_\_\_

DESCRIPTION: From W. end of Bridge of Rd.  
#115, go 60 ft. S. Bridge is over I-5 &  
near Douglas County Lumber Co., Point  
sees the freeway.

VICINITY: Winchester N. side of River.

SKETCH

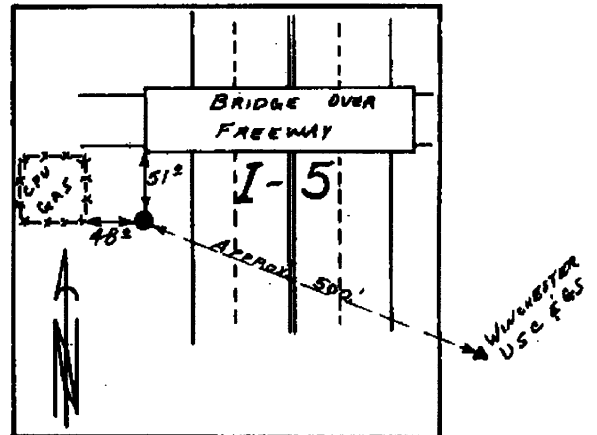

NOTE: For Possible Further Information On This Station, Please Contact The Douglas County Surveyors Office, Rm. 205 Douglas County Justice Bldg., Roseburg, OR. 97470 Phone 672-3311 Ext. 272. Douglas County residents outside the Roseburg calling area dial toll free 1-800-452-0991.

OFFICE OF THE  
DOUGLAS COUNTY SURVEYOR

Station: Gates  
 Set By (Agency): DCSO  
 Date Set: 1982  
 Recovered By LEM- JP-RS  
 Date Recovered 2-23-82  
 Recovered By \_\_\_\_\_  
 Date Recovered \_\_\_\_\_  
 Recovered By \_\_\_\_\_  
 Date Recovered \_\_\_\_\_

T 22 S, R 7W , Sec 20



g-018  
GATES  
 225 7W 20  
 NAD 733000.37 4112489.01  
 83 43°38'15" 123°33'21"

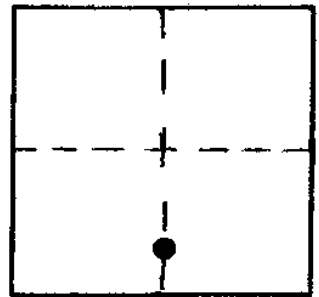

VERTICAL CONTROL

Elevation: \_\_\_\_\_ NGS Line # \_\_\_\_\_ USGS Line # \_\_\_\_\_ OSHD Line # \_\_\_\_\_  
 Precision: \_\_\_\_\_ Agency: \_\_\_\_\_ Proj. # \_\_\_\_\_ Date: \_\_\_\_\_

HORIZONTAL CONTROL

South Zone State Plane Coordinates: Y(Northing) 733,035.31 X(Easting) 1,191,528.78  
 Precision: 1/10,000 Agency: DCSO Proj. # 2006 Date: 1982  
 Approximate Geographic Position: Latitude 43°38'15" Longitude 123°33'17"

DESCRIPTION and TO REACH

Set: A standard DCSO disk stamped "Gates 1982" set in a 6" x 42" concrete belltile filled with concrete set flush with the ground.

To reach: From the intersection of State Hwy. #38 and State Hwy #138 in T22S R7W sec. 29, proceed Easterly along State Hwy. 38 .45 miles to monument on the right.

SKETCH

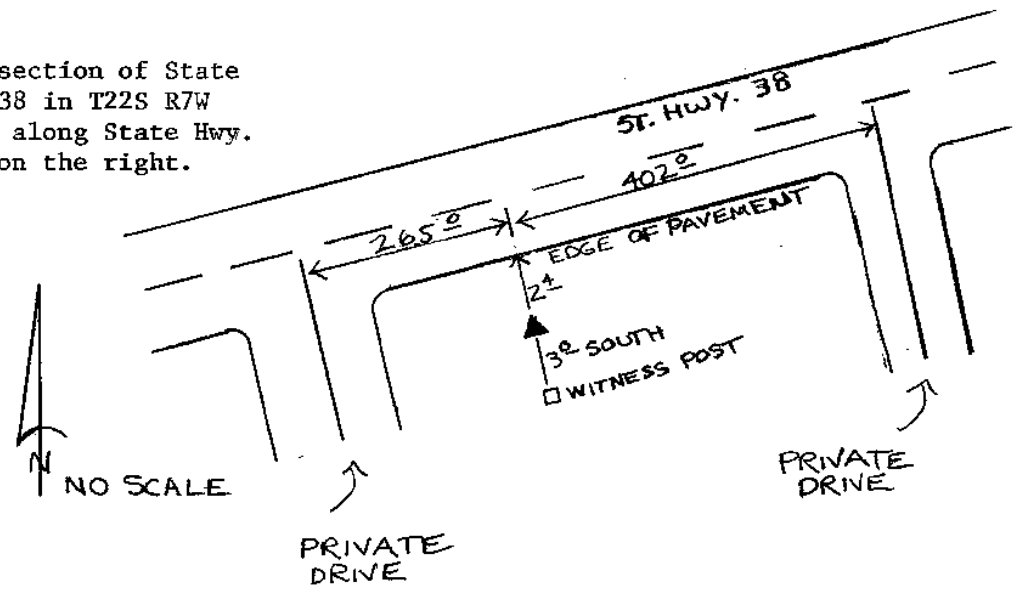

Reference Marks:

Note: For further information, contact the Douglas County Surveyor's Office, Room 205 Douglas County Justice Building, Roseburg, OR 97470. Phone 440-4278. Douglas County residents outside the Roseburg calling area, dial toll free 1-800-452-0991.

OFFICE OF THE  
DOUGLAS COUNTY SURVEYOR

Station: GAZE T 30 S, R 5 W, Sec 22  
 Set By (Agency): DCSO  
 Date Set: 1975  
 Recovered By JMP-RS  
 Date Recovered 2/82  
 Recovered By RWS/SJF  
 Date Recovered 1/2002  
 Recovered By \_\_\_\_\_  
 Date Recovered \_\_\_\_\_

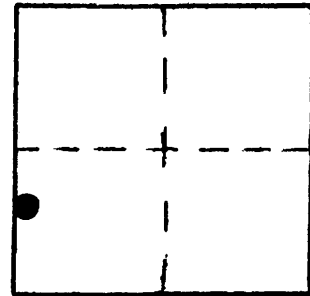

g-019  
GAZE

30S 5W 22

NAD 478421.14 4175640.15  
 83 42°56'43" 123°17' 8"

VERTICAL CONTROL NGVD 29 CORPSCON 6 NAVD 88 697.24 FT  
 Elevation: 693.88 FT. NGS Line # \_\_\_\_\_ USGS Line # \_\_\_\_\_ OSHD Line # \_\_\_\_\_  
 Precision: 3rd Agency: DCSO ~~Proj.~~ <sup>CS</sup> # 66/041 Date: 2002

HORIZONTAL CONTROL OCS 27  
 South Zone State Plane Coordinates: Y(Northing) 478,456.96 X(Easting) 1,254,681.52  
 Precision: 1/25,000 Agency: DCSO Proj. # 2004-10 CS 57/27 Date: 1975  
 Approximate Geographic Position: Latitude 42°56'44" Longitude 123°17'03"

DESCRIPTION and TO REACH

Station is a standard DCSO disk stamped "GAZE 1975" set flush on the NE corner of a concrete curb of a bridge over the South Umpqua.

To Reach: From the intersection of a frontage road northerly of I-5 and Co. Rd. 35 (Gazely Rd.) in the NE corner of S.28 T30S, R5W, proceed Northerly on Co. Rd. 35 0.4 mi. to intersection of Co. Rd. 35 and Co. Rd. 35A.

SKETCH

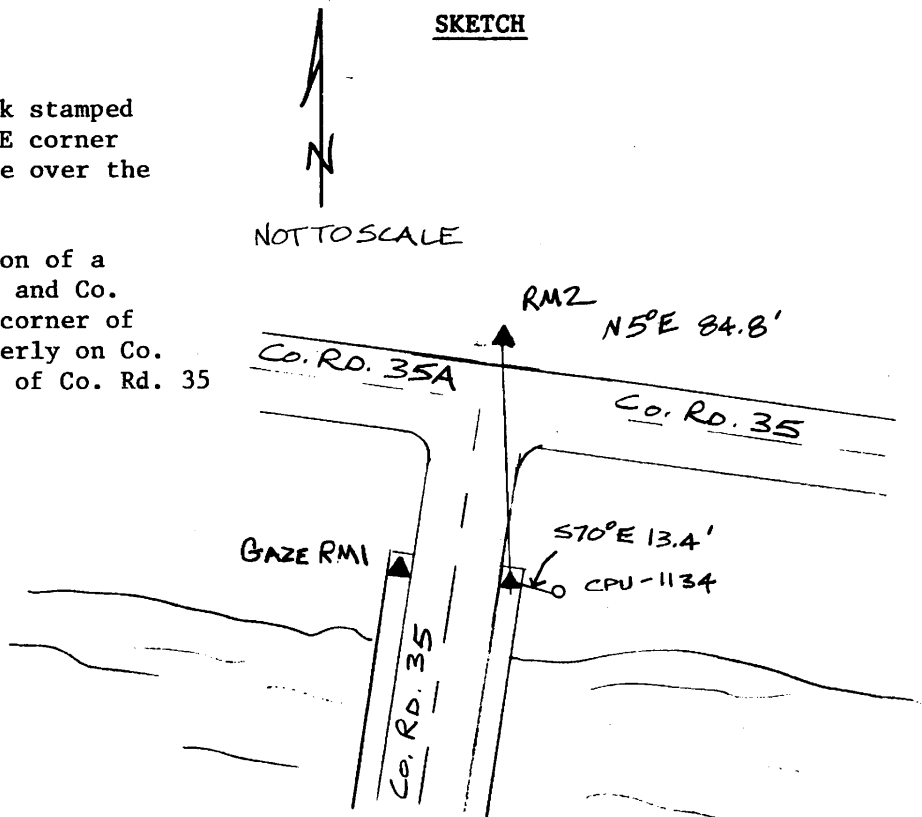

Reference Marks:

"GAZE 1975 RM NO 1" is a standard DCSO disk NW corner of bridge abutment and bears N76°45'16"W 25.49 ft. (grid) from the station. Elev. 692.97 FT.

"GAZE 1975 RM NO 2 1978" is a standard DCSO disk set in concrete filled belltile and bears N 9°36'57"E 85.25 ft. (grid) from the station. Elev. 688.37 FT.

Note: For further information, contact the Douglas County Surveyor's Office, Room 205 Douglas County Justice Building, Roseburg, OR 97470. Phone 440-4278. Douglas County residents outside the Roseburg calling area, dial toll free 1-800-452-0991.

OFFICE OF THE  
DOUGLAS COUNTY SURVEYOR

Station: GAZE AZIMUTH T 30 S, R 5 W, Sec 21

Set By (Agency): D.C.S.O.

Date Set: 1978

Recovered By RS, SJF

Date Recovered June 6, 1984

Recovered By \_\_\_\_\_

Date Recovered \_\_\_\_\_

Recovered By \_\_\_\_\_

Date Recovered \_\_\_\_\_

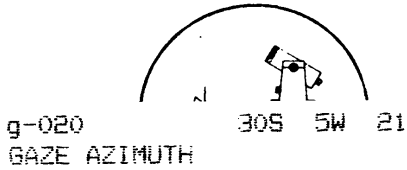
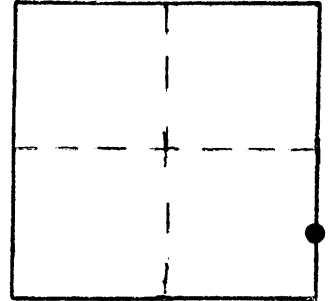

NAD 477609.55 4175494.61  
83 42°56'35" 123°17' 9"

VERTICAL CONTROL

Elevation: \_\_\_\_\_ NGS Line # \_\_\_\_\_ USGS Line # \_\_\_\_\_ OSHD Line # \_\_\_\_\_

Precision: \_\_\_\_\_ Agency: \_\_\_\_\_ Proj. # \_\_\_\_\_ Date: \_\_\_\_\_

HORIZONTAL CONTROL *OCS 27*

South Zone State Plane Coordinates: Y(Northing) 477,645.37 X(Easting) 1,254,535.98

Precision: 1/25,000 Agency: D.C.S.O. Proj. # 2008 Date: 1978

Approximate Geographic Position: Latitude 42°56'36" Longitude 123°17'05"

DESCRIPTION and TO REACH

SKETCH

A chisled "X" in the southeast corner of a bridge curbing.

TO REACH:

From the intersection of State Highway 99 and Co. Rd. # 35 (Gazley Rd.) in T30S,R5W, Sec.28 proceed northerly along Co. Rd. # 35 approximately 0.25 miles to bridge over the South Umpqua River and monument on right.

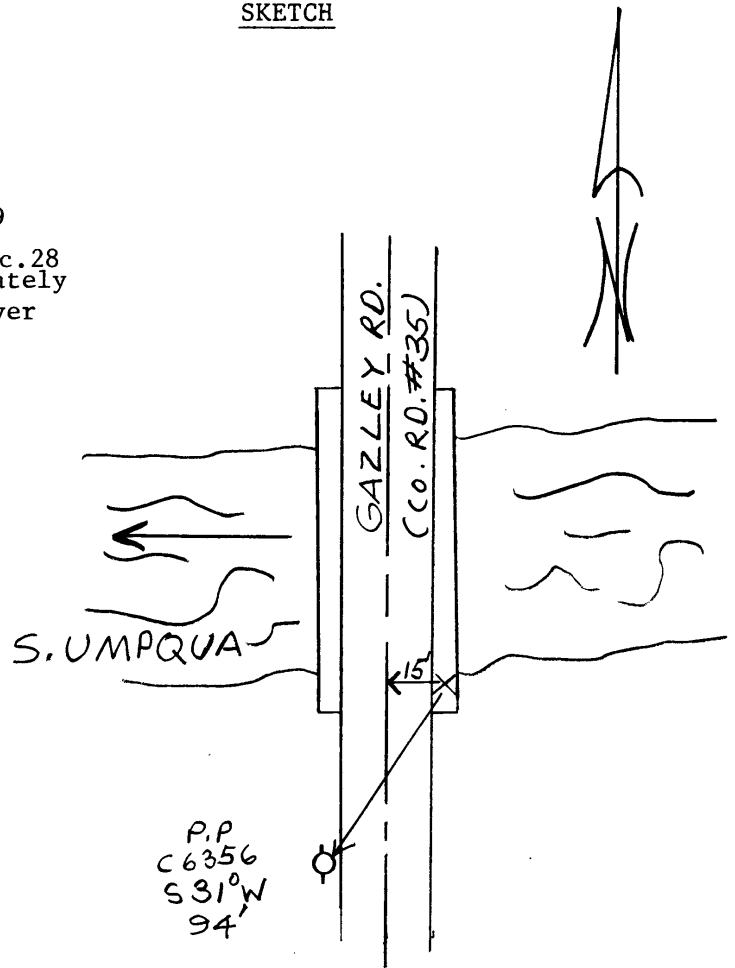

Reference Marks:

Note: For further information, contact the Douglas County Surveyor's Office, Room 205 Douglas County Justice Building, Roseburg, OR 97470. Phone 440-4278. Douglas County residents outside the Roseburg calling area, dial toll free 1-800-452-0991.

1/4/82

g-024  
GINGER

26S 6W 14

OFFICE OF THE

DOUGLAS COUNTY SURVEYOR

NAD 609424.35 4155977.54  
83 43°18'10" 123°22'32"

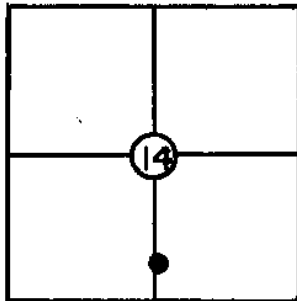

T 26 S, R 6 W, Sec. 14

Station: GINGER

Set By (Agency): DCSO

Date: 1981

VERTICAL CONTROL

Elevation: \_\_\_\_\_ NGS(USC&GS) Line # \_\_\_\_\_ USGS Line # \_\_\_\_\_

Order  
Of Precision \_\_\_\_\_ Agency: \_\_\_\_\_ Proj. #: \_\_\_\_\_ Date: \_\_\_\_\_

HORIZONTAL CONTROL

*OCS 27*  
Oregon State Plane Coordinates: Y(Northing) 609,459.37 X(Easting) 1,235,018.68  
(South Zone)

Order  
Of Precision 1/25,000 Agency: DCSO Proj. #: 2013 Date: 1981

Approximate Geographic Position: Latitude= 43° 18' 11" Longitude= 123° 22' 28"

DESCRIPTION: Monument is a brass cap set  
in NE cor. of bridge curb stamped "Ginger 1981".

To reach: From the intersection of Co. Rd.  
# 31 (Wilbur Rd. ) and Co. Rd. # 115  
proceed E'stly along Co. Rd. # 115 approx.  
320 ft. to first bridge over Sutherlin Creek.

SKETCH

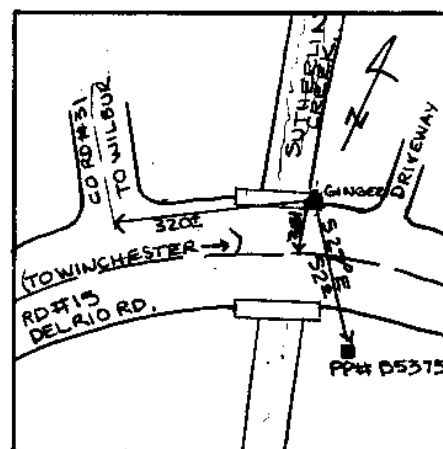

VICINITY: Near the intersection of  
Co. Rd. #31 and Co. Rd. #115.  
over Sutherlin Creek.

NOTE: For Possible Further Information On This Station, Please Contact The Douglas County Surveyors Office, Rm. 205 Douglas County Justice Bldg., Roseburg, OR. 97470 Phone 672-3311 Ext. 272.. Douglas County residents outside the Roseburg calling area dial toll free 1-800-452-0991.

OFFICE OF THE  
DOUGLAS COUNTY SURVEYOR

Station: GLASS T 28 S, R 7 W, Sec 14

Set By (Agency): DCSO

Date Set: 1972

Recovered By RS, SF

Date Recovered 3/2/84

Recovered By RS-SF / 1.1998

Date Recovered \_\_\_\_\_

Recovered By \_\_\_\_\_

Date Recovered \_\_\_\_\_

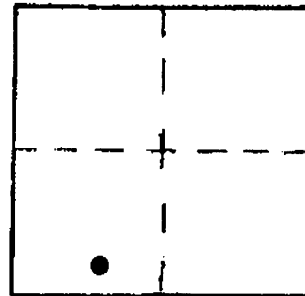

G-025  
GLASS

28S 7W 14

NAD 546986.03 4121223.75  
83 43° 7'42" 123°29'52"

VERTICAL CONTROL NGVD 29 CORPSCOM 6 NAVD 88 655.94 FT  
Elevation: 652.49 NGS Line # \_\_\_\_\_ USGS Line # \_\_\_\_\_ OSHD Line # \_\_\_\_\_  
Precision: 3rd Agency: DCSO Proj. # 2008 Date: 1998

HORIZONTAL CONTROL OCS 27 CS 66/49  
South Zone State Plane Coordinates: Y(Northing) 547,021.40 X(Easting) 1,200,265.48  
Precision: 1/25,000 Agency: DCSO Proj. # 2004 CS56/19 GPS 27/83 Date: 1973/1991  
Approximate Geographic Position: Latitude 43°07'42" Longitude 123°29'48"

DESCRIPTION and TO REACH

SKETCH

DESCRIPTION:

A DCSO disk stamped "GLASS 1972" set in a 8 in. dia. concrete filled balltile protruding 6 in. above ground.

TO REACH:

From the intersection of St. Hwy. 42 and Strickland Canyon Rd. [Co. Rd. #108 (Porter Creek Rd.)] in T28S,R7W,Sec.27, proceed northerly along Strickland Canyon Rd. 2.0 miles to monument on right.

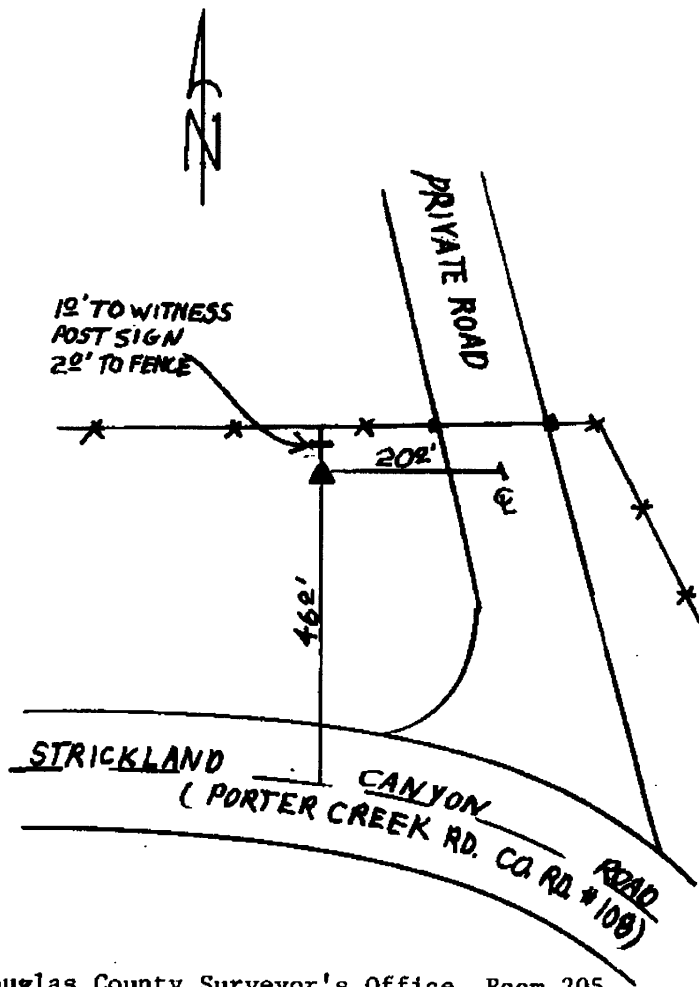

Reference Marks:

Note: For further information, contact the Douglas County Surveyor's Office, Room 205 Douglas County Justice Building, Roseburg, OR 97470. Phone 440-4278. Douglas County residents outside the Roseburg calling area, dial toll free 1-800-452-0991.

OFFICE OF THE  
DOUGLAS COUNTY SURVEYOR

Station: GLEE  
 Set By (Agency): DCSO  
 Date Set: 1982  
 Recovered By GQ  
 Date Recovered 1982  
 Recovered By \_\_\_\_\_  
 Date Recovered \_\_\_\_\_  
 Recovered By \_\_\_\_\_  
 Date Recovered \_\_\_\_\_

T 27 S, R 6 W, Sec 14



g-026  
GLEE

27S 6W 14

NAD 582158.08 4153237.98  
 83 43°13'40" 123°22'57"

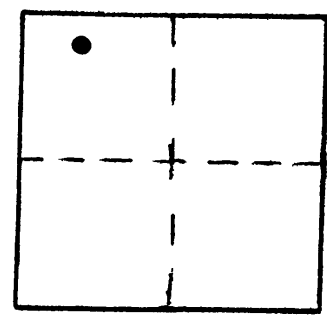

VERTICAL CONTROL

Elevation: \_\_\_\_\_ NGS Line # \_\_\_\_\_ USGS Line # \_\_\_\_\_ OSHD Line # \_\_\_\_\_  
 Precision: \_\_\_\_\_ Agency: \_\_\_\_\_ Proj. # \_\_\_\_\_ Date: \_\_\_\_\_

HORIZONTAL CONTROL **OCS 27**

South Zone State Plane Coordinates: Y(Northing) 582,193.19 X(Easting) 1,232,279.63  
 Precision: 1/20,000 Agency: DCSO Proj. # 2005-2 Date: 1983  
 Approximate Geographic Position: Latitude 43°13'41" Longitude 123°22'52"

DESCRIPTION and TO REACH

DESCRIPTION:

A DCSO disk stamped "GLEE 1982"  
set flush in concrete curb.

TO REACH:

Go to intersection of NW Jefferson St.  
and NW Calkins Ave.

SKETCH

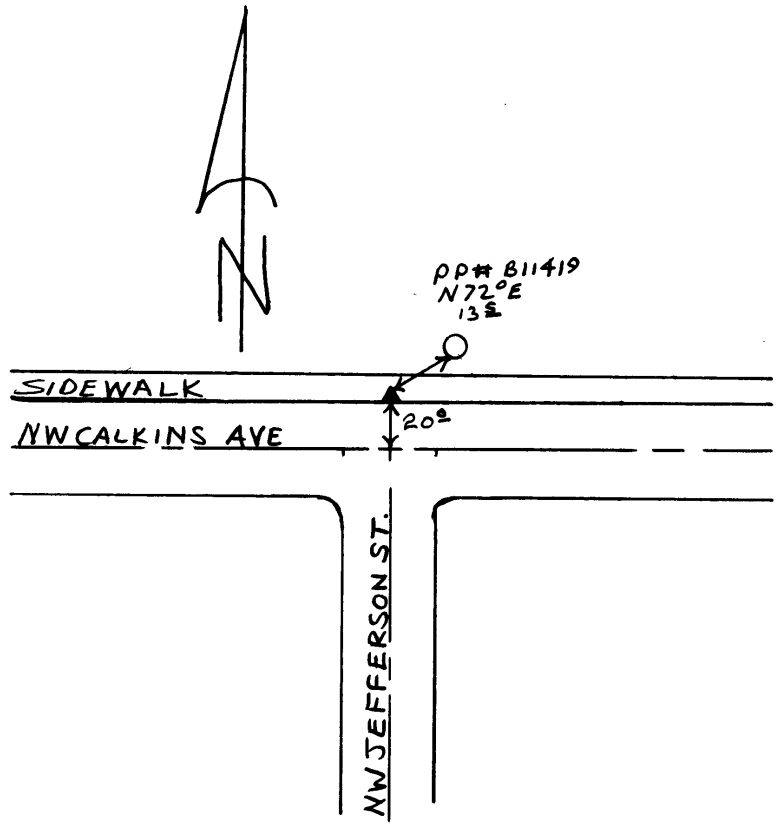

PP# 811419  
N72°0E  
13E

Reference Marks:

Note: For further information, contact the Douglas County Surveyor's Office, Room 205 Douglas County Justice Building, Roseburg, OR 97470. Phone 440-4278. Douglas County residents outside the Roseburg calling area, dial toll free 1-800-452-0991.

OFFICE OF THE  
DOUGLAS COUNTY SURVEYOR

Station: GLEN T 28 S, R 6 W , Sec 24

Set By (Agency): DCSO

Date Set: 1973

Recovered By RS, PB

Date Recovered 11/15/83

Recovered By \_\_\_\_\_

Date Recovered \_\_\_\_\_

Recovered By \_\_\_\_\_

Date Recovered \_\_\_\_\_

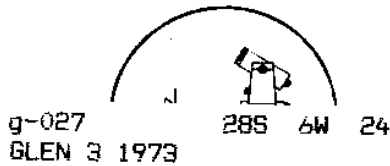
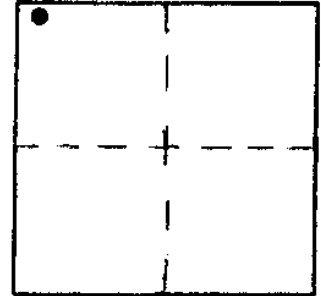

NAD 545198.14 4157162.13  
83 43° 7'36" 123°21'47"

VERTICAL CONTROL

Elevation: \_\_\_\_\_ NGS Line # \_\_\_\_\_ USGS Line # \_\_\_\_\_ OSHD Line # \_\_\_\_\_  
Precision: \_\_\_\_\_ Agency: \_\_\_\_\_ Proj. # \_\_\_\_\_ Date: \_\_\_\_\_

HORIZONTAL CONTROL **OCS 27**

South Zone State Plane Coordinates: Y(Northing) 545,233.38 X(Easting) 1,236,203.77  
Precision: 1/50,000 Agency: DCSO Proj. # 2004 CS 56/27 Date: 1973  
Approximate Geographic Position: Latitude 43°07'37" Longitude 123°21'42"

DESCRIPTION and TO REACH

SKETCH

DESCRIPTION:

A DCSO disk stamped "GLEN 1973" set flush on a concrete bridge curb.

TO REACH:

Go to the intersection of Glengary Loop (Co. Rd. #121) and Roberts Creek Rd. (Co. Rd. #16) in T28S, R6W, Sec.24; monument is 159 ft. east along Co. Rd. #16 in SE corner of bridge.

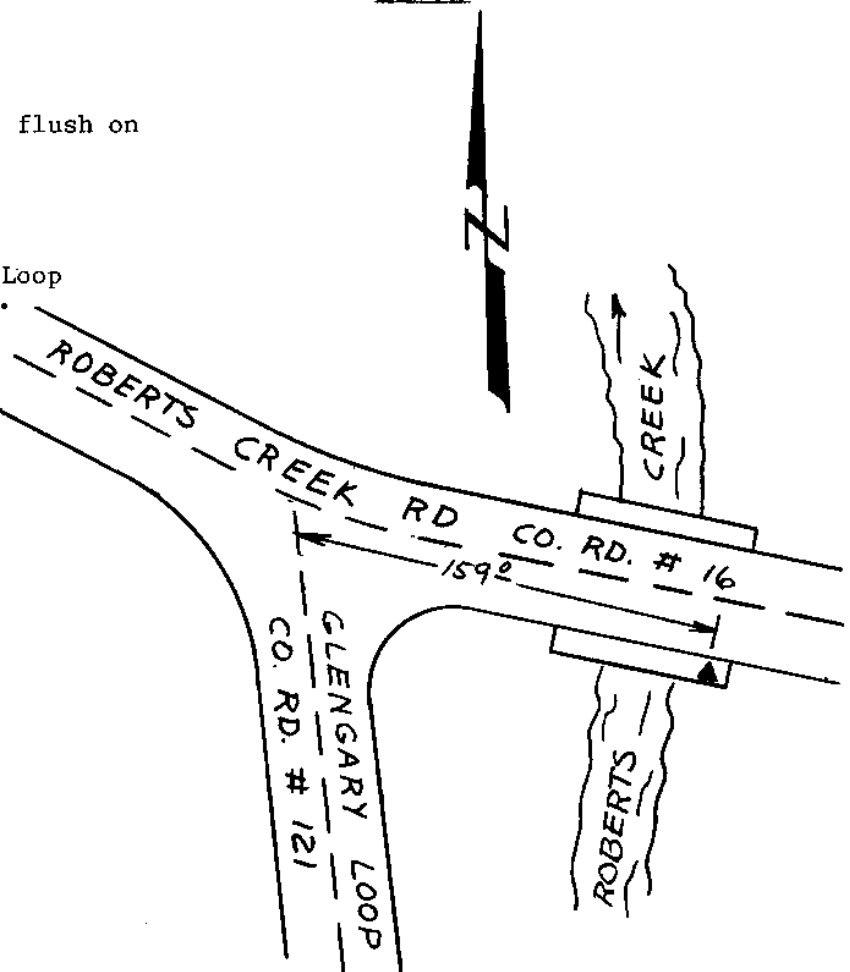

Reference Marks:

Note: For further information, contact the Douglas County Surveyor's Office, Room 205 Douglas County Justice Building, Roseburg, OR 97470. Phone 440-4278. Douglas County residents outside the Roseburg calling area, dial toll free 1-800-452-0991.

OFFICE OF THE  
DOUGLAS COUNTY SURVEYOR

Station: GLEN T 33 S, R 6 W, Sec 5

Set By (Agency): DCSO

Date Set: 1973

Recovered By JP, RS, JRL

Date Recovered 8/15/83

Recovered By \_\_\_\_\_

Date Recovered \_\_\_\_\_

Recovered By \_\_\_\_\_

Date Recovered \_\_\_\_\_

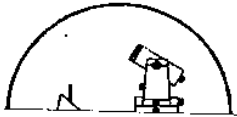
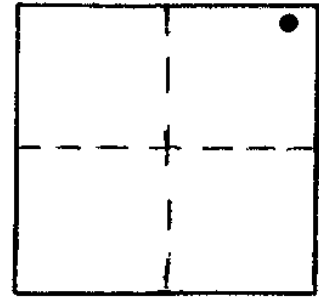

g-028 33S 6W 5  
GLEN 1973

NAD 404098.24 4134342.94  
83 42°44'16" 123°25'48"

VERTICAL CONTROL

Elevation: \_\_\_\_\_ NGS Line # \_\_\_\_\_ USGS Line # \_\_\_\_\_ OSHD Line # \_\_\_\_\_

Precision: \_\_\_\_\_ Agency: \_\_\_\_\_ Proj. # \_\_\_\_\_ Date: \_\_\_\_\_

HORIZONTAL CONTROL

South Zone State Plane Coordinates: Y(Northing) 404,134.22 X(Easting) 1,213,384.38

Precision: 1/25,000 Agency: DCSO Proj. # 2006 Date: 1973

Approximate Geographic Position: Latitude 42°44'16" Longitude 123°25'43"

DESCRIPTION and TO REACH

DESCRIPTION:

A DCSO disk stamped "GLEN 1973" set flush on sidewalk.

TO REACH:

From the intersection of Mt. Ruben Rd. (Co.Rd.#177) and Fifth St. proceed southerly along Fifth St. 168 ft. to station on left.

SKETCH

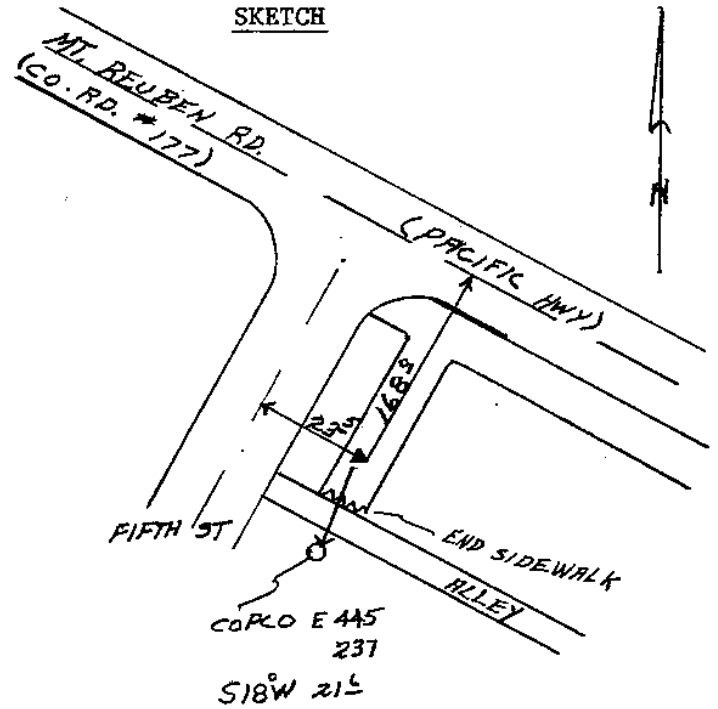

Reference Marks:

Note: For further information, contact the Douglas County Surveyor's Office, Room 205 Douglas County Justice Building, Roseburg, OR 97470. Phone 440-4278. Douglas County residents outside the Roseburg calling area, dial toll free 1-800-452-0991.

**DOUGLAS COUNTY SURVEYOR'S OFFICE**

Designation: G-029 Station: GLENDA T 26S R 6W S 25 1/4 SE

Date Set: 1983 Set by (Agency): DCSO

Date Recovered: 2/28/08 Recovered by: SJF, JAP

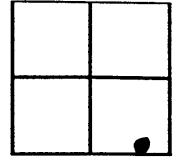

- Found       New       Reset  
 Not Found       Referenced       Destroyed

VERTICAL CONTROL

NGVD 29 Elevation: 478.60 Feet      File # \_\_\_\_\_  
 Precision: 3M      Agency: DCPW      Project: \_\_\_\_\_      Date: 2003  
 NAVD 88 Elevation: \_\_\_\_\_ Meters      File # \_\_\_\_\_  
 Precision: \_\_\_\_\_      Agency: \_\_\_\_\_      Project: \_\_\_\_\_      Date: \_\_\_\_\_

HORIZONTAL CONTROL - south zone

N 598,405.55 E 4,161,583.56      Datum/Adj.: NAD83-FT      Precision: AERIAL PLOT  
 Lat: \_\_\_\_\_ Long: \_\_\_\_\_      Agency: \_\_\_\_\_      File # \_\_\_\_\_      Date: \_\_\_\_\_  
 N \_\_\_\_\_ E \_\_\_\_\_      Datum/Adj.: \_\_\_\_\_      Precision: \_\_\_\_\_  
 Lat: \_\_\_\_\_ Long: \_\_\_\_\_      Agency: \_\_\_\_\_      File # \_\_\_\_\_      Date: \_\_\_\_\_  
 N \_\_\_\_\_ E \_\_\_\_\_      Datum/Adj.: \_\_\_\_\_      Precision: \_\_\_\_\_  
 Lat: \_\_\_\_\_ Long: \_\_\_\_\_      Agency: \_\_\_\_\_      File # \_\_\_\_\_      Date: \_\_\_\_\_  
 N \_\_\_\_\_ E \_\_\_\_\_      Datum/Adj.: \_\_\_\_\_      Precision: \_\_\_\_\_  
 Lat: \_\_\_\_\_ Long: \_\_\_\_\_      Agency: \_\_\_\_\_      File # \_\_\_\_\_      Date: \_\_\_\_\_

DESCRIPTION AND TO REACH

ADCSO DISK STAMPED  
"GLENDA 1983" SET FLUSH  
IN CONCRETE CURB.  
GO TO THE INTERSECTION  
OF HWY 99 AND GLENDA  
AVENUE IN T26S R6W SEC 25.

\* NOTE: CURB IS CRACKED  
DCPW 2003 ELEVATION  
REFLECTS ELEVATION  
CHANGE.

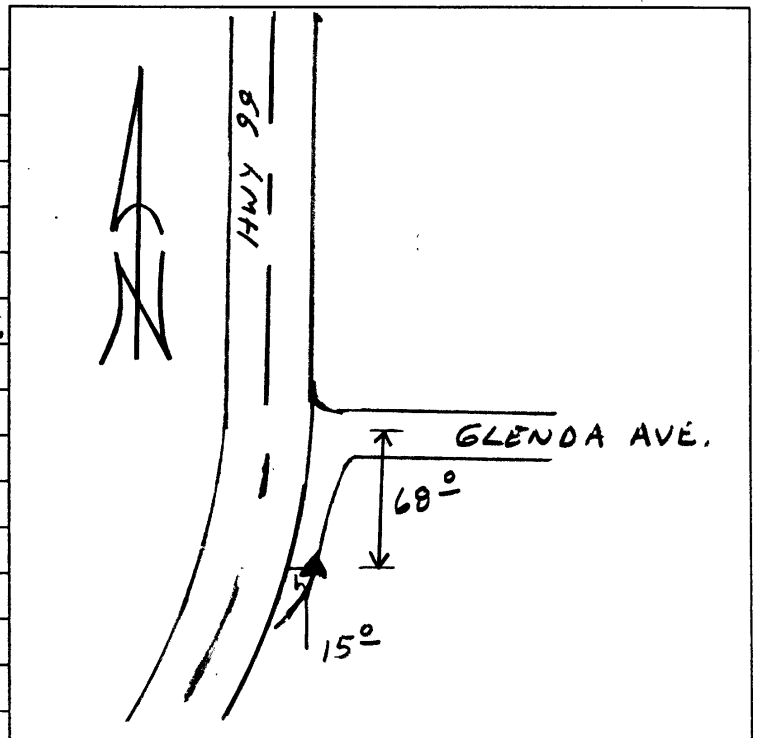



OFFICE OF THE  
DOUGLAS COUNTY SURVEYOR

Station: GLIDE T 26 S, R 3 W, Sec 19

Set By (Agency): OSHD

Date Set: 1937

Recovered By LEM

Date Recovered 5-80

Recovered By \_\_\_\_\_

Date Recovered \_\_\_\_\_

Recovered By \_\_\_\_\_

Date Recovered \_\_\_\_\_

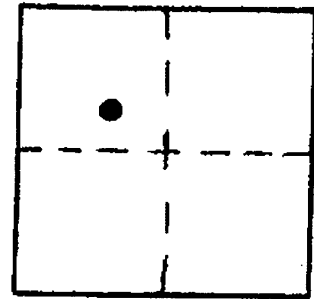

g-030  
GLIDE

26S 3W 19

NAD 604962.16 4228595.43  
83 43°17'50" 123° 6' 9"

VERTICAL CONTROL NGVD 29 CORPSCONG NAVD 88 711.47 FEET

Elevation: 707.912 NGS Line # 94 USGS Line # \_\_\_\_\_ OSHD Line # \_\_\_\_\_

Precision: 1st Agency: USC&GS Proj. # \_\_\_\_\_ Date: 1961

HORIZONTAL CONTROL DCS 27

South Zone State Plane Coordinates: Y(Northing) 604,997.69 X(Easting) 1,307,635.43

Precision: 1/25,000 Agency: DCSO Proj. # 2006 Date: 1973

Approximate Geographic Position: Latitude 43°17'50" Longitude 123°06'04"

DESCRIPTION and TO REACH

SKETCH

Found: A standard OSHD disk stamped "Glide 1937".  
Disk is set in massive rock outcropping above river  
(South of river-North of Hwy. 138) at intersection  
of Hwy 138 & Little River Rd. (Co. Rd. #17A). Disk  
is approximately level with Rd. surface

To reach: At the intersection of Hwy. 138 & Little  
River. South of river and North of Hwy. 138.

NOTE: Brass cap set on bluff immediately above river &  
50' northerly of north edge of pavement, St. Hwy. 38.

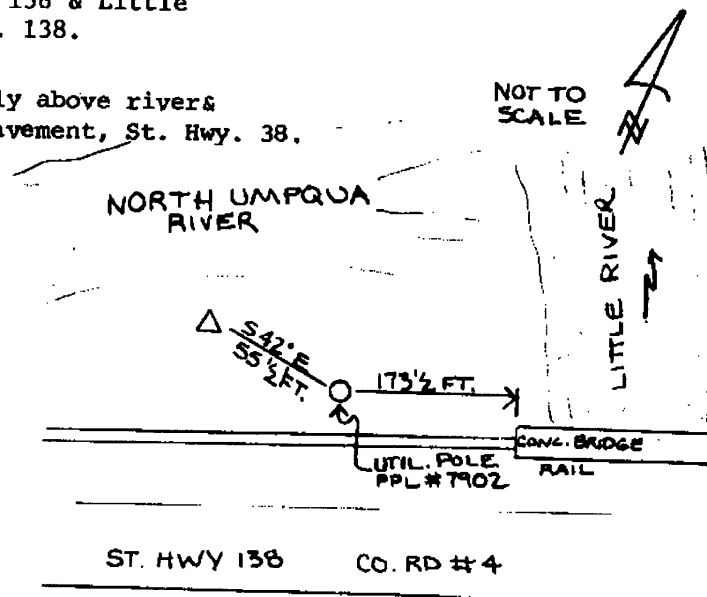

Reference Marks:

Note: For further information, contact the Douglas County Surveyor's Office, Room 205  
Douglas County Justice Building, Roseburg, OR 97470. Phone 440-4278. Douglas  
County residents outside the Roseburg calling area, dial toll free 1-800-452-0991.

OFFICE OF THE  
DOUGLAS COUNTY SURVEYOR

Station: GLORIA T 27 S, R 5 W , Sec 19  
 Set By (Agency): DCSO  
 Date Set: 1982  
 Recovered By JP.TP  
 Date Recovered 7/82  
 Recovered By \_\_\_\_\_  
 Date Recovered \_\_\_\_\_  
 Recovered By \_\_\_\_\_  
 Date Recovered \_\_\_\_\_

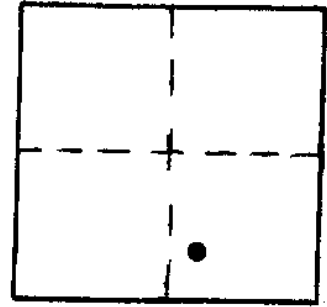

g-031  
GLORIA  
27S 5W 19  
 NAD 572630.68 4165361.43  
 83 43°12'10" 123°20' 9"

VERTICAL CONTROL

Elevation: \_\_\_\_\_ NGS Line # \_\_\_\_\_ USGS Line # \_\_\_\_\_ OSHD Line # \_\_\_\_\_  
 Precision: \_\_\_\_\_ Agency: \_\_\_\_\_ Proj. # \_\_\_\_\_ Date: \_\_\_\_\_

HORIZONTAL CONTROL NAD 27

South Zone State Plane Coordinates: Y(Northing) 572,665.91 X(Easting) 1,244,403.10  
 Precision: 1/20,000 Agency: DCSO Proj. # 2005-2 Date: 1983  
 Approximate Geographic Position: Latitude 43°12'10" Longitude 123°20'04"

DESCRIPTION and TO REACH

DESCRIPTION:

A DCSO disk stamped "GLORIA 1982"  
set flush in concrete curbing.

TO REACH:

From the intersection of SE Terrace Dr.  
and SE Summit Dr. proceed westerly along  
SE Terrace Dr. 0.02 miles to monument  
on right.

SKETCH

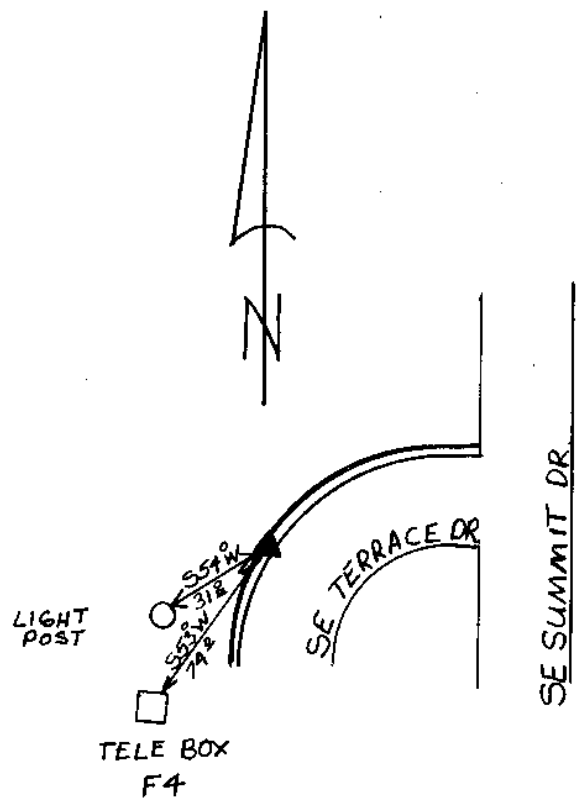

Reference Marks:

Note: For further information, contact the Douglas County Surveyor's Office, Room 205  
Douglas County Justice Building, Roseburg, OR 97470. Phone 440-4278. Douglas  
County residents outside the Roseburg calling area, dial toll free 1-800-452-0991.

OFFICE OF THE  
DOUGLAS COUNTY SURVEYOR

Station: GOEDECK T 27 S, R 6 W, Sec 22

Set By (Agency): DCSO

Date Set: 1982

Recovered By JP

Date Recovered 1/4/88

Recovered By RWS

Date Recovered 2000 / RWS SJP

Recovered By \_\_\_\_\_

Date Recovered \_\_\_\_\_

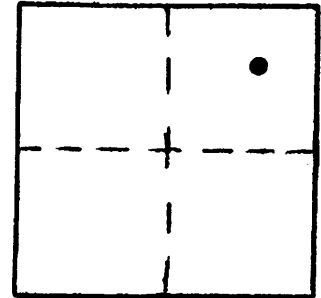

g-033  
GOEDECK

27S 6W 22

NAD 575841.63 4149238.66  
83 43°12'36" 123°23'48"

VERTICAL CONTROL NGVD 29 CORP CON 6 NAVD 88 433.994 FEET

Elevation: 430.527 NGS Line # \_\_\_\_\_ USGS Line # \_\_\_\_\_ OSHD Line # \_\_\_\_\_

Precision: 2nd Agency: DCSO Proj. # 2007 Date: 1990

HORIZONTAL CONTROL OCS 27

South Zone State Plane Coordinates: Y(Northing) 575,876.73 X(Easting) 1,228,280.26

Precision: 1/20,000 Agency: DCSO Proj. # 2005-2 Date: 1983

Approximate Geographic Position: Latitude 43°12'36.9" Longitude 123°23'43.4"

DESCRIPTION and TO REACH

SKETCH

DESCRIPTION:

A DCSO disk stamped "GOEDECK 1982" set in a 6 in. by 36 in. concrete filled belltile protruding 5 in. above ground.

TO REACH:

Go to intersection of W. Godeck Ave. and Old Melrose Rd. (Co. Rd. #13).

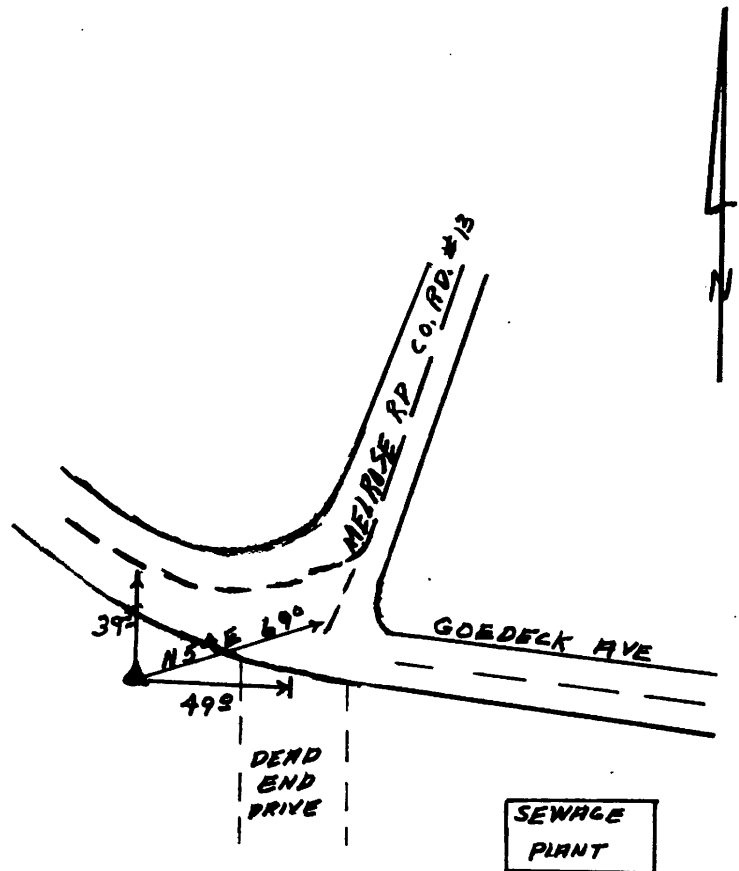

Reference Marks:

Note: For further information, contact the Douglas County Surveyor's Office, Room 205 Douglas County Justice Building, Roseburg, OR 97470. Phone 440-4278. Douglas County residents outside the Roseburg calling area, dial toll free 1-800-452-0991.

OFFICE OF THE  
DOUGLAS COUNTY SURVEYOR

Station: Gorda. T 30 S, R 6W, Sec 13

Set By (Agency): DCSO

Date Set: 1978

Recovered By JP-RWS

Date Recovered 2-18-82

Recovered By \_\_\_\_\_

Date Recovered \_\_\_\_\_

Recovered By \_\_\_\_\_

Date Recovered \_\_\_\_\_

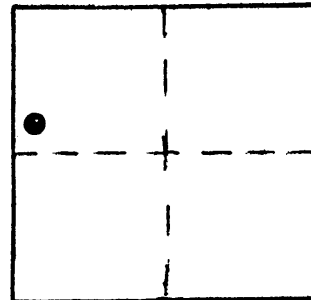

G-034 305 6W 13  
GORDA

NAD 485879.16 4154481.95  
83 42°57'50" 123°21'55"

VERTICAL CONTROL

Elevation: \_\_\_\_\_ NGS Line # \_\_\_\_\_ USGS Line # \_\_\_\_\_ OSHD Line # \_\_\_\_\_

Precision: \_\_\_\_\_ Agency: \_\_\_\_\_ Proj. # \_\_\_\_\_ Date: \_\_\_\_\_

HORIZONTAL CONTROL OCS 27

South Zone State Plane Coordinates: Y(Northing) 485,915.06 X(Easting) 1,233,523.54

Precision: 1/25,000 Agency: DCSO Proj. # 2008 Date: 1978

Approximate Geographic Position: Latitude \_\_\_\_\_ Longitude \_\_\_\_\_

DESCRIPTION and TO REACH

SKETCH

Found: A standard DCSO disk stamped "Gorda 1978" set in a 6" dia. concrete filled tile 3" above the ground.

To reach: From the intersection of Co.Rd. #264 (Main St. of Riddle) and Co. Rd.#263 in T30S R6W sec. 23 proceed Northeasterly along Co.Rd. #263 .7 miles to monument on the left.

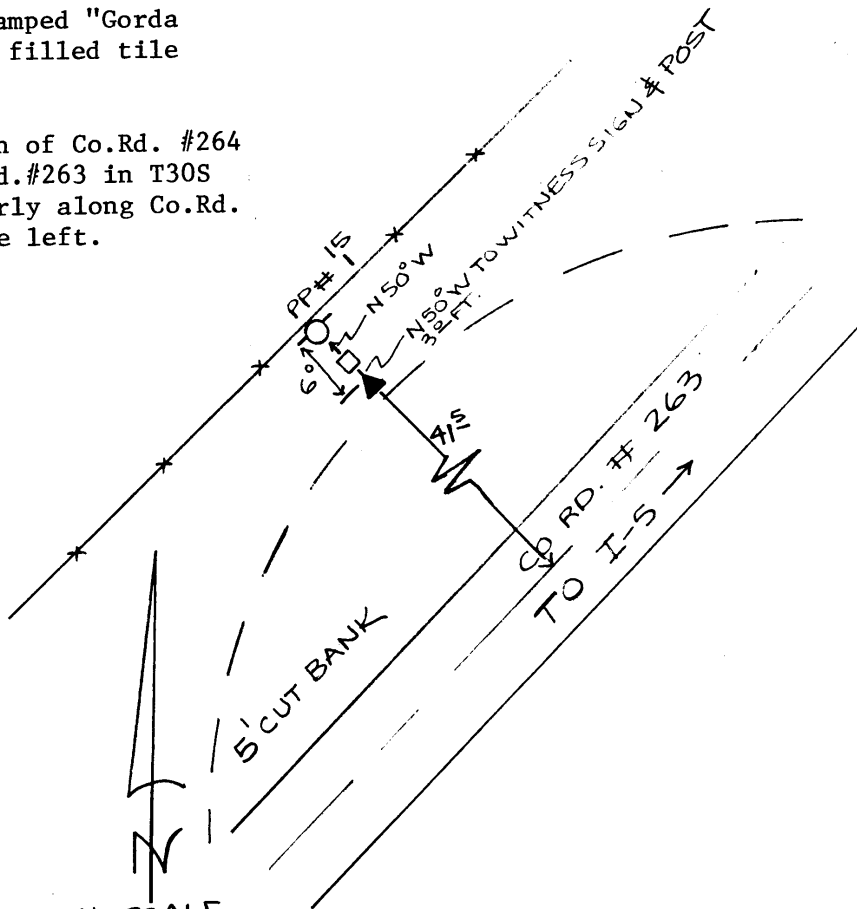

Reference Marks:

Note: For further information, contact the Douglas County Surveyor's Office, Room 205 Douglas County Justice Building, Roseburg, OR 97470. Phone 440-4278. Douglas County residents outside the Roseburg calling area, dial toll free 1-800-452-0991.

OFFICE OF THE  
DOUGLAS COUNTY SURVEYOR

Station: GRAYBACK 2 T 32 S, R 6 W, Sec 18

Set By (Agency): DCSO

Date Set: 1973

Recovered By \_\_\_\_\_

Date Recovered \_\_\_\_\_

Recovered By \_\_\_\_\_

Date Recovered \_\_\_\_\_

Recovered By \_\_\_\_\_

Date Recovered \_\_\_\_\_

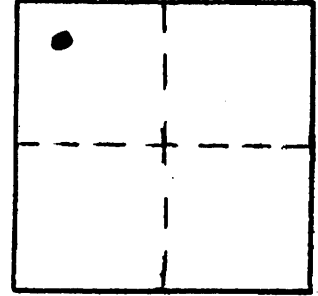

G-039

G-039  
GRAYBACK 2 32S 6W 18

NAD 425028.83 4127122.85  
83 42°47'40" 123°27'34"

VERTICAL CONTROL NGVD 29 CORPSCON 6 NAVD 88 3648 FEET

Elevation: 3,644 NGS Line # \_\_\_\_\_ USGS Line # \_\_\_\_\_ OSHD Line # \_\_\_\_\_

Precision: V.A. Agency: DCSO Proj. # 2006 Date: 1973

HORIZONTAL CONTROL OCS 27

South Zone State Plane Coordinates: Y(Northing) 425,064.68 X(Easting) 1,206,164.25

Precision: 1/50,000 Agency: DCSO Proj. # 2006 Date: 1973

Approximate Geographic Position: Latitude 42°47'40" Longitude 123°27'30"

DESCRIPTION and TO REACH

SKETCH

Top of Grayback Mtn.

Reference Marks:

Note: For further information, contact the Douglas County Surveyor's Office, Room 205 Douglas County Justice Building, Roseburg, OR 97470. Phone 440-4278. Douglas County residents outside the Roseburg calling area, dial toll free 1-800-452-0991.

OFFICE OF THE

DOUGLAS COUNTY SURVEYOR

1/19/81

g-041  
GREEN BUTTE

26S 7W 8

NAD 621045.45 4109544.33  
83 43°19'49" 123°33' 6"

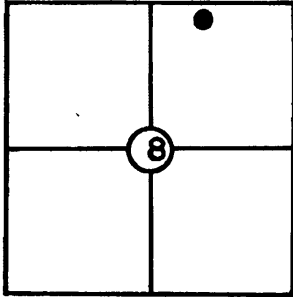

T 26 S, R 7 W, Sec. 8

Station: GREEN BUTTE

Set By (Agency): DCSO

Date: 1971

VERTICAL CONTROL CORPS CON 6 NAVD88 2451 FT

NGVD 29

Elevation: 2447 NGS(USC&GS) Line # \_\_\_\_\_ USGS Line # \_\_\_\_\_

Order (Roseburg Primary)  
Of Precision VA Agency: DCSO Proj. #: 2002 Date: 1971

HORIZONTAL CONTROL

OCS 27

Oregon State Plane Coordinates: Y(Northing) 621,080.49 X(Easting) 1,188,585.36  
(South Zone)

Order (Roseburg Primary)  
Of Precision 1/100,000 Agency: DCSO Proj. #: 2002 Date: 1971

Approximate Geographic Position: Latitude= 43°19'49" Longitude= 123°33'01"

DESCRIPTION: From the intersection of Co. Rd. #13 and BLM Rd. #26-7-11, proceed along 26-7-11 approx. 2 mi. to gate. Proceed through gate along 26-7-11 0.4 mi. to intersection with BLM Rd. #26-7-9.1. Cont. along 26-7-11 (left fork) to another intersection with BLM Rd. #26-7-8. Cont. along 26-7-11 0.1 mi. to intersection with BLM Rd. # 25-8-36.0. Cont. along 26-7-11 to turnoff on right side of road in curve to right. Witness post set on West side of road approx. 7 ft. above road in grassy area. Station bears N78°W approx. 300 ft. † from witness post. Total dist. from intersection of Co. Rd. #13 and 26-7-11 is 4.1 mi.

SKETCH

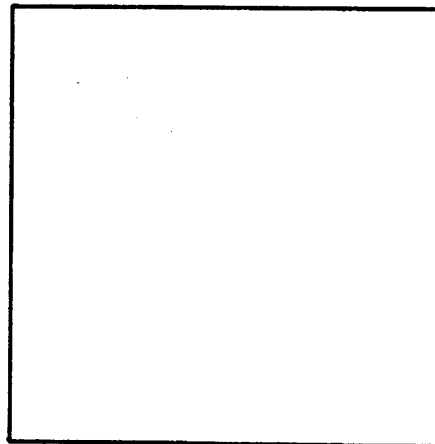

4-81 NOTE: Thick brush prohibits seeing almost all directions, RM2 found okay. GEQ GREEN BUTTE RM 2 bears N 71° 58' 40" E 39.68 ft. (grid)

NOTE: For Possible Further Information On This Station, Please Contact The Douglas County Surveyors Office, Rm. 205 Douglas County Justice Bldg., Roseburg, OR. 97470 Phone 672-3311 Ext. 272.. Douglas County residents outside the Roseburg calling area dial toll free 1-800-452-0991.

OFFICE OF THE  
DOUGLAS COUNTY SURVEYOR

Station: GREG T 27 S, R 6 E, Sec 8 UNS  
 Set By (Agency): DCSO  
 Date Set: 1974  
 Recovered By FLI (DCSO)  
 Date Recovered 6-15-84  
 Recovered By O.D.O.T.  
 Date Recovered 9-10-98  
 Recovered By \_\_\_\_\_  
 Date Recovered \_\_\_\_\_

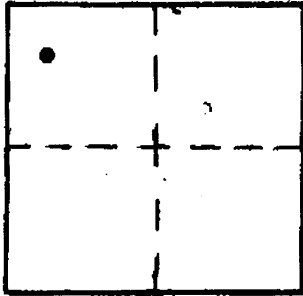

g-043  
GREG

275 6E 8

NAD 576566.75 4483219.92  
83 43°14'13" 122° 8'38"

VERTICAL CONTROL NGVD 29 CORPSCON 6 NAVD88 4825.442 FEET  
 Elevation: 4821.186 NGS Line # \_\_\_\_\_ USGS Line # \_\_\_\_\_ OSHD Line # \_\_\_\_\_  
 Precision: 2nd Agency: DCSO Proj. # 2004-8 Date: 1974

HORIZONTAL CONTROL OCS 27  
 South Zone State Plane Coordinates: Y(Northing) 576,604.34 X(Easting) 1,562,258.12  
 Precision: 1/25,000 Agency: DCSO Proj. # 2004-8 CS57/23 Date: 1975  
 Approximate Geographic Position: Latitude 43°14'13" Longitude 122°08'34"

DESCRIPTION and TO REACH

At junction of Hwy 138  
and USFS Road No. 4793  
(formerly 2711) on cut-bank  
N.E. of intersection.  
  
B.C. set in 6" bell tile.  
20 ft. from Road No. 4793  
and 30 ft. from Hwy 138.

SKETCH

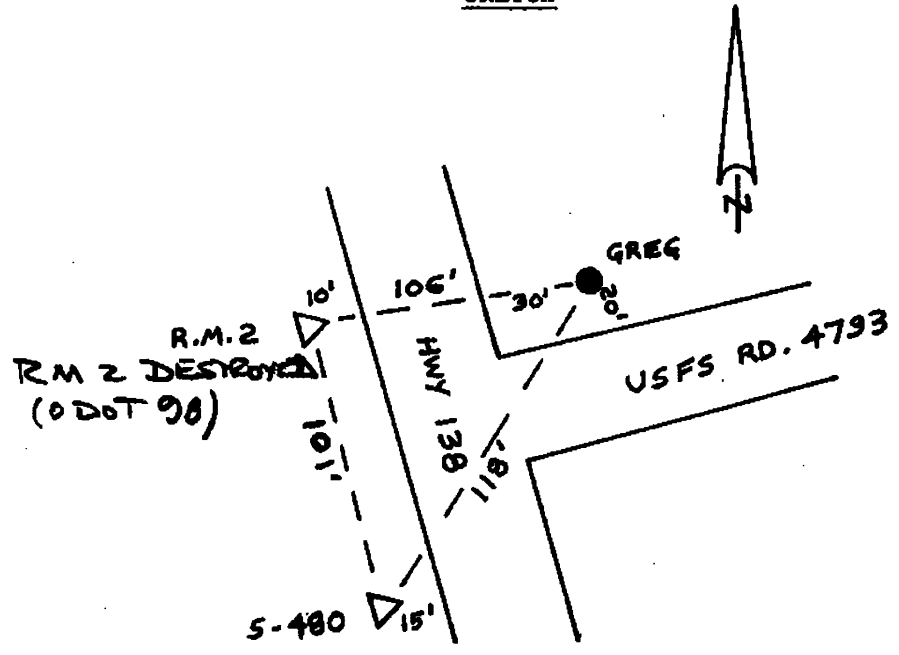

Reference Marks: (Greg R.M. 2 R.M. 2 DESTROYED (ODOT 98))  
 B.C. in 6" bell tile (El. 4813.815)  
 576,587.46 1,562,153.68

BM S-480 B.C. in concrete post (El. 4814.400)  
 576,499.87 1,562,203.84

Note: For further information, contact the Douglas County Surveyor's Office, Room 205 Douglas County Justice Building, Roseburg, OR 97470. Phone 440-4278. Douglas County residents outside the Roseburg calling area, dial toll free 1-800-452-0991.

OFFICE OF THE  
DOUGLAS COUNTY SURVEYOR

Station: GROSS

T25W R6W Sec. 22

Date Set: 1980

Set By (Agency): DCSO

DCSO Designation: G-044

Date Recovered: \_\_\_\_\_

Recovered By: \_\_\_\_\_

Date Recovered: \_\_\_\_\_

Recovered By: \_\_\_\_\_

Date Recovered: \_\_\_\_\_

Recovered By: \_\_\_\_\_

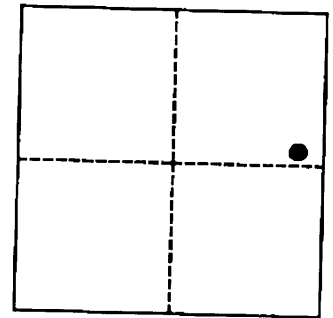
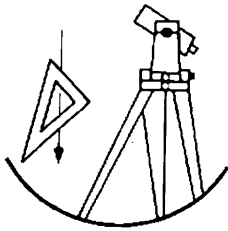

VERTICAL CONTROL

NGVD 29 Elevation: 425.81 FEET

CORRSCON 6  
NAVD 88 Elevation: 429.31 FEET  
METERS

NGS Line # \_\_\_\_\_ USGS LINE # \_\_\_\_\_

OSHD Line # \_\_\_\_\_ FILE # \_\_\_\_\_

Precision: 3RD ORDER Agency: DCSO Proj: 2006 Calapooya Date: 1981

HORIZONTAL CONTROL

O.C.S. 27 Y(Northing): 638,353.99

O.C.S. 83 Y(Northing): 638,319.34

(South Zone) X(Easting): 1,232,750.75

(South Zone) X(Easting): 4,153,709.78

Precision: 1/25,000 Agency: DCSO Proj: 2006 Calapooya Date: 1981

Approx. O.C.S. 27 Geographic Position: Latitude: 43°22'55" Longitude: 123°23'12"

Approx. O.C.S. 83 Geographic Position: Latitude: 43°22'55" Longitude: 123°23'16"

Description: Station mark is a standard DCSO brass cap set in 8" X 42" bell tile filled with concrete 5" above ground. Stamped "GROSS 1980". Monument is 27 ft. from centerline of Co. Rd. #9 and approx. 175 ft. west of Co. Rd. #32A. See sketch. Monument is 5 ft above road bed. Witness post is north of cap.

To reach: From intersection of Co. Rd. #32A and Co. Rd. #9 continue west on Co. Rd. #9 approx. 175 ft. to station on north side of road.

REFERENCE MARKS: A DCSO disk stamped "GROSS RM 1 1980" bears N83°13'01"E 159.17 (grid)

A DCSO disk stamped "GROSS RM 2 1980" bears S15°30'16"E 56.23 (grid)

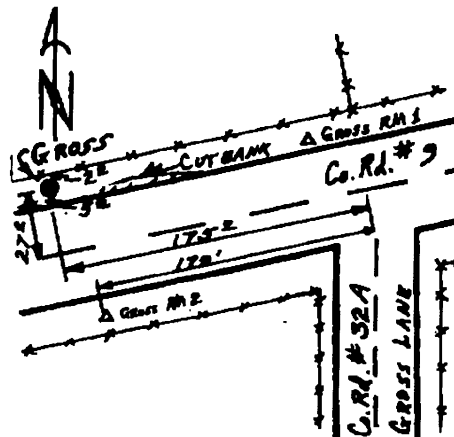

Note: For further information contact the Douglas County Surveyors Office, Room 205 Douglas County Justice Building, Roseburg, OR 97470. Phone 440-4272. Douglas County Residents outside Roseburg calling area, dial toll free 1-800-477-0991.

OFFICE OF THE  
DOUGLAS COUNTY SURVEYOR

Station: Gunderson T 27 S, R 2W , Sec 8

Set By (Agency): DCSO

Date Set: 1974

Recovered By KR-TP

Date Recovered 6-3-82

Recovered By RWS-SJF 1999

Date Recovered \_\_\_\_\_

Recovered By \_\_\_\_\_

Date Recovered \_\_\_\_\_

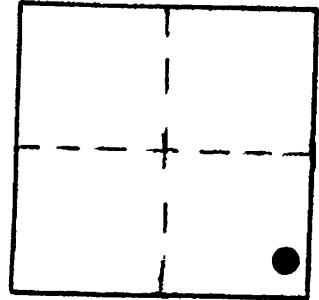

g-046  
GUNDERSON 27S 2W 8

NAD 580090.43 4267363.18  
89 43°13'56" 122°57'15"

VERTICAL CONTROL

NGVD 29

CORPSCON 6 NAVD 88 1046.26 FEET

Elevation: 1042.59 NGS Line # \_\_\_\_\_ USGS Line # \_\_\_\_\_ OSHD Line # \_\_\_\_\_

Precision: 3<sup>rd</sup> Agency: DCSO Proj. # CS66/56 Date: 1999

HORIZONTAL CONTROL NAD 27

South Zone State Plane Coordinates: Y(Northing) 580,126.80 X(Easting) 1,346,403.44

Precision: 1/25,000 Agency: DCSO Proj. # 2004-1 CS56/21 Date: 1974

Approximate Geographic Position: Latitude 43°13'56" Longitude 122°57'11"

DESCRIPTION and TO REACH

SKETCH

Found: A standard DCSO disc set in a concrete filled bell tile stamped "Gunderson 1974" protruding 0.5 ft. above the ground.

To reach: From the intersection of New Bridge Rd. (Co. Rd. #82A) and Little River Rd. (Co. Rd. #17) in T27S R3W sec. 12 proceed Easterly along Little River Rd. 3.2 mi. to monument on the right.

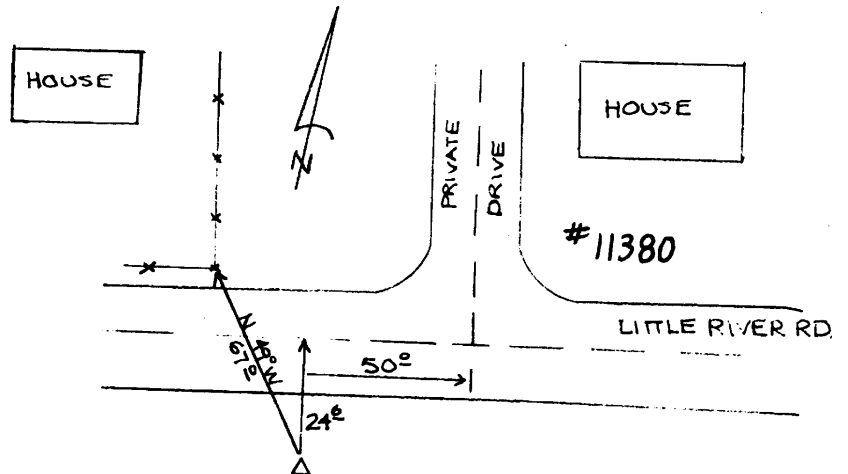

Reference Marks:

Note: For further information, contact the Douglas County Surveyor's Office, Room 205 Douglas County Justice Building, Roseburg, OR 97470. Phone 440-4278. Douglas County residents outside the Roseburg calling area, dial toll free 1-800-452-0991.

OFFICE OF THE  
DOUGLAS COUNTY SURVEYOR

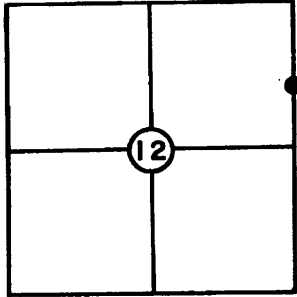

T 21 S, R 6W, Sec. 12

Station: B.M. GWM 4

Set By (Agency): USGS

Date: 1940

G-049

NGVD 29

VERTICAL CONTROL CORPSON 6 NAVD 88 953.78 FT.

Elevation: 950.03 NGS(USC&GS) Line # \_\_\_\_\_ USGS Line # 236

Order  
Of Precision 3rd Agency: USGS Proj. #: \_\_\_\_\_ Date: 1947

HORIZONTAL CONTROL

Oregon State Plane Coordinates: Y(Northing) \_\_\_\_\_ X(Easting) \_\_\_\_\_  
(South Zone)

Order  
Of Precision \_\_\_\_\_ Agency: \_\_\_\_\_ Proj. #: \_\_\_\_\_ Date: \_\_\_\_\_

Approximate Geographic Position: Latitude= \_\_\_\_\_ Longitude= \_\_\_\_\_

DESCRIPTION: USGS Disk in concrete post  
16' N.E. of Road E @ top of grade & stamped  
"GWM 4 1940 950".

NOTE: Concrete post slightly loose.

\_\_\_\_\_  
\_\_\_\_\_  
\_\_\_\_\_  
\_\_\_\_\_  
\_\_\_\_\_

VICINITY: 10.5 mi. NNW of Drain. 0.5 mi.

SE of Mouth of Tip Davis CRK.

SKETCH

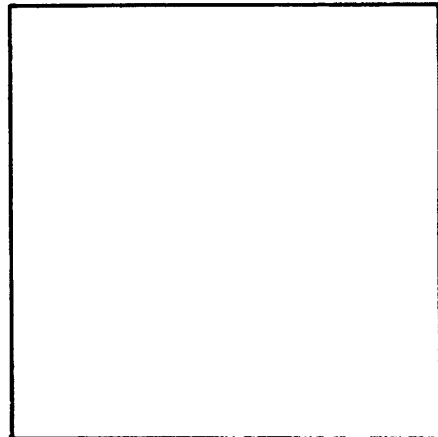

NOTE: For Possible Further Information On This Station, Please Contact The Douglas County Surveyors Office, Rm. 205 Douglas County Justice Bldg., Roseburg, OR. 97470 Phone 672-3311 Ext. 272.. Douglas County residents outside the Roseburg calling area dial toll free 1-800-452-0991.

OFFICE OF THE  
DOUGLAS COUNTY SURVEYOR

G-050

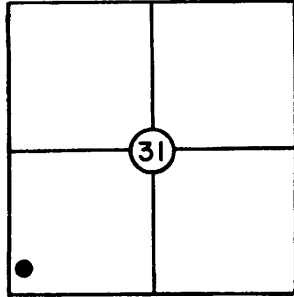

T 20 S, R 6W, Sec. 31

Station: GWM 8

Set By (Agency): U.S.G.S.

Date: 1940

VERTICAL CONTROL CORPSCON 6 NAVD88 685.18 FT.

NGVD 29

Elevation: 681.426 NGS(USC&GS) Line # \_\_\_\_\_ USGS Line # 236

Order  
Of Precision THIRD Agency: U.S.G.S. Proj. #: \_\_\_\_\_ Date: 1947

HORIZONTAL CONTROL

NAD 27

Oregon State Plane Coordinates: Y(Northing) \_\_\_\_\_ X(Easting) \_\_\_\_\_  
(South Zone)

Order  
Of Precision \_\_\_\_\_ Agency: \_\_\_\_\_ Proj. #: \_\_\_\_\_ Date: \_\_\_\_\_

Approximate Geographic Position: Latitude= \_\_\_\_\_ Longitude= \_\_\_\_\_

DESCRIPTION: DISK STAMPED "GWM 8 1940 681",

SET IN CONCRETE SLAB 66 FT. S.W. OF

ROAD CL. BUILDINGS NOW GONE.

\_\_\_\_\_  
\_\_\_\_\_  
\_\_\_\_\_  
\_\_\_\_\_  
\_\_\_\_\_  
\_\_\_\_\_

VICINITY: 3 mi. W. of Beaver Cr. School

on E. side of entrance to S. fork Ranger Station.

SKETCH

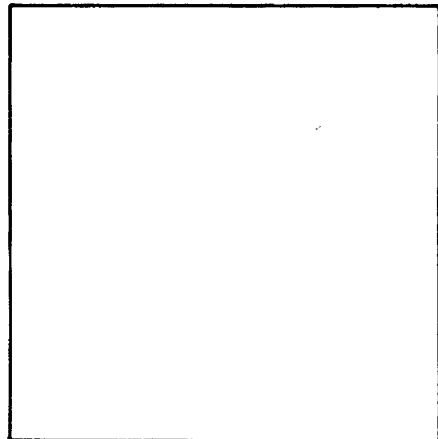

NOTE: For Possible Further Information On This Station, Please Contact The Douglas County Surveyors Office, Rm. 205 Douglas County Justice Bldg., Roseburg, OR. 97470 Phone 672-3311 Ext. 272. Douglas County residents outside the Roseburg calling area dial toll free 1-800-452-0991.

G051

OFFICE OF THE  
DOUGLAS COUNTY SURVEYOR

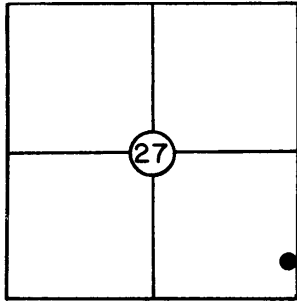

T 20 S, R 7W, Sec. 27

Station: B.M. GWM 10

Set By (Agency): U.S.G.S.

Date: 1940

NGVD 29

VERTICAL CONTROL

Elevation: 636.211 NGS(USC&GS) Line # \_\_\_\_\_ USGS Line # 236

Order  
Of Precision THIRD Agency: U.S.G.S. Proj. #: \_\_\_\_\_ Date: 1947

HORIZONTAL CONTROL

Oregon State Plane Coordinates: Y(Northing) \_\_\_\_\_ X(Easting) \_\_\_\_\_  
(South Zone)

Order  
Of Precision \_\_\_\_\_ Agency: \_\_\_\_\_ Proj. #: \_\_\_\_\_ Date: \_\_\_\_\_

Approximate Geographic Position: Latitude= \_\_\_\_\_ Longitude= \_\_\_\_\_

DESCRIPTION: 400 Ft. W. of old post office location, 20 ft.

S.W. of forks of road leading N. to Alma,  
10 ft. West of signpost. Standard tablet  
stamped "GWM 10 1940 636".

SKETCH

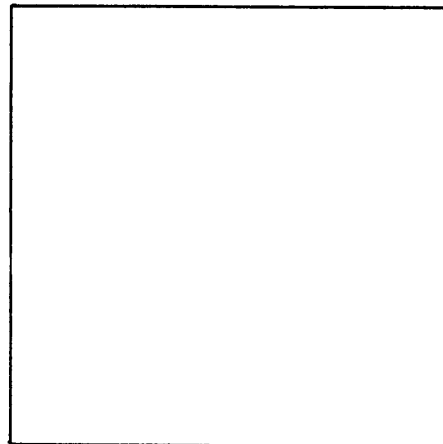

VICINITY: At Gunter near fork in road.

NOTE: For Possible Further Information On This Station, Please Contact The Douglas County Surveyors Office, Rm. 205 Douglas County Justice Bldg., Roseburg, OR. 97470 Phone 672-3311 Ext. 272. Douglas County residents outside the Roseburg calling area dial toll free 1-800-452-0991.

OFFICE OF THE  
DOUGLAS COUNTY SURVEYOR

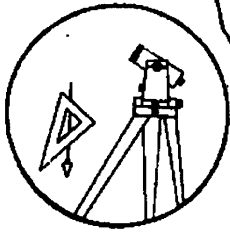

G-053

Station: GWM 52 T 28 S, R 8 W, Sec 14  
 Set By (Agency): USGS  
 Date Set: 1942  
 Recovered By RS,SF  
 Date Recovered 8/14/84  
 Recovered By \_\_\_\_\_  
 Date Recovered \_\_\_\_\_  
 Recovered By \_\_\_\_\_  
 Date Recovered \_\_\_\_\_

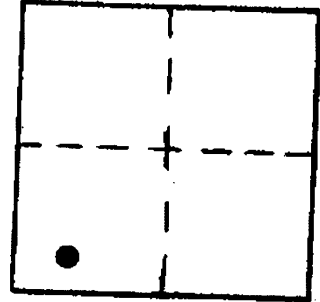

VERTICAL CONTROL NGVD 29 CORRS COM 6 NAVD 88 870.978 FEET  
 Elevation: 867.492 NGS Line # 99 USGS Line # \_\_\_\_\_ OSHD Line # \_\_\_\_\_  
 Precision: 2nd Agency: USC&GS Proj. # \_\_\_\_\_ Date: 1957

HORIZONTAL CONTROL  
 South Zone State Plane Coordinates: Y(Northing) \_\_\_\_\_ X(Easting) \_\_\_\_\_  
 Precision: \_\_\_\_\_ Agency: \_\_\_\_\_ Proj. # \_\_\_\_\_ Date: \_\_\_\_\_  
 Approximate Geographic Position: Latitude \_\_\_\_\_ Longitude \_\_\_\_\_

DESCRIPTION and TO REACH

SKETCH

DESCRIPTION:

A USC&GS disk stamped "867 GWM 1942" set flush in the northwest corner of a concrete bridge curb.

From the intersection of Reston Rd. (Co. Rd. #5) and Coos Bay Wagon Rd. (Co. RD. #112) in T28S,R8W,Sec.14 proceed southerly along Reston Rd. 0.6 miles to a bridge over a tributary of Tenmile Creek.

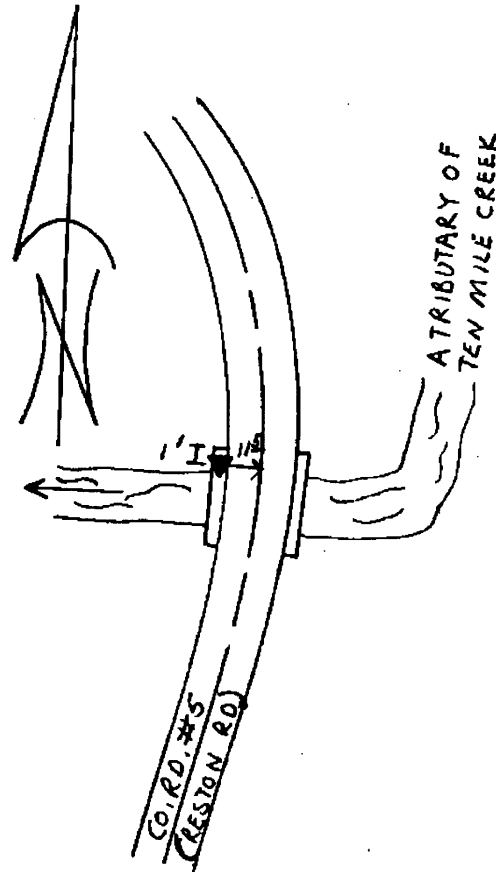

Reference Marks:

Note: For further information, contact the Douglas County Surveyor's Office, Room 205 Douglas County Justice Building, Roseburg, OR 97470. Phone 440-4278. Douglas County residents outside the Roseburg calling area, dial toll free 1-800-452-0991.

OFFICE OF THE  
DOUGLAS COUNTY SURVEYOR

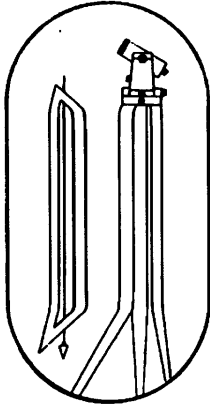

G-054

Station:          GWM 54          T 28 S, R 8 W , Sec 1

Set By (Agency): USGS

Date Set: 1942

Recovered By RS, SJF

Date Recovered Sept. 20, 1984



Date Recovered         

Recovered By         

Date Recovered         

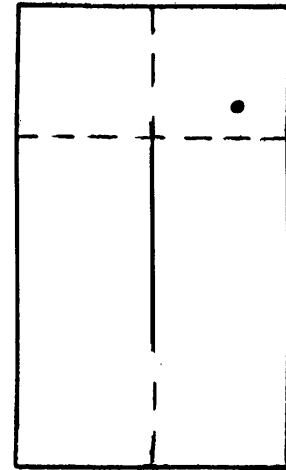

VERTICAL CONTROL NGVD 29 CORPS CON 6 NAVD 88 868,437 FEET

Elevation: 864.946 NGS Line #          USGS Line #          OSHD Line #         

Precision: 2nd Agency: DCPW Proj. # 2013 Date: 1982