

OFFICE OF THE
DOUGLAS COUNTY SURVEYOR

Station: GAZE
 Set By (Agency): DCSO
 Date Set: 1975
 Recovered By JMP-RS
 Date Recovered 2/82
 Recovered By RWS/SF
 Date Recovered 1/2002
 Recovered By _____
 Date Recovered _____

T 30 S, R 5 W , Sec 22



g-019
GAZE

30S 5W 22

NAD 478421.14 4175640.15
 83 42°56'43" 123°17' 8"

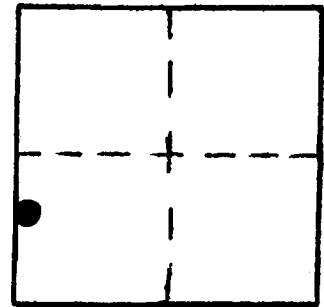

VERTICAL CONTROL NGVD 29 CORPSCON 6 NAVD 88 697.24 FT

Elevation: 693.88 FT. NGS Line # _____ USGS Line # _____ OSHD Line # _____
 Precision: 3rd Agency: DCSO Proj. # 66/041 Date: 2002

HORIZONTAL CONTROL OCS 27

South Zone State Plane Coordinates: Y(Northing) 478,456.96 X(Easting) 1,254,681.52
 Precision: 1/25,000 Agency: DCSO Proj. # 2004-10 CS 57/27 Date: 1975
 Approximate Geographic Position: Latitude 42°56'44" Longitude 123°17'03"

DESCRIPTION and TO REACH

Station is a standard DCSO disk stamped "GAZE 1975" set flush on the NE corner of a concrete curb of a bridge over the South Umpqua.

To Reach: From the intersection of a frontage road northerly of I-5 and Co. Rd. 35 (Gazely Rd.) in the NE corner of S.28 T30S, R5W, proceed Northerly on Co. Rd. 35 0.4 mi. to intersection of Co. Rd. 35 and Co. Rd. 35A.

SKETCH

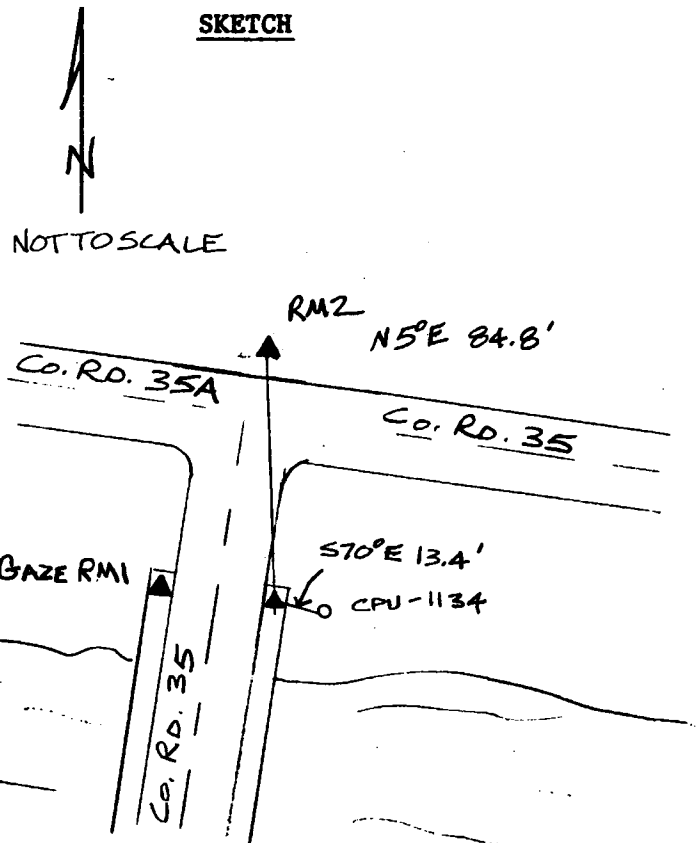

Reference Marks:

"GAZE 1975 RM NO 1" is a standard DCSO disk NW corner of bridge abutment and bears N76°45'16"W 25.49 ft. (grid) from the station. Elev. 692.97 FT.

"GAZE 1975 RM NO 2 1978" is a standard DCSO disk set in concrete filled belltile and bears N 9°36'57"E 85.25 ft. (grid) from the station. Elev. 688.37 FT.

Note: For further information, contact the Douglas County Surveyor's Office, Room 205 Douglas County Justice Building, Roseburg, OR 97470. Phone 440-4278. Douglas County residents outside the Roseburg calling area, dial toll free 1-800-452-0991.