

OFFICE OF THE  
DOUGLAS COUNTY SURVEYOR

97015  
GARY

255 30 15

430  
30

740629.08  
431271451

4126769.27  
1834231821

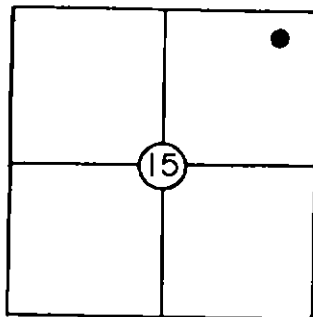

T 22 S, R 6W, Sec. 15

Station: Gary

Set By (Agency): DCSO

Date: 1978

VERTICAL CONTROL

Elevation: \_\_\_\_\_ NGS(USC&GS) Line # \_\_\_\_\_ USGS Line # \_\_\_\_\_

Order  
Of Precision \_\_\_\_\_ Agency: \_\_\_\_\_ Proj. #: \_\_\_\_\_ Date: \_\_\_\_\_

HORIZONTAL CONTROL

Oregon State Plane Coordinates: Y(Northing) 740629.79 X(Easting) 1,235,808.86  
(South Zone)

Order  
Of Precision 1/50,000 Agency: DCSO Proj. #: 2008 Date: 1979

Approximate Geographic Position: Latitude= \_\_\_\_\_ Longitude= \_\_\_\_\_

DESCRIPTION: B.C. in belltile stamped "Gary 1978"

Cap is 54' N. of Hwy. 38 centerline at inter-

section of Co. Rd. #66 and Hwy. 38, and 2.5'

S. of witness post in fenceline.

SKETCH

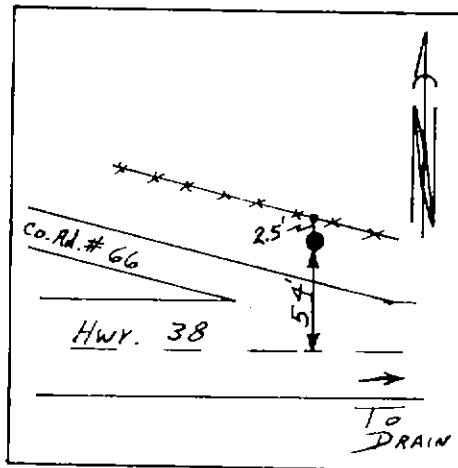

VICINITY: Approx. 3.8 mi. W'stly along Hwy.

38 from the intersection of Hwys 38 & 99 in Drain.

NOTE: For Possible Further Information On This Station, Please Contact The Douglas County Surveyors Office, Rm. 205 Douglas County Justice Bldg., Roseburg, OR. 97470 Phone 672-3311 Ext. 272. Douglas County residents outside the Roseburg calling area dial toll free 1-800-452-0991.