

OFFICE OF THE  
DOUGLAS COUNTY SURVEYOR

Station: G 554 T 28 S, R 6 W, Sec 22

Set By (Agency): U.S.C. & G.S.

Date Set: 1954

Recovered By RS, SJF

Date Recovered June 19, 1984

Recovered By \_\_\_\_\_

Date Recovered \_\_\_\_\_

Recovered By \_\_\_\_\_

Date Recovered \_\_\_\_\_

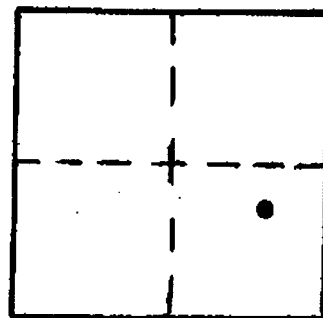
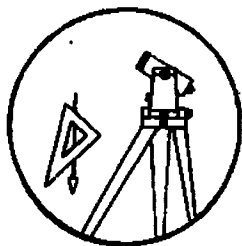

G-005

VERTICAL CONTROL NGVD 29 CORPSCON 6 NAVD 88 524.358 FT

Elevation: 520.918 Ft. NGS Line # 6 USGS Line # \_\_\_\_\_ OSHD Line # \_\_\_\_\_

Precision: 1st. Agency: USC&GS Proj. # \_\_\_\_\_ Date: 1957

HORIZONTAL CONTROL

South Zone State Plane Coordinates: Y(Northing) \_\_\_\_\_ X(Easting) \_\_\_\_\_

Precision: \_\_\_\_\_ Agency: \_\_\_\_\_ Proj. # \_\_\_\_\_ Date: \_\_\_\_\_

Approximate Geographic Position: Latitude \_\_\_\_\_ Longitude \_\_\_\_\_

DESCRIPTION and TO REACH

A U.S.C. & G.S. disk stamped "G 554 1954" set flush in a concrete culvert headwall.

TO REACH:

From the intersection of Roberts Creek Road (Co. Rd. #16) and Roberts Mountain Road (Co. Rd. #123) in T28S, R6W, Sec. 14, proceed southerly along Roberts Mountain Road approximately 0.85 miles to Southern Pacific Rail Road crossing C565.5. From crossing C565.5 proceed, on foot, south-westerly along S. P. railline approximately 0.8 miles to monument on right. Monument lies in northeast end of a concrete culvert head-wall approximately 10 feet lower than tracks.

SKETCH  
(no scale)

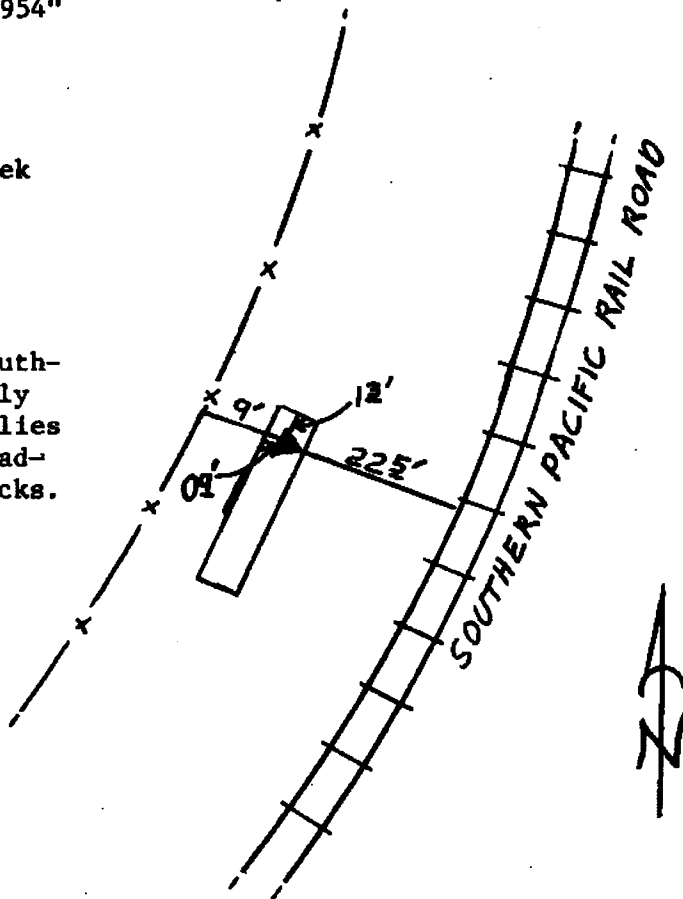

Reference Marks:

Note: For further information, contact the Douglas County Surveyor's Office, Room 205 Douglas County Justice Building, Roseburg, OR 97470. Phone 440-4278. Douglas County residents outside the Roseburg calling area, dial toll free 1-800-452-0991.