

OFFICE OF THE
DOUGLAS COUNTY SURVEYOR

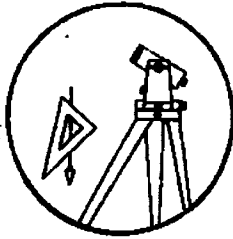

Station: G-476 T 26 S, R 3 W, Sec 18
 Set By (Agency): USC&GS
 Date Set: 1941
 Recovered By LEM
 Date Recovered 5/80
 Recovered By _____
 Date Recovered _____
 Recovered By _____
 Date Recovered _____

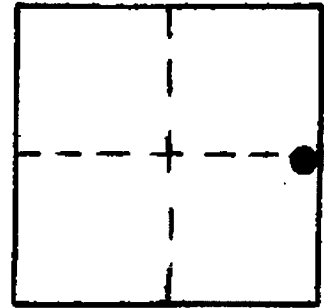

G 003

VERTICAL CONTROL NGVD 29 CORPSCOM 6 NAVD 88 714.913 FT
 Elevation: 711.340 NGS Line # 94 USGS Line # _____ OSHD Line # _____
 Precision: 1st Agency: USC&GS Proj. # _____ Date: 1961

HORIZONTAL CONTROL
 South Zone State Plane Coordinates: Y(Northing) _____ X(Easting) _____
 Precision: _____ Agency: _____ Proj. # _____ Date: _____
 Approximate Geographic Position: Latitude _____ Longitude _____

DESCRIPTION and TO REACH

Station is a standard USC&GS disk stamped "G 476 1941" located in the northeast corner of a 2'x2' concrete footing for a water tank (tank now gone). A witness post and sign bears S60°W 1 ft..

To Reach: From the intersection of Hwy 138 and Glide Loop Rd. (at the USFS Glide Ranger Station and Colliding Rivers Park), proceed northeasterly along Glide Loop Rd. approx. 1.1 mi. to the monument location on the right.

SKETCH

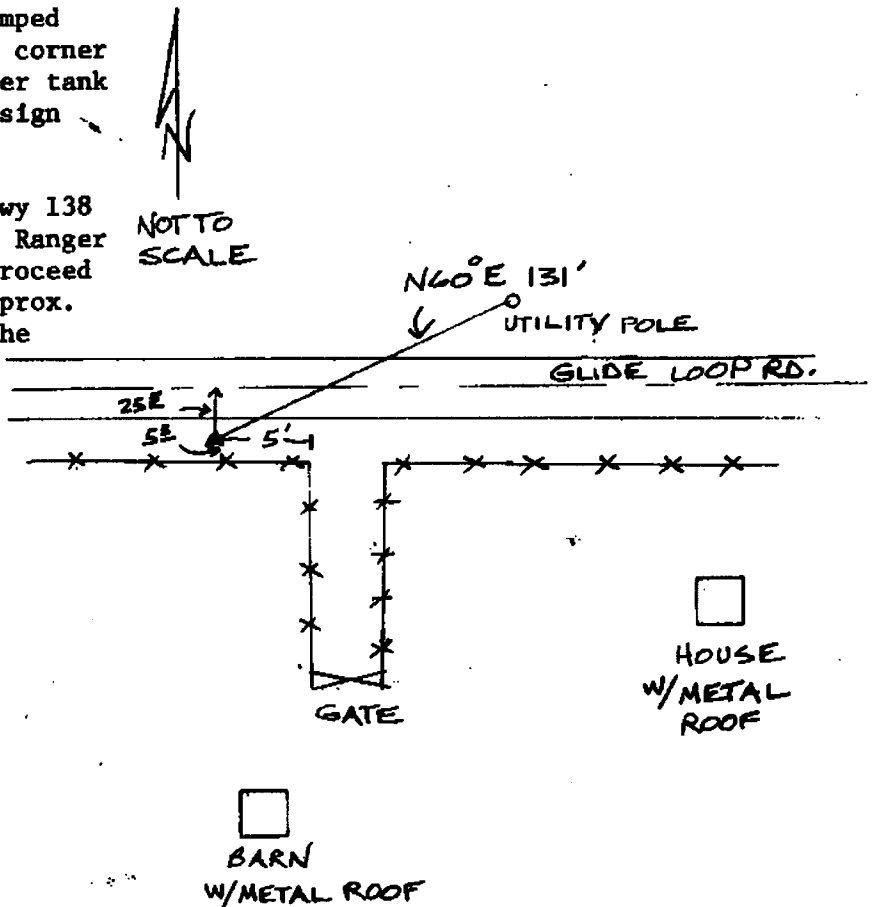

Reference Marks:

Note: For further information, contact the Douglas County Surveyor's Office, Room 205 Douglas County Justice Building, Roseburg, OR 97470. Phone 440-4278. Douglas County residents outside the Roseburg calling area, dial toll free 1-800-452-0991.