

OFFICE OF THE
DOUGLAS COUNTY SURVEYOR

Station: F554 T 28 S, R 6 W, Sec 28

Set By (Agency): USC&GS

Date Set: 1954

Recovered By R.S., S.J.F.

Date Recovered March 12, 1984

Recovered By _____

Date Recovered _____

Recovered By _____

Date Recovered _____

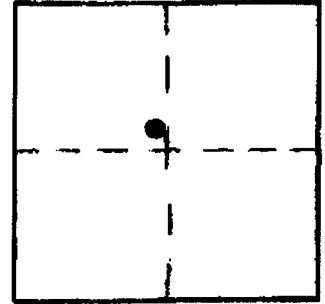

f-006
F 554

NAD 538361.35 4143219.68
83 43° 6'24" 123°24'51"

VERTICAL CONTROL NGVD 29 CORPSCON 6 NAVD 88 513.618 FT
Elevation: 510.170 NGS Line # 6 USGS Line # _____ OSHD Line # _____
Precision: 1st Agency: USC&GS Proj. # _____ Date: 1957

HORIZONTAL CONTROL OCS 27
South Zone State Plane Coordinates: Y(Northing) 538,396.50 X(Easting) 1,222,261.41
Precision: 1/25,000 Agency: DCSO Proj. # 2008-2013 Date: 1984
Approximate Geographic Position: Latitude 43°06'25" Longitude 123°24'47"

DESCRIPTION and TO REACH

A USC&GS disk stamped "F554 1954" set 2 1/2 feet below ground surface at the bottom of a 10 inch diameter steel tube. Tube set in a concrete headwall.

To Reach:

From the intersection of Highway 99 and Dillard Gardens Road (Co. Rd. #101) in T28S,R6W,Sec. 28, proceed easterly along Dillard Gardens Rd. approximately 0.35 miles to a paved road on the right (entrance to Hoover Treated Wood Products, formerly Permaneer Corp.). Proceed southerly along Hoover entrance road approximately 0.15 miles to monument on the right.

SKETCH

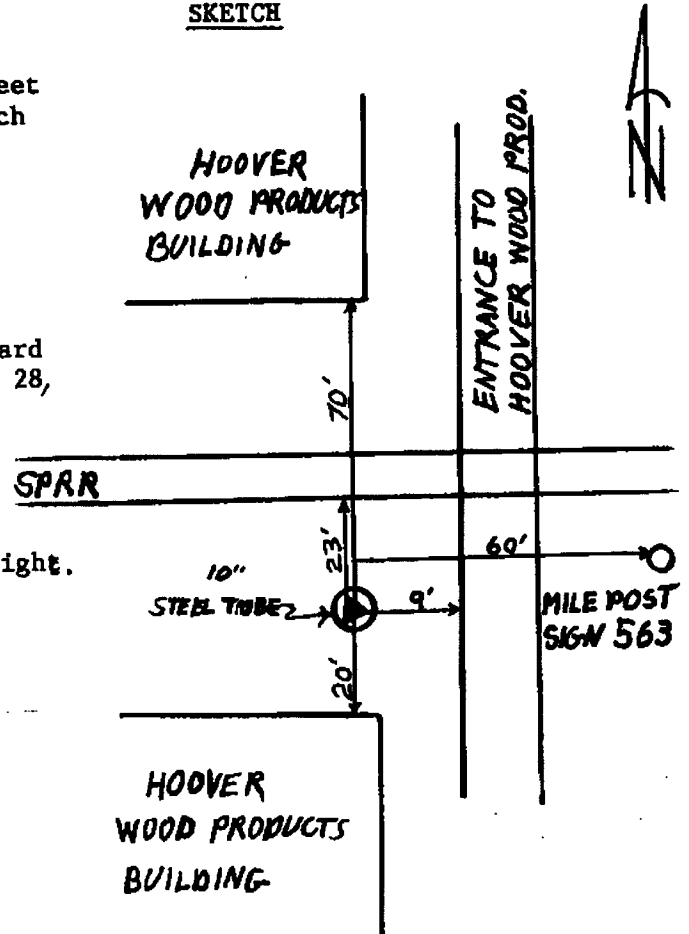

Reference Marks:

Note: For further information, contact the Douglas County Surveyor's Office, Room 205 Douglas County Justice Building, Roseburg, OR 97470. Phone 440-4278. Douglas County residents outside the Roseburg calling area, dial toll free 1-800-452-0991.