

OFFICE OF THE
DOUGLAS COUNTY SURVEYOR

Station: END

T 29 S, R 7 W , Sec 25

Set By (Agency): DCSO

Date Set: 1972

Recovered By RS, PB

Date Recovered 11/15/83

Recovered By DCSC 1/2001

Date Recovered _____

Recovered By _____

Date Recovered _____

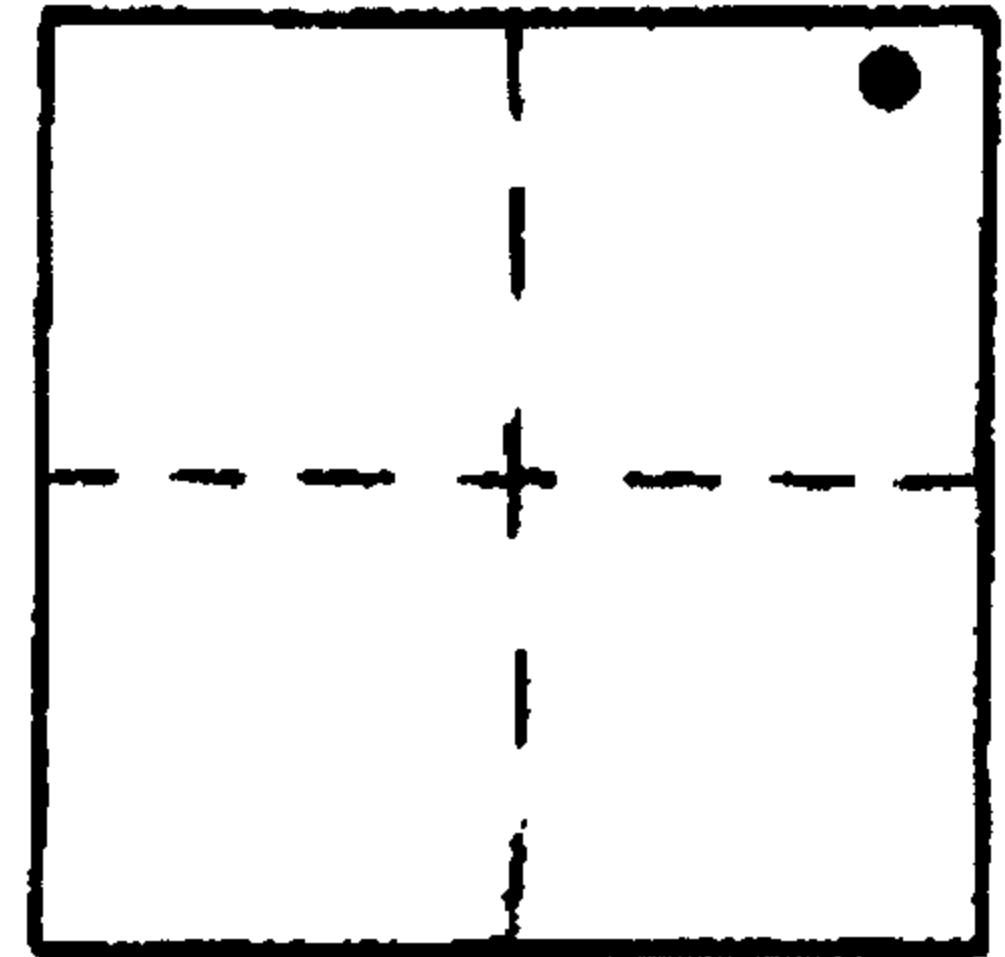

e-020
END 1973

29S 7W 25

NAD 509976.15 4128457.69
83 43° 1' 39" 123° 27' 57"

VERTICAL CONTROL NGVD 29 CORP CON 6 NAVD88 914.40 FT

Elevation: 910.90 NGS Line # _____ USGS Line # _____ OSHD Line # _____

Precision: 3rd Agency: DCSO Proj. # 66/55 Date: 2001

HORIZONTAL CONTROL OCS 27

South Zone State Plane Coordinates: Y(Northing) 510,011.26 X(Easting) 1,207,499.56

Precision: 1/25,000 Agency: DCSO Proj. # 2004 (CS 56/23) Date: 1973

Approximate Geographic Position: Latitude 43°01'39" Longitude 123°27'52"

DESCRIPTION and TO REACH

SKETCH

DESCRIPTION:

A DCSO disk stamped "END 1972" set in a concrete filled belltile flush with ground.

TO REACH:

From the intersection of Rice Creek Rd. (Co. Rd. #43) and Willis Creek Rd. (Co. Rd. #88) in T29S, R6W, Sec. 4; proceed southerly along Rice Creek Rd. 5.3 miles to end of County Road (end of pavement). Monument is 290 ft. southerly along gravel road on left.

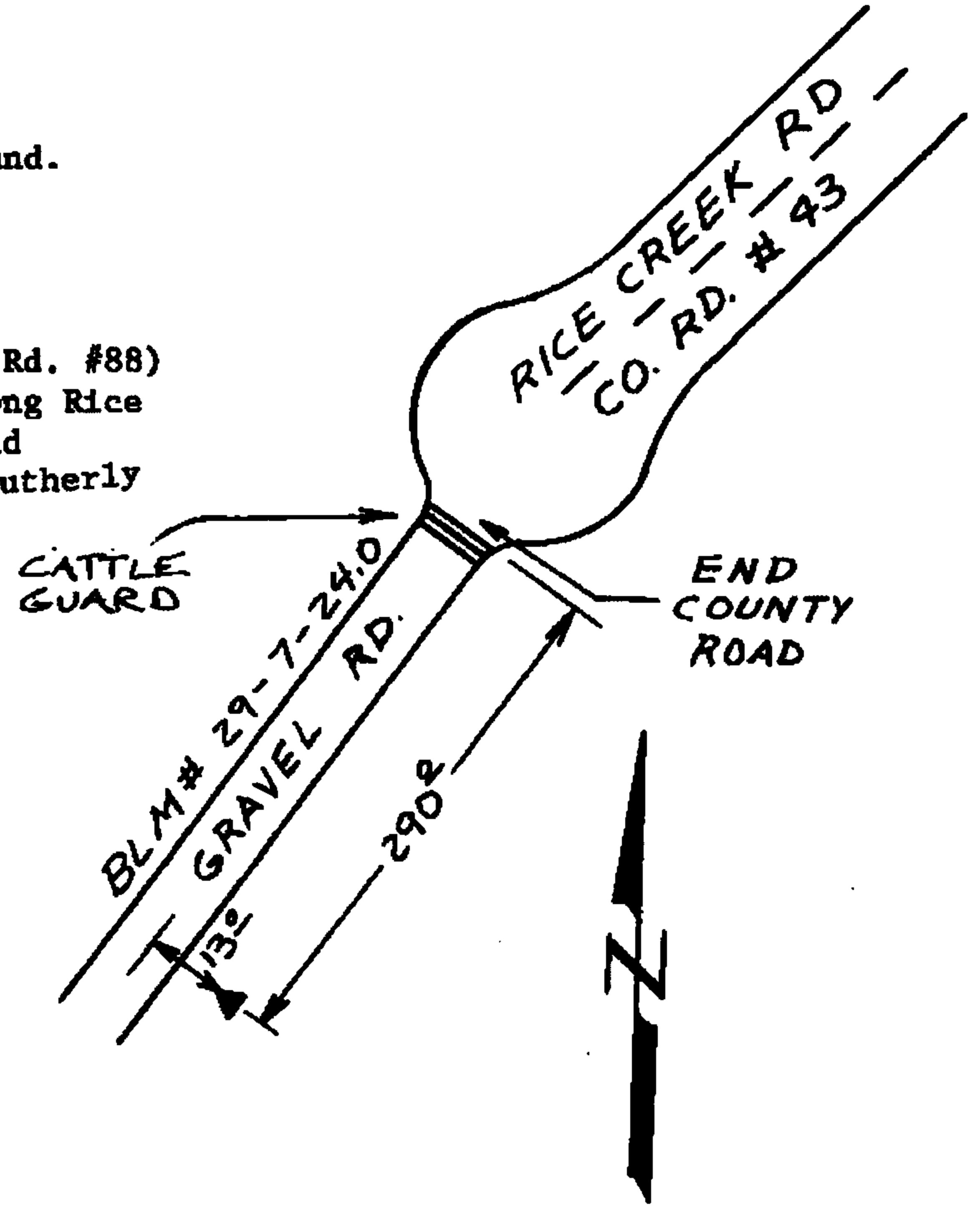

Reference Marks:

Note: For further information, contact the Douglas County Surveyor's Office, Room 205 Douglas County Justice Building, Roseburg, OR 97470. Phone 440-4278. Douglas County residents outside the Roseburg calling area, dial toll free 1-800-452-0991.