

DOUGLAS COUNTY SURVEYOR'S OFFICE

Designation: D-113 Station: D 247 32 T 225 R 09W S 18 ¼ SW

Date Set: 1919 Set by (Agency): USGS

Date Recovered: 6/23/10 Recovered by: SJF, WRB

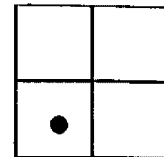

- Found
- New
- Reset
- Not Found
- Referenced
- Destroyed

VERTICAL CONTROL

NGVD 29 Elevation: 32.77 Feet File # _____
 Precision: 3rd Agency: _____ Project: _____ Date: _____

NAVD 88 Elevation: 11.073 Meters File # _____
 Precision: 1ST ORD. CLASS II Agency: NGS Project: _____ Date: _____

HORIZONTAL CONTROL - south zone

N _____ E _____ Datum/Adj.: NAD 83 Precision: GIS

Lat: 43° 39' 13.2" Long: 123° 49' 05.4" Agency: _____ File # _____ Date: _____

N _____ E _____ Datum/Adj.: _____ Precision: _____

Lat: _____ Long: _____ Agency: _____ File # _____ Date: _____

N _____ E _____ Datum/Adj.: _____ Precision: _____

Lat: _____ Long: _____ Agency: _____ File # _____ Date: _____

N _____ E _____ Datum/Adj.: _____ Precision: _____

Lat: _____ Long: _____ Agency: _____ File # _____ Date: _____

DESCRIPTION AND TO REACH

A 3 3/4 INCH DIAMETER USGS
DISK STAMPED
" 32 D 247 1919 BB "
SET IN CUT SHELF IN SOUTH
EDGE OF APPROX. 7x10x4 (ON
AVERAGE) FOOT TALL SAND-
STONE BOULDER, APPROXIMATELY
2 FT. ABOVE GROUND LEVEL.

GO TO THE INTERSECTION OF
MAIN ST AND TURNER ST
IN SCOTTSBURG MONUMENT
IS APPROX 100' SOUTHERLY
IN LARGE BOULDER.

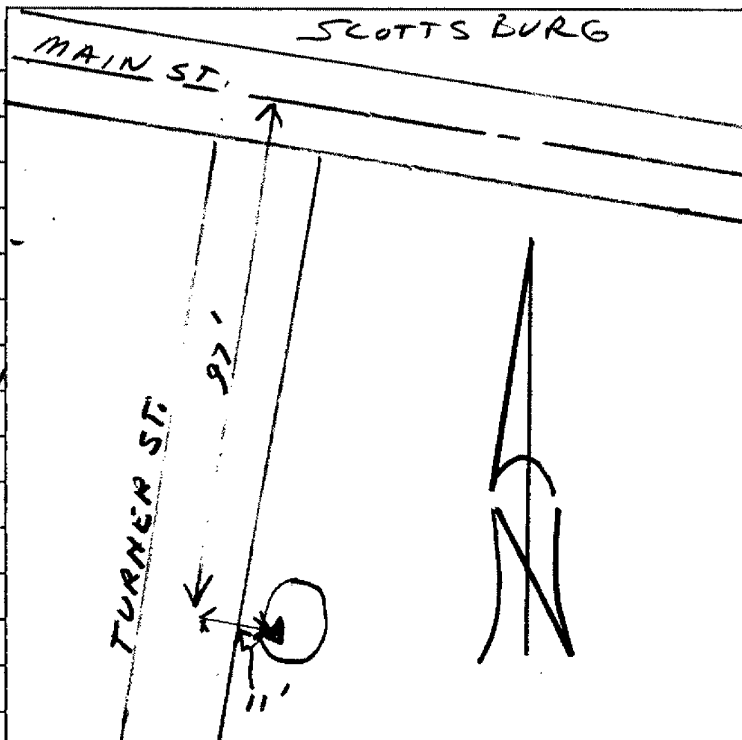

PHOTO FILE NAME

LOCATION

100-1395 OR 1396
(Renamed D-113 7/15/10)

GPS FILE

M062315A

PROCESSED BY: _____

DATE: _____



6.22.2010