

# Douglas County Geodetic Data Sheet

T 28 R 06 WS 33 C

Station: DILL-2

Designation: D-087

Date Set: 1998 Set By (Agency): DCSO

Last Date Recovered: 01/00/2001

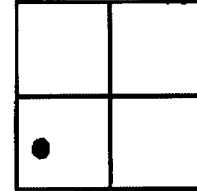

## VERTICAL CONTROL

NGVD 29 Elevation: 605.80 Feet

Precision: 3RD ORDER Agency: DCSO

CS File: 66055

Date: 1998

NAVD 88 Elevation: 609.26 <sup>FEET</sup> ~~Meters~~

Precision: CORPSON 6 Agency:

CS File:

Date:

## HORIZONTAL CONTROL

OCS 27 Y(Northing): X(Easting):

Lat 43° 05' 13.8" Long: 123° 25' 16.2"

Precision: GIS Agency:

CS File: Date:

OCS 83 Y(Northing): X(Easting):

Lat Long:

Precision: Agency:

CS File: Date:

OCS 83/91 Y(Northing): X(Easting):

Lat Long:

Precision: Agency:

CS File: Date:

OCS 83/98 Y(Northing): X(Easting):

Lat Long:

Precision: Agency:

CS File: Date:

### Description:

Scaled Lat 43° 05' 14" Long: 123° 25' 16"

A DCSO DRILL CAP STAMPED; DILL-2 1998; SET FLUSH IN TOP OF AN 8 X 42 INCH CONCRETE FILLED CONCRETE BELL TILE; PROTRUDES 5 IN. ABOVE GROUND.

### Comments:

FROM THE INTERSECTION OF BROCKWAY ROAD; CO. RD 47F; AND WILLIS CREEK RD; CO. RD 43; IN T28S R6W SEC.32; PROCEED SOUTHERLY ALONG WILLIS CREEK RD APPROX. 0.90 MILES TO MONUMENT ON RIGHT. MONUMENT IS BETWEEN A DRIVEWAY AND COUNTY RD NEAR TOP OF 3 FT TALL CUTBANK.

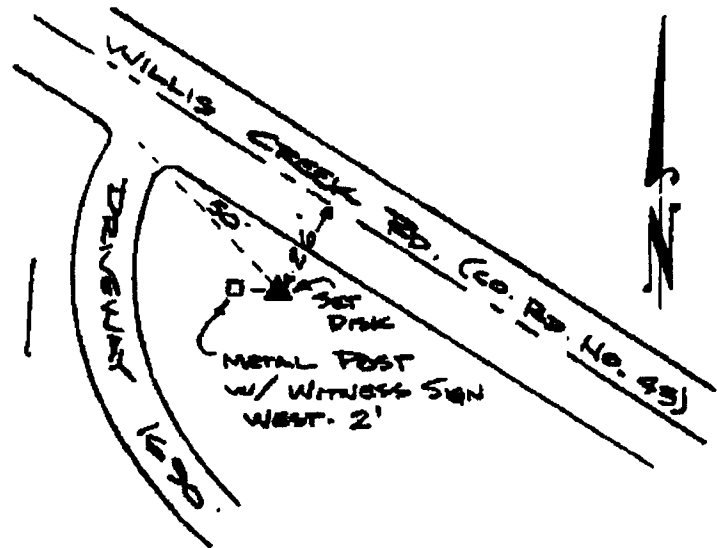

### Notes:

Note: For further information contact the Douglas County Surveyors Office, Room 105A Douglas County Courthouse, Roseburg, OR 97470. Phone 440-4272 or Fax (541)957-8150. Douglas County Residents outside Roseburg calling area, dial toll free 1-800-224-1619.