

# Douglas County Geodetic Data Sheet

T 26 R 06 WS 27

Station: DILBECK

Designation: D-085

Date Set: 1998 Set By (Agency): DCSO

Last Date Recovered: 09/02/1998

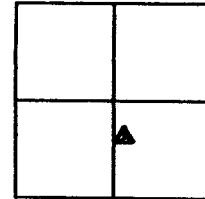

## VERTICAL CONTROL

NGVD 29 Elevation: 413.40 Feet

Precision: 3RD ORDER Agency: DCSO

CS File: 66027

Date: 1998

NAVD 88 Elevation: 416.86 FT.

Precision: CORPSCON6 Agency: NAVD88

CS File:

Date:

## HORIZONTAL CONTROL

OCS 27 Y(Northing): 53000 X(Easting): 41500 Lat

Long:

Precision: GIS Agency: CS File:

Date:

OCS 83 Y(Northing): 599900 X(Easting): 4150573 Lat

Long:

Precision: GIS SCALED Agency: DCSO CS File:

Date: 2014

OCS 83/91 Y(Northing): X(Easting): Lat

Long:

Precision: Agency: CS File:

Date:

OCS 83/98 Y(Northing): X(Easting): Lat

Long:

Precision: Agency: CS File:

Date:

Scaled Lat 43° 16' 35" Long: 123° 23' 36"

## Description:

A 2 INCH DIA. BRASS CAP STAMPED; DILBECK 1998; SET IN TOP OF CONCRETE STORM DRAIN GRATE

## Comments:

FROM THE INTERSECTION OF GARDEN VALLEY ROAD; CO. RD 6; AND FISHER ROAD; CO. RD 189; IN T26S R6W SEC. 34; PROCEED NORTHEASTERLY ALONG FISHER ROAD 1.1 MILES TO MONUMENT ON LEFT.

*4/5/03 per Carl Swickard  
brass cap below monument  
broken around cap*

## Notes:

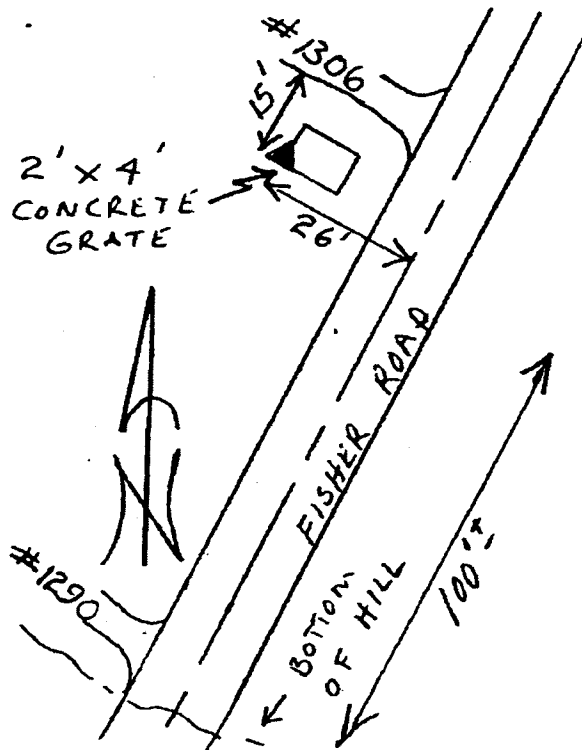

Note: For further information contact the Douglas County Surveyors Office, Room 105A Douglas County Courthouse, Roseburg, OR 97470. Phone 440-4272 or Fax (541)957-8150. Douglas County Residents outside Roseburg calling area, dial toll free 1-800-224-1619.