

OFFICE OF THE
DOUGLAS COUNTY SURVEYOR

Station: D 741X
 Date Set: 1987
 Set By (Agency): NGS
 DCSO Designation: D-080
 Date Recovered: 8-93 ; 1998
 Recovered By: RWS SJF
 Date Recovered: _____
 Recovered By: _____
 Date Recovered: _____
 Recovered By: _____

T28W R7W Sec. 27

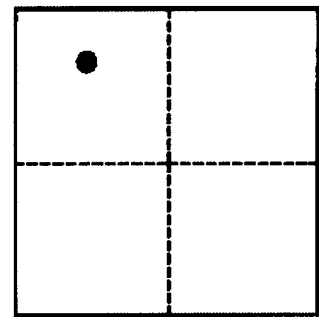
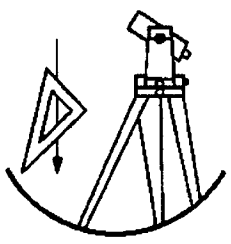

VERTICAL CONTROL

NGVD 29 Elevation: 633.03 ^{DCSO CSW/49} 3rd Order FEET NAVD 88 Elevation: 636.499 FT 194.005 METERS

NGS Line # 125034 USGS LINE # _____ OSHD Line # _____ FILE # _____

Precision: 1ST ORDER Agency: NGS Proj: _____ Date: 1988
SEE NGS WEBSITE FOR 88 ELEVATION

HORIZONTAL CONTROL

O.C.S. 27 Y(Northing): _____ O.C.S. 83 Y(Northing): _____

(South Zone) X(Easting): _____ (South Zone) X(Easting): _____

Precision: _____ Agency: _____ Proj: _____ Date: _____

Approx. O.C.S. 27 Geographic Position: Latitude: 43°06'40" Longitude: 123°30'52"

Approx. O.C.S. 83 Geographic Position: Latitude: _____ Longitude: _____

Found: A 9/16 inch diameter stainless steel rod set under a 6 - 5/8 inch diameter aluminum collar with access cover, set in concrete flush with ground. Collar stamped "D 741X 1987".

To reach: Go the intersection of State Hwy 42 and Strickland Canyon Rd. (Co. Rd. #108) in T28S R7W Sec27, monument is southeasterly of intersection.

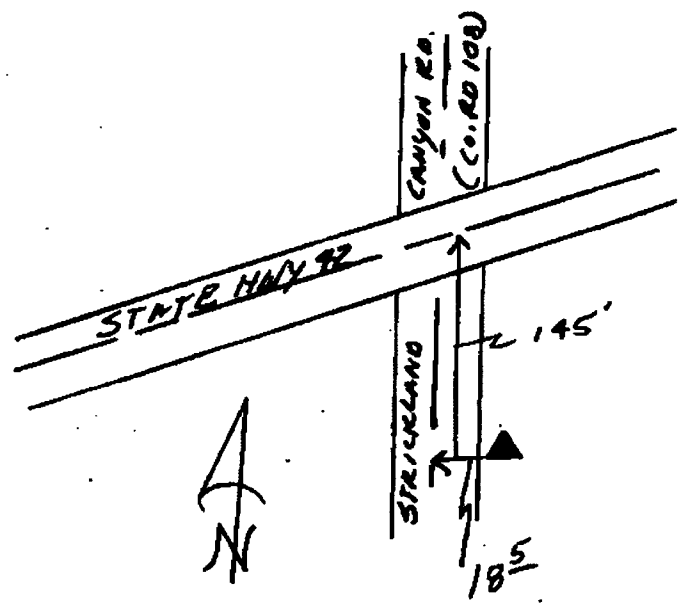

Note: For further information contact the Douglas County Surveyors Office, Room 205 Douglas County Justice Building, Roseburg, OR 97470. Phone 440-4272. Douglas County Residents outside Roseburg calling area, dial toll free 1-800-477-0991.