

OFFICE OF THE  
DOUGLAS COUNTY SURVEYOR

Station: D 743

T30W R9W Sec. 17

Date Set: 1987

Set By (Agency): NGS

DCSO Designation: D-079

Date Recovered: 8-93

Recovered By: RWS SJF

Date Recovered: \_\_\_\_\_

Recovered By: \_\_\_\_\_

Date Recovered: \_\_\_\_\_

Recovered By: \_\_\_\_\_

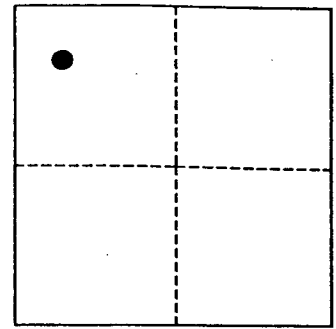
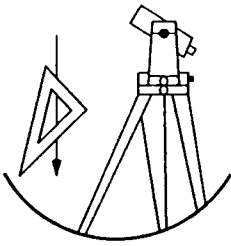

VERTICAL CONTROL

~~NAVD 88~~  
~~NAVD 29~~ Elevation: 565.696 FEET      NAVD 88 Elevation: 172.424 METERS

NGS Line # 125034      USGS LINE # \_\_\_\_\_      OSHD Line # \_\_\_\_\_      FILE # \_\_\_\_\_

Precision: 1ST ORDER      Agency: NGS      Proj: \_\_\_\_\_      Date: 1988

HORIZONTAL CONTROL

~~O.C.S. 27~~ Y(Northing): \_\_\_\_\_      O.C.S. 83 Y(Northing): 490125

(South Zone) X(Easting): \_\_\_\_\_      (South Zone) X(Easting): 4039040

Precision: GIS SCALED      Agency: DCSO      Proj: \_\_\_\_\_      Date: 2014

Approx. O.C.S. 27 Geographic Position:      Latitude: 42°57'52"      Longitude: 123°47'36"

Approx. O.C.S. 83 Geographic Position:      Latitude: \_\_\_\_\_      Longitude: \_\_\_\_\_

Found: A 9/16 inch diameter stainless steel rod under a 6 - 5/8 inch diameter aluminum collar and access cover, collar stamped "D 743 1987" set flush with ground.

To reach: Go to the intersection of State Hwy 42 and Slater Creek Rd. in T30S R9W Sec17 monument is at mile point 46.35

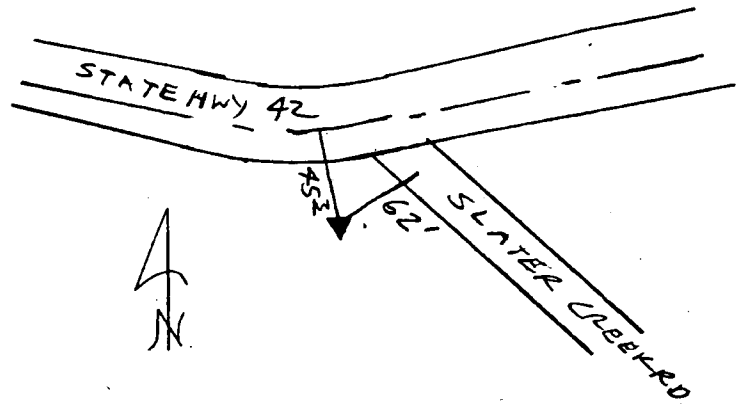

Note: For further information contact the Douglas County Surveyors Office, Room 205 Douglas County Justice Building, Roseburg, OR 97470. Phone 440-4272. Douglas County Residents outside Roseburg calling area, dial toll free 1-800-477-0991.