

OFFICE OF THE
DOUGLAS COUNTY SURVEYOR

Station: D-101
Date Set: 1992
Set By (Agency): LS #1076
DCSD Designation: D-078
Date Recovered: 1-20-93
Recovered By: RWS SJF
Date Recovered: _____
Recovered By: _____
Date Recovered: _____
Recovered By: _____

T 23 S, R 8 W, Sec 12

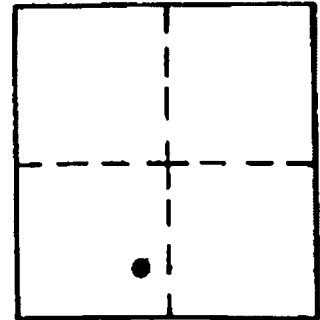
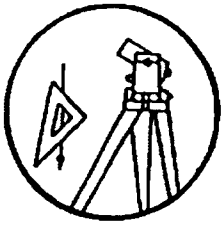

VERTICAL CONTROL CORPSCON 6 NAVD 88 161.03 FT

Elevation: 157.46 NGS Line # _____ USGS Line # _____ OSHD Line # _____
Precision: 3rd Order Agency: LS 1076 Proj. # MLP#1992-0088 Date: 1992

HORIZONTAL CONTROL

O.C.S. 27 Y(Northing): _____ D.C.S. 83 Y(Northing): _____
South Zone X(Easting): _____ South Zone X(Easting): _____
Precision: _____ Agency: _____ Proj. # _____ Date: _____
Approx. NAD 83 Geographic Position: Latitude _____ Longitude _____

Found: A 2 3/4" dia. disk etched "D-101
LS 1076" set in a 1 ft. dia. concrete
mon. set flush with the ground.

To reach: At the intersection of Joe
Hooker Rd. (Co.Rd.#67) and Mehl Creek
Rd. (Co.Rd.#11) in T22S R8W sec. 35,
proceed southerly along Mehl Creek Rd.
2.45 mi. to mon. on the left.

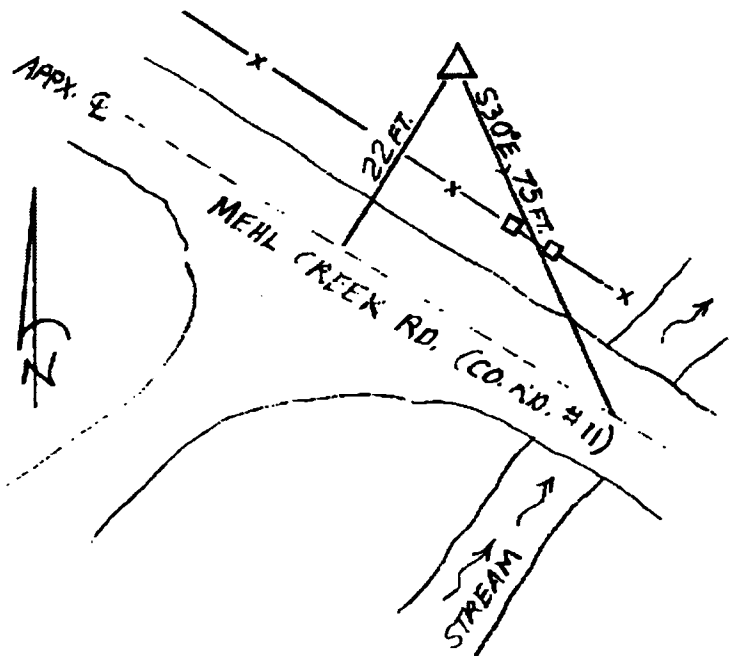

Note: For possible further information contact the Douglas County Surveyors Office,
Room 205 Douglas County Justice Building, Roseburg, OR 97470. Phone 440-4272.
Douglas County residents outside the Roseburg calling area, dial toll free
1-800-477-0991.