

OFFICE OF THE  
DOUGLAS COUNTY SURVEYOR

Station: DUMP  
Set By (Agency): DCSO  
Date Set: 1989  
Recovered By RWS,SJF  
Date Recovered 5/19/89  
Recovered By \_\_\_\_\_  
Date Recovered \_\_\_\_\_  
Recovered By \_\_\_\_\_  
Date Recovered \_\_\_\_\_

T 27 S, R 7 W , Sec 26

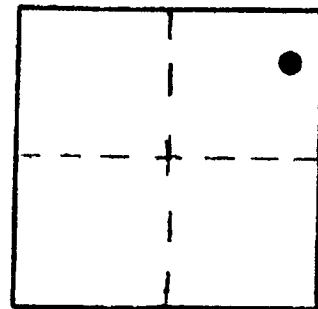
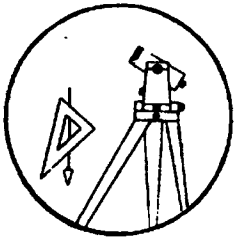

D 076

VERTICAL CONTROL NGVD 29 CORPSCON 6 NAVD 88 845.758 FT

Elevation: 842.279 NGS Line # \_\_\_\_\_ USGS Line # \_\_\_\_\_ OSHD Line # \_\_\_\_\_

Precision: 2nd Agency: DCSO Proj. # 2007 Date: 1990

HORIZONTAL CONTROL

South Zone State Plane Coordinates: Y(Northing) \_\_\_\_\_ X(Easting) \_\_\_\_\_

Precision: \_\_\_\_\_ Agency: \_\_\_\_\_ Proj. # \_\_\_\_\_ Date: \_\_\_\_\_

Approximate Geographic Position: Latitude \_\_\_\_\_ Longitude \_\_\_\_\_

DESCRIPTION and TO REACH

SKETCH

A DCSO disk stamped "DUMP 1989" set in an 8 in. dia. by 42 in. long concrete filled belltile, protruding 1 in. above ground.

Go to the intersection of Colonial Rd. (Co.Rd.#52) and Lookingglass Transfer Rd. (Co.Rd.#317) in T27S,R7W,Sec.26, monument is northwest of intersection.

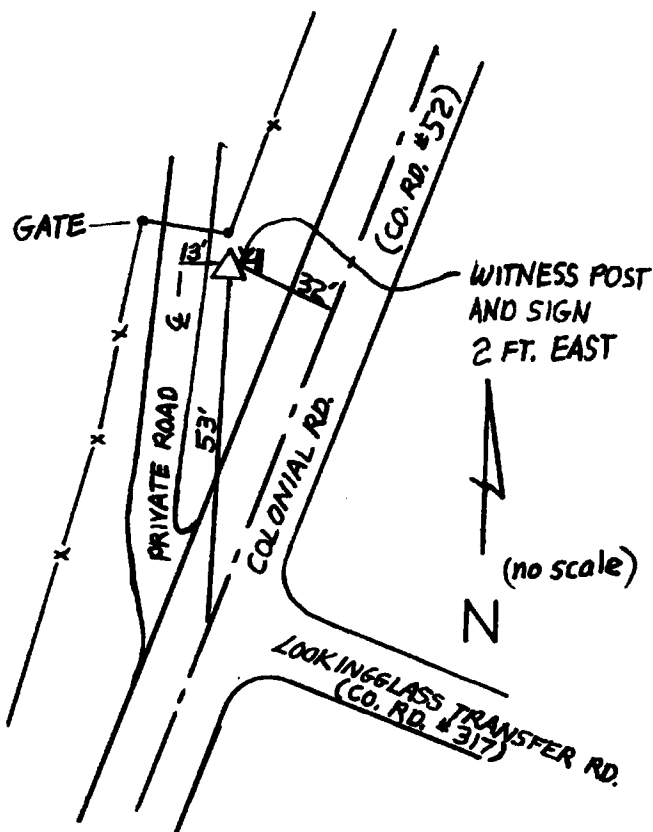

Reference Marks:

Note: For further information, contact the Douglas County Surveyor's Office, Room 205 Douglas County Justice Building, Roseburg, OR 97470. Phone 440-4278. Douglas County residents outside the Roseburg calling area, dial toll free 1-800-452-0991.