

OFFICE OF THE
DOUGLAS COUNTY SURVEYOR

Station: DANNA RESET
 Set By (Agency): DCSO
 Date Set: 1990
 Recovered By RWS, SJF
 Date Recovered 8/2/90
 Recovered By O.D.O.T.
 Date Recovered 9-10-98
 Recovered By _____
 Date Recovered _____

UNS
T 26 S, R 5 E , Sec 36

D-072
DANNA RESET
265 SE 36

NAD 83 584398.67 4476036.17
43°15'29" 122°10'18"

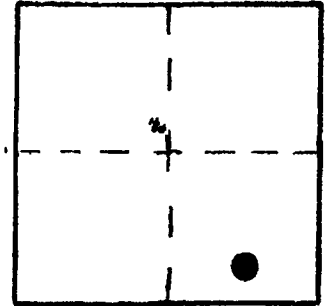

VERTICAL CONTROL NGVD 29 CORPSCON 6 NAVD88 4511.04 FT
 Elevation: 4506.868 NGS Line # _____ USGS Line # _____ OSHD Line # _____
 Precision: 2nd Agency: DCSO Proj. # 2013 Date: 1990

HORIZONTAL CONTROL OCS 27
 South Zone State Plane Coordinates: Y(Northing) 584,436.25 X(Easting) 1,555,074.48
 Precision: 1/25,000 Agency: DCSO Proj. # 2013 Date: 1990
 Approximate Geographic Position: Latitude 43°15'29" Longitude 122°10'13"

DESCRIPTION and TO REACH

SKETCH

A DCSO disk stamped "DANNA RESET 1990" is set in an 8 in. dia. by 42 in. long concrete filled belltile, which protrudes 3 in. above ground.

From the intersection of Lemola Rd. (U.F.S. RD. #2610) and State Hwy. #138, proceed easterly along State Hwy #138 0.15 miles to monument on right.

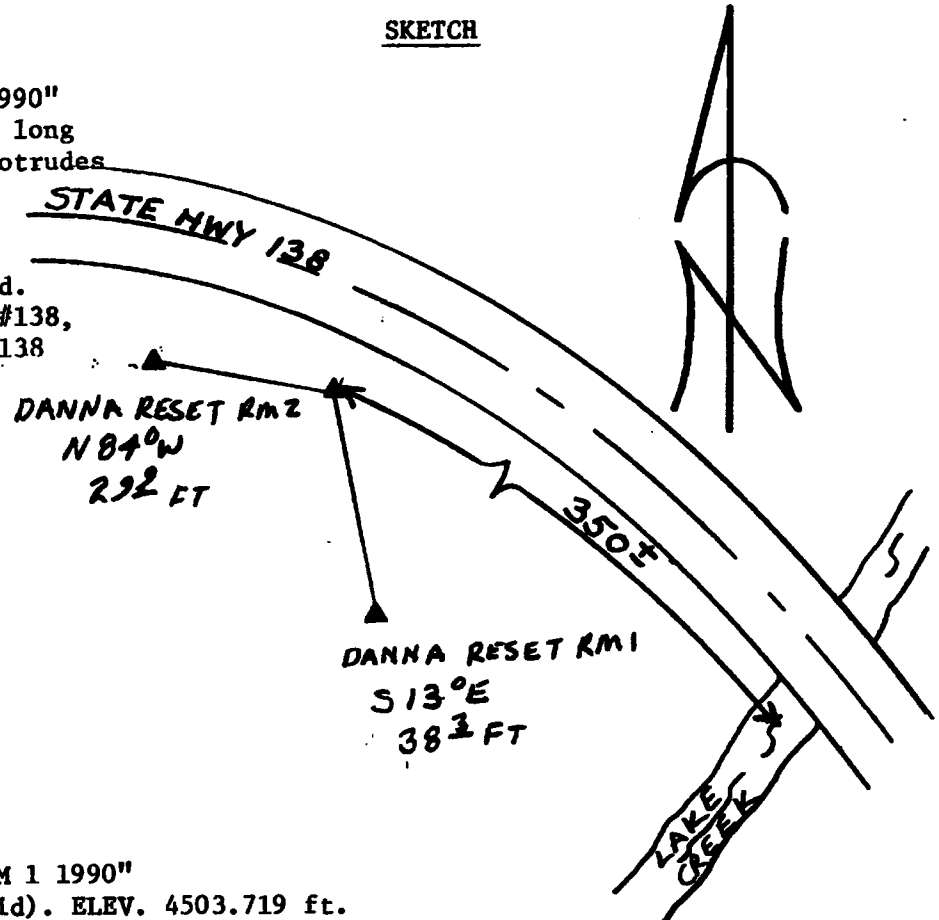

Reference Marks:

A DCSO disk stamped "DANNA RESET RM 1 1990" bears S 11°59'53" E, 38.30 ft. (grid). ELEV. 4503.719 ft.

A DCSO disk stamped "DANNA RESET RM 2 1990" bears N 83°04'43" W, 29.89 ft. (grid). ELEV. 4506.912 ft.

Note: For further information, contact the Douglas County Surveyor's Office, Room 205 Douglas County Justice Building, Roseburg, OR 97470. Phone 440-4278. Douglas County residents outside the Roseburg calling area, dial toll free 1-800-452-0991.