

OFFICE OF THE
DOUGLAS COUNTY SURVEYOR

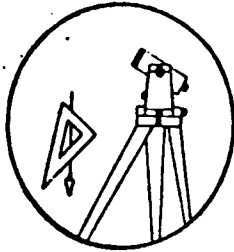

D-062

Station: DRIVER T 27 S, R 6 W, Sec 24
 Set By (Agency): BHW
 Date Set: 1979
 Recovered By RS, JP
 Date Recovered 8/30/83
 Recovered By RWS-STF
 Date Recovered 2000
 Recovered By _____
 Date Recovered _____

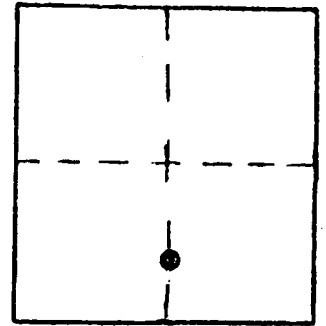

VERTICAL CONTROL 452.67
 Elevation: 452.62 NGS Line # _____ USGS Line # _____ OSHD Line # _____
 Precision: 3rd Agency: BHW Proj. # MLP-M81-31 Date: 1979
HORIZONTAL CONTROL CORPSCON6 NAVD88 DCSO 456.14 FT CS 66/38 2000
 South Zone State Plane Coordinates: Y(Northing) 572786 X(Easting) 4159565
 Precision: GIS SCALED Agency: DCSO Proj. # _____ Date: 2014
 Approximate Geographic Position: Latitude _____ Longitude _____

DESCRIPTION and TO REACH

SKETCH

DESCRIPTION:

A disk stamped "DRIVER-1979 LS 1005 ELEV. 452.62"
 set in a 8 in. diam. concrete monument 6 in.
 above ground.

TO REACH:

From intersection of SW Portland Ave. and
 SW Kendall St. in T27S, R6W, Sec.25 proceed
 northerly along SW Kendall St. 0.25 miles
 to monument on right, AT residence 1525
 SW Kendall St.

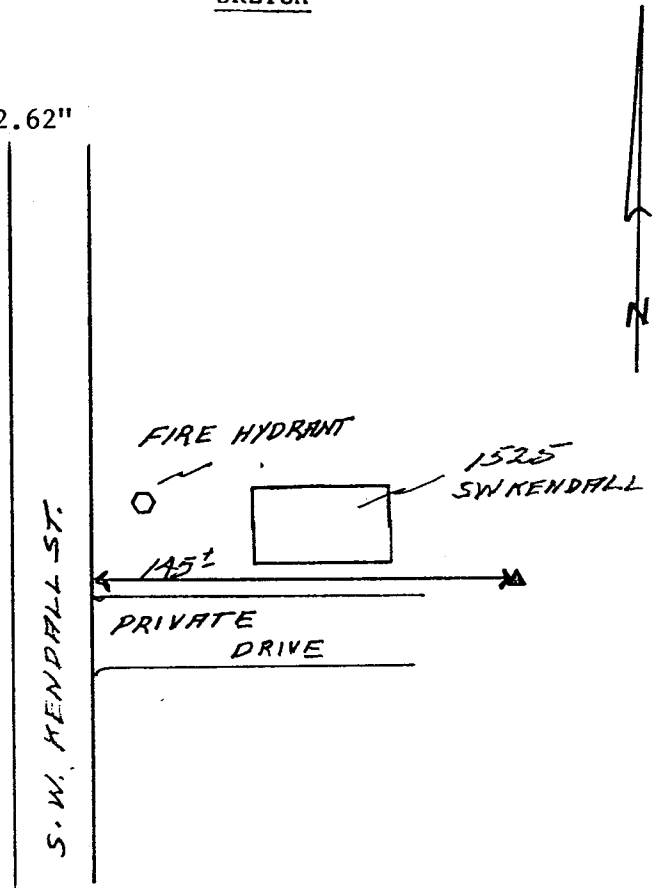

Reference Marks:

Note: For further information, contact the Douglas County Surveyor's Office, Room 205
 Douglas County Justice Building, Roseburg, OR 97470. Phone 440-4278. Douglas
 County resident? side the Roseburg calling area dial toll free 1-800-452-0001