

OFFICE OF THE
DOUGLAS COUNTY SURVEYOR

Station: DODSON RM 4 T 28 S, R 5 W, Sec 24
 Set By (Agency): DCSO
 Date Set: 1971
 Recovered By RS, SF
 Date Recovered 3/15/84
 Recovered By _____
 Date Recovered _____
 Recovered By _____
 Date Recovered _____

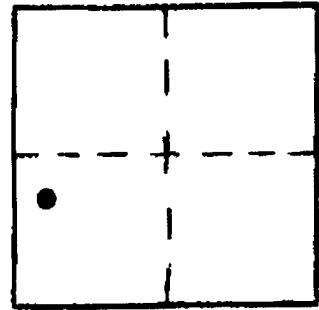

d-051
DODSON RM 4

28S 5W 24

NAD 541320.99 4188825.17
 83 43° 7' 9" 123°14'38"

VERTICAL CONTROL **NGVD 29 CORPSCON 6 NAVD88 3232 FT**

Elevation: 3228 NGS Line # _____ USGS Line # _____ OSHD Line # _____
 Precision: V.A. Agency: DCSO Proj. # 2002 Date: 1971

HORIZONTAL CONTROL **OCS 27**

South Zone State Plane Coordinates: Y(Northing) 541,356.36 X(Easting) 1,267,867.00
 Precision: 1/100,000 Agency: DCSO Proj. # 2002 Date: 1971
 Approximate Geographic Position: Latitude 43°07'09" Longitude 123°14'34"

DESCRIPTION and TO REACH

SKETCH

DESCRIPTION:

A DCSO disk stamped "DODSON RM4 1971"
set flush on top of a rock outcrop.

TO REACH:

From the intersection of Co. Rd. #16 (Dixonville Rd.) and Co. Rd. #105 (Clarks Branch Rd.) in T28S, R5W, Sec.16 proceed easterly along Co. Rd. #16, 0.4 mi. to a private road on right, proceed southeasterly along private road 4.3 mi. to a "Y" intersection, proceed northwesterly along left fork 0.65 mi. to top of Dodson Butte and monument.

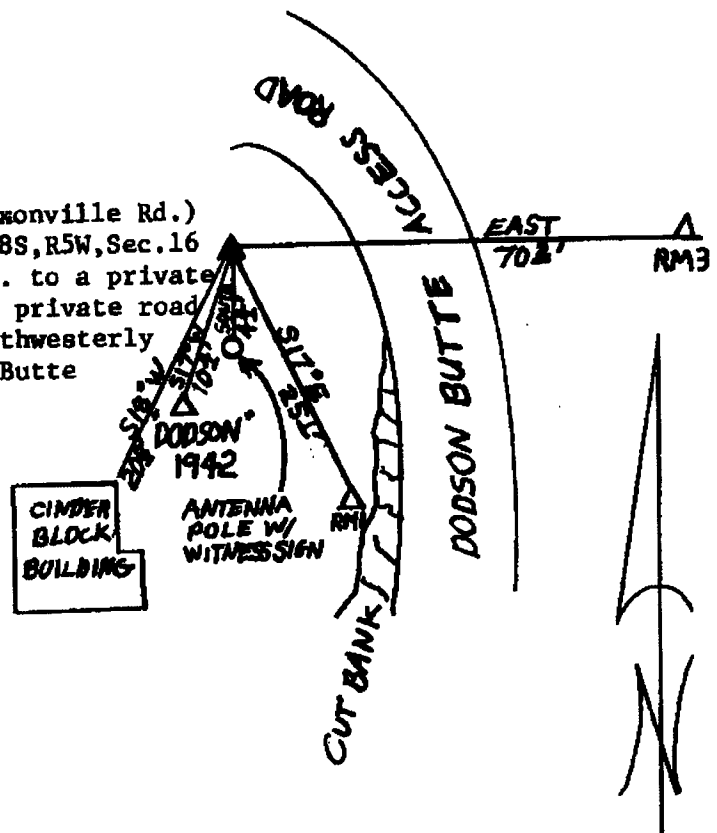

Reference Marks:

- A USC&GS disk stamped "DODSON 1942" bears S 19°08'14" W, 10.43 ft. (grid).
- A USC&GS disk stamped "DODSON NO1 1942" bears S 14°29'55" E, 25.12 ft. (grid).
- A USC&GS disk stamped "DODSON 1942 NO3 1970" bears S 89°43'08" E, 70.23 ft. (grid).

Note: For further information, contact the Douglas County Surveyor's Office, Room 205 Douglas County Justice Building, Roseburg, OR 97470. Phone 440-4278. Douglas County residents outside the Roseburg calling area, dial toll free 1-800-452-0991.