

OFFICE OF THE
DOUGLAS COUNTY SURVEYOR

Station: DENFRE T 27 S, R 5W , Sec 18

Set By (Agency): CITY (RSBG.)

Date Set: ?

Recovered By KR, TP

Date Recovered 5/82

Recovered By _____

Date Recovered _____

Recovered By _____

Date Recovered _____

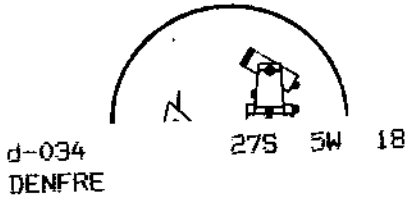
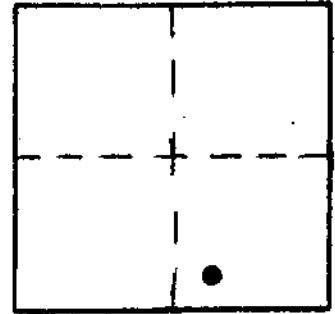

NAD 577540.85 4165899.03
83 43°12'59" 123°20' 4"

VERTICAL CONTROL

Elevation: _____ NGS Line # _____ USGS Line # _____ OSHD Line # _____

Precision: _____ Agency: _____ Proj. # _____ Date: _____

HORIZONTAL CONTROL **NAD 27**

South Zone State Plane Coordinates: Y(Northing) 577,576.07 X(Easting) 1,244,940.73

Precision: 1/20,000 Agency: DCSO Proj. # 2005-2 Date: 1983

Approximate Geographic Position: Latitude 43°12'59" Longitude 123°19'59"

DESCRIPTION and TO REACH

SKETCH

DESCRIPTION:

A brass cap street monument set
below pavement (uncovered)

TO REACH:

Go to the intersection of NE Denver St.
and NE Freemont Ave.

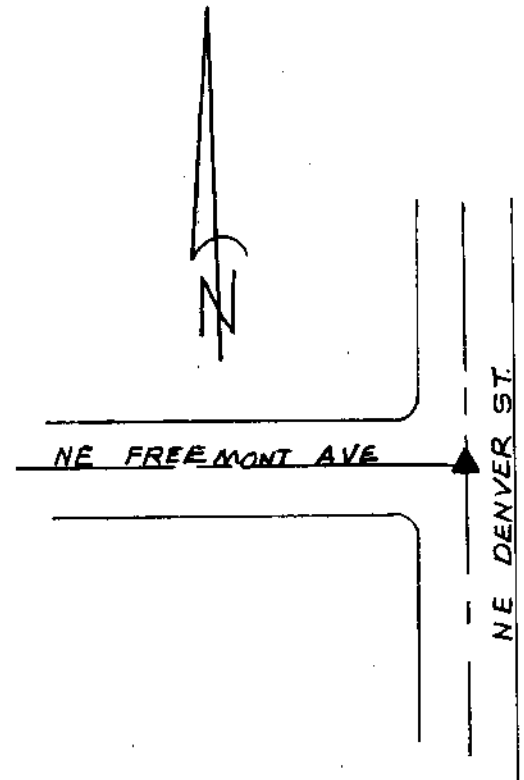

Reference Marks:

Note: For further information, contact the Douglas County Surveyor's Office, Room 205 Douglas County Justice Building, Roseburg, OR 97470. Phone 440-4278. Douglas County residents outside the Roseburg calling area, dial toll free 1-800-452-0991.