

OFFICE OF THE  
DOUGLAS COUNTY SURVEYOR

Station: DD 102  
Set By (Agency): USC&GS  
Date Set: 1934  
Recovered By RWS, SJF  
Date Recovered 1987  
Recovered By \_\_\_\_\_  
Date Recovered \_\_\_\_\_  
Recovered By \_\_\_\_\_  
Date Recovered \_\_\_\_\_

T 22 S, R 5 W, Sec 28

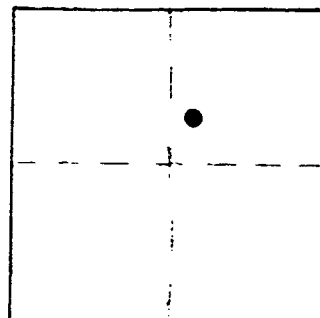

D-023  
DD 102

22S 5W 28

NAD 728147.40 4180970.7  
83 43°37'50" 123°17'48"

VERTICAL CONTROL CORPSCON 6 NAVD 88 334.883 FT

Elevation: 331.299 NGS Line # 6 USGS Line # \_\_\_\_\_ OSHD Line # \_\_\_\_\_

Precision: 1st. Agency: USC&GS Proj. # \_\_\_\_\_ Date: 1957

HORIZONTAL CONTROL

South Zone State Plane Coordinates: Y(Northing) 728,182.20 X(Easting) 1,260,010.23

Precision: 1/15,000 Agency: DCSO Proj. # 2008 Date: 1979

Approximate Geographic Position: Latitude 43°37'51" Longitude 123°17'44"

DESCRIPTION and TO REACH

SKETCH

A USC&GS disk stamped "331 DD102 1934"  
set flush in headwall of concrete box culvert.

From the intersection of First Street  
and Old State Highway 99 (Co. Rd. #389) in  
T23S,R5W,Section 3 proceed northerly along  
Old State Highway 99 approximately 2.2 miles  
to monument on left.

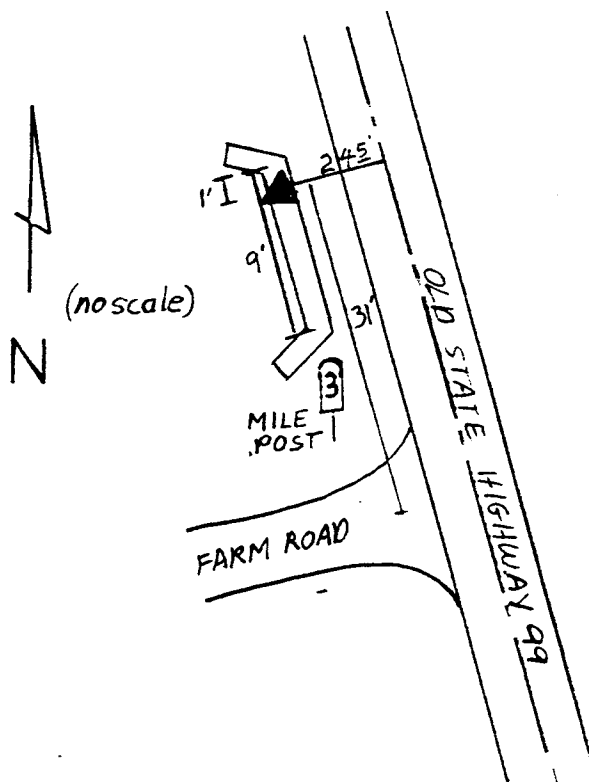

Reference Marks:

Note: For further information, contact the Douglas County Surveyor's Office, Room 205  
Douglas County Justice Building, Roseburg, OR 97470. Phone 440-4278. Douglas  
County residents outside the Roseburg calling area, dial toll free 1-800-452-0991.