

OFFICE OF THE
DOUGLAS COUNTY SURVEYOR

Station: DARRELL

T 28 S, R 6 W , Sec 21

Set By (Agency): Don Garrett

L.S. #0544

Date Set: 1972

Recovered By RS, SJF

Date Recovered April 6, 1984

Recovered By _____

Date Recovered _____

Recovered By _____

Date Recovered _____

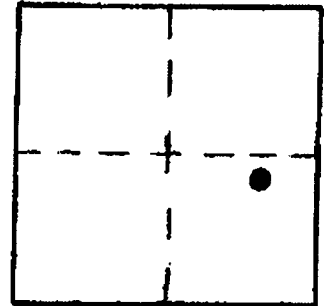

d-018
DARRELL

28S 6W 21

NAD 542733.65 4144872.44
83 43° 7' 8" 123°24'31"

VERTICAL CONTROL NGVD 29 CORPSCOM 6 NAVD88 543.03 FT

Elevation: 539.59 NGS Line # _____ USGS Line # _____ OSHD Line # _____

Precision: 3 rd. Agency: Don Bentz Proj. # _____ Date: 1972

L.S. #0839

HORIZONTAL CONTROL OCS 27

South Zone State Plane Coordinates: Y(Northing) 542,768.80 X(Easting) 1,223,914.15

Precision: 1/25,000 Agency: DCSO Proj. # 2005 C.S. 56/9 Date: 1972

Approximate Geographic Position: Latitude 43°07'09" Longitude 123°24'27"

DESCRIPTION and TO REACH

SKETCH

A DCSO disk stamped "DARRELL 1972" set on an iron pipe. Monument is set flush with ground.

TO REACH:

From the intersection of Darrell Street and Carter Street in Winston (T28S, R6W, Sec. 21) proceed northerly along Darrell Street approximately 0.1 miles to monument on right.

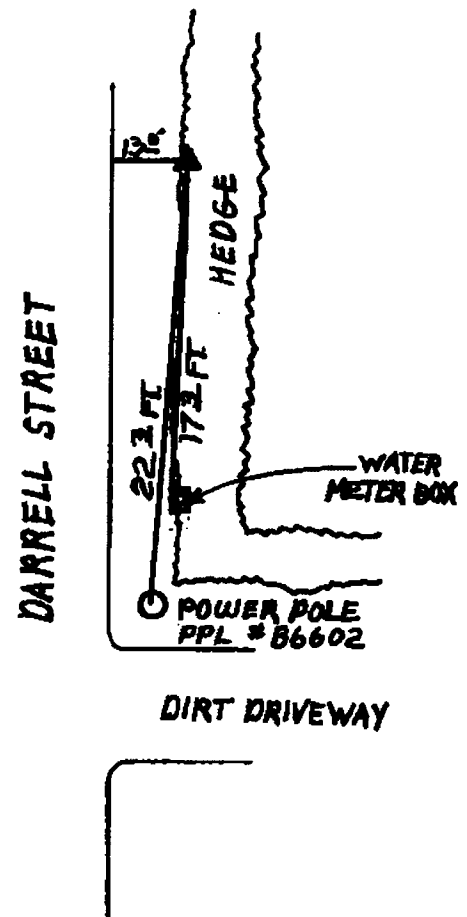

Reference Marks:

Note: For further information, contact the Douglas County Surveyor's Office, Room 205 Douglas County Justice Building, Roseburg, OR 97470. Phone 440-4278. Douglas County residents outside the Roseburg calling area, dial toll free 1-800-452-0991.