

OFFICE OF THE
DOUGLAS COUNTY SURVEYOR

Station: DAN T 27 S, R 5 W, Sec 19

Set By (Agency): DCSO

Date Set: 1982

Recovered By JP, TP

Date Recovered 7/82

Recovered By _____

Date Recovered _____

Recovered By _____

Date Recovered _____

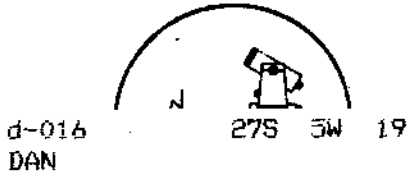
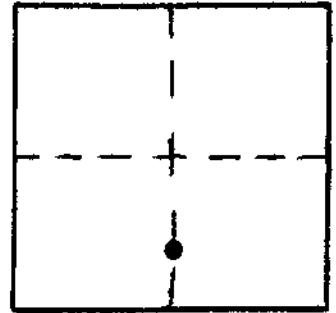

NAD 572397.09 4164652.86
83 43°12' 8" 123°20' 18"

VERTICAL CONTROL

Elevation: _____ NGS Line # _____ USGS Line # _____ OSHD Line # _____

Precision: _____ Agency: _____ Proj. # _____ Date: _____

HORIZONTAL CONTROL NAD 27

South Zone State Plane Coordinates: Y(Northing) 572,432.32 X(Easting) 1,243,694.52

Precision: 1/20,000 Agency: DCSO Proj. # 2005-2 Date: 1983

Approximate Geographic Position: Latitude 43°12'08" Longitude 123°20'13"

DESCRIPTION and TO REACH

SKETCH

DESCRIPTION:

A DCSO disk stamped "DAN 1982"
set flush in concrete curbing.

TO REACH:

From the intersection of SE Terrace Dr.
and SE Laurel Dr. proceed northerly along
SE Laurel Dr. 0.05 miles to monument
on right.

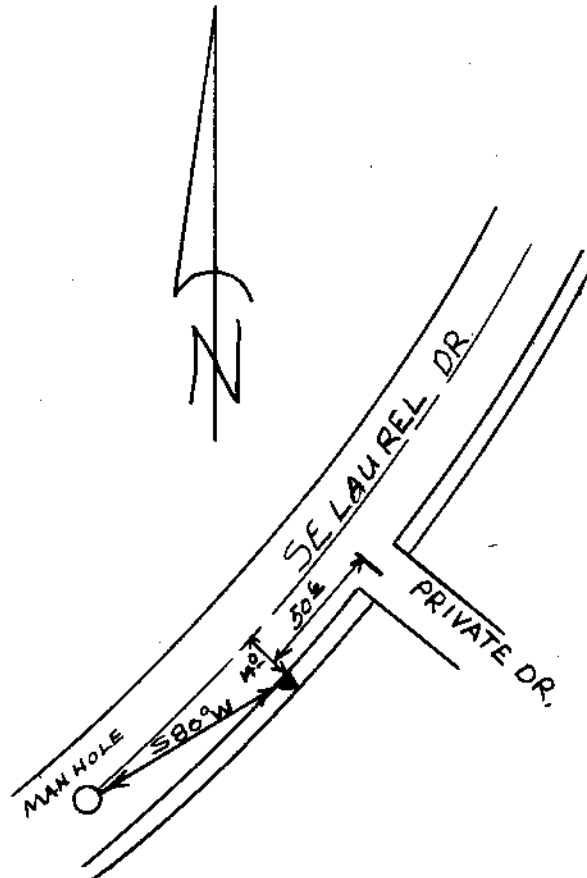

Reference Marks:

Note: For further information, contact the Douglas County Surveyor's Office, Room 205 Douglas County Justice Building, Roseburg, OR 97470. Phone 440-4278. Douglas County residents outside the Roseburg calling area, dial toll free 1-800-452-0991.