

OFFICE OF THE
DOUGLAS COUNTY SURVEYOR

Station: DAD

T 25 S, R 4W, Sec 3

Set By (Agency): SCS

Date Set: 1975

Recovered By RMS, SJE

Date Recovered 3/6/87

Recovered By _____

Date Recovered _____

Recovered By _____

Date Recovered _____

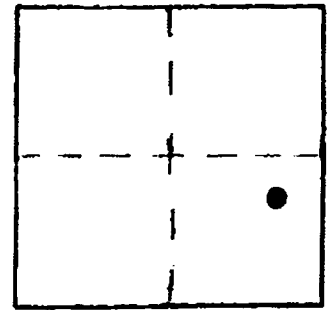

D-013



4-013
LAD

555 4W 3

440 651013.42 4217122.49
88 43°25'21" 123°08'59"

VERTICAL CONTROL CORPSCON 6 NAVD 88 904.446 FT

Elevation: 900.862 NGS Line # _____ USGS Line # _____ OSHD Line # _____

Precision: 2nd Agency: DCSO Proj. # 6011-1CS57/25 Date: 1975

HORIZONTAL CONTROL

South Zone State Plane Coordinates: Y(Northing) 651,048.71 X(Easting) 1,296,162.18

Precision: 1/25,000 Agency: DCSO Proj. # 6011-1CS57/25 Date: 1975

Approximate Geographic Position: Latitude 43°25'21" Longitude 123°08'59"

DESCRIPTION and TO REACH

SKETCH

A SCS disk stamped "DAD SCS" set in an 8 in. dia. concrete filled belltile protruding 3 in. above ground.

TO REACH:

From the intersection of Thomas Rd. (Co. Rd. #268) and Nonpariel Rd. (Co. Rd. #19) in T25S, R4W, Sec. 10, proceed northeasterly along Nonpariel Rd. approximately 1.1 miles to monument RP 265+49.88 on right. (see DCSO monument station sheet) Monument DAD bears approx. N 6° W, 1450 ft.

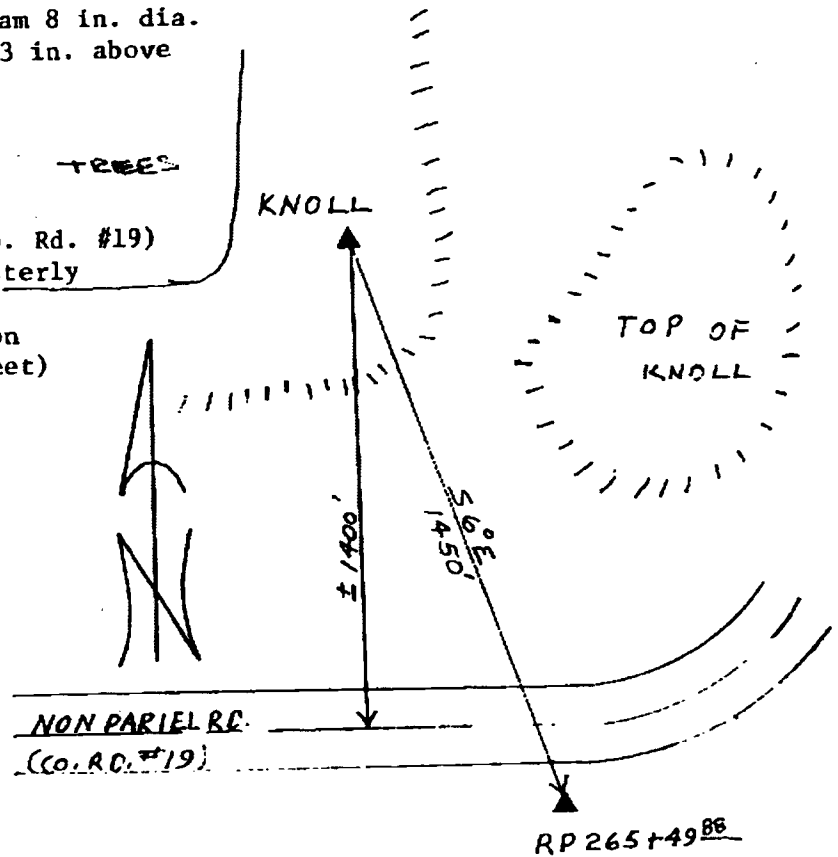

Reference Marks:

Note: For further information, contact the Douglas County Surveyor's Office, Room 205 Douglas County Justice Building, Roseburg, OR 97470. Phone 440-4278. Douglas County residents outside the Roseburg calling area, dial toll free 1-800-452-0991.