

OFFICE OF THE  
DOUGLAS COUNTY SURVEYOR

Station: C-739

T21W R4W Sec. 30

Date Set: 1987

Set By (Agency): NGS

DCSO Designation: C-147

Date Recovered: 7-93

Recovered By: SJF RWS

Date Recovered: \_\_\_\_\_

Recovered By: \_\_\_\_\_

Date Recovered: \_\_\_\_\_

Recovered By: \_\_\_\_\_

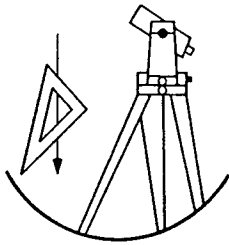
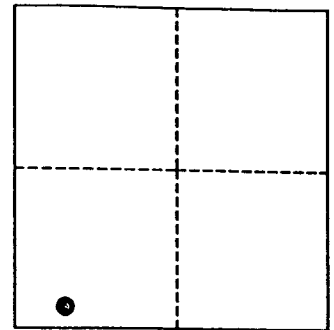

VERTICAL CONTROL

~~NGVD 29~~ <sup>NAVD 88</sup> Elevation: 399.094 FEET      NAVD 88 Elevation: 121.644 METERS

NGS Line # L25035      USGS LINE # \_\_\_\_\_      OSHD Line # \_\_\_\_\_      FILE # \_\_\_\_\_

Precision: 1ST ORDER      Agency: NGS      Proj: \_\_\_\_\_      Date: 1988

HORIZONTAL CONTROL

O.C.S. 27      Y(Northing): \_\_\_\_\_      O.C.S. 83      Y(Northing): 755480

(South Zone)      X(Easting): \_\_\_\_\_      (South Zone)      X(Easting): 4200794

Precision: GIS SCALED      Agency: DCSO      Proj: \_\_\_\_\_      Date: 2014

Approx. O.C.S. 27 Geographic Position:      Latitude: 43°42'40"      Longitude: 123°13'08"

Approx. O.C.S. 83 Geographic Position:      Latitude: \_\_\_\_\_      Longitude: \_\_\_\_\_

Found: A 3 - 5/8 inch diameter NGS disk stamped "C 739 1987" set flush and vertically in the south face near the southwest corner of State Hwy 38 concrete bridge over SPRR.

To reach: From the intersection of I-5 and State Hwy 38 in T21S R4W Sec 30, proceed westerly along State Hwy 38 0.4 miles to State Hwy 38 overpass of SPRR. Monument is at southwest corner of overpass.

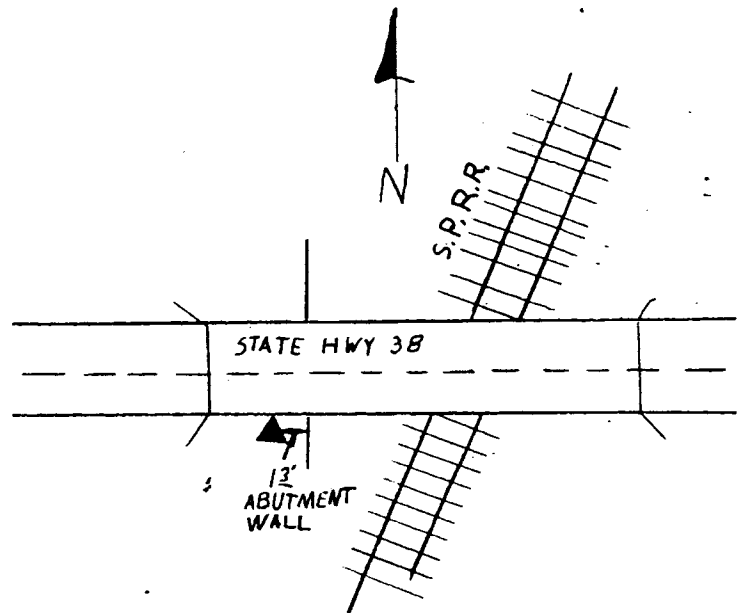

Note: For further information contact the Douglas County Surveyors Office, Room 205 Douglas County Justice Building, Roseburg, OR 97470. Phone 440-4272. Douglas County Residents outside Roseburg calling area, dial toll free 1-800-477-0991.