

OFFICE OF THE
DOUGLAS COUNTY SURVEYOR

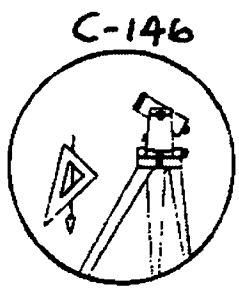

Station: Cajole
 Date Set: 1991
 Set By (Agency): DCSO
 Date Recovered: 3/11/91
 Recovered By: SJF - TF
 Date Recovered: _____
 Recovered By: _____
 Date Recovered: _____
 Recovered By: _____

T 26 S, R 6W, Sec 22

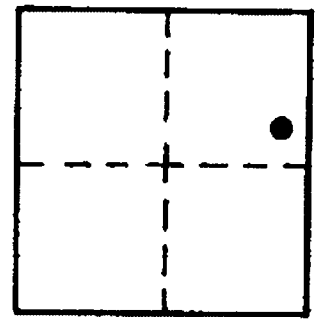

VERTICAL CONTROL NGVD 29 CORP.SCONG NAVD 88 426.861 FT
 Elevation: 423.388 NGS Line # _____ USGS Line # _____ OSHD Line # _____
 Precision: 2nd order Agency: DCSO Proj. # 2007 Date: 1991

HORIZONTAL CONTROL
 South Zone O.C.S. 27: Y(Northing) _____ X(Easting) _____
 South Zone O.C.S. 83: Y(Northing) _____ X(Easting) _____
 Precision: _____ Agency: _____ Proj. # _____ Date: _____
 Approx. NAD 83 Geographic Position: Latitude _____ Longitude _____

DESCRIPTION and TO REACH

A standard DCSO disk stamped "Cajole 1991" set in a 8" x 40" concrete filled belltile protruding 4" from the ground.

From the intersection of Del Rio Rd. (Co. Rd. #115) and Brozio Rd. (Co. Rd. #89) in T26S, R6W, sec. 14. Proceed southwesterly along Del Rio Rd. 0.70 mi. to mon. on the right.

SKETCH

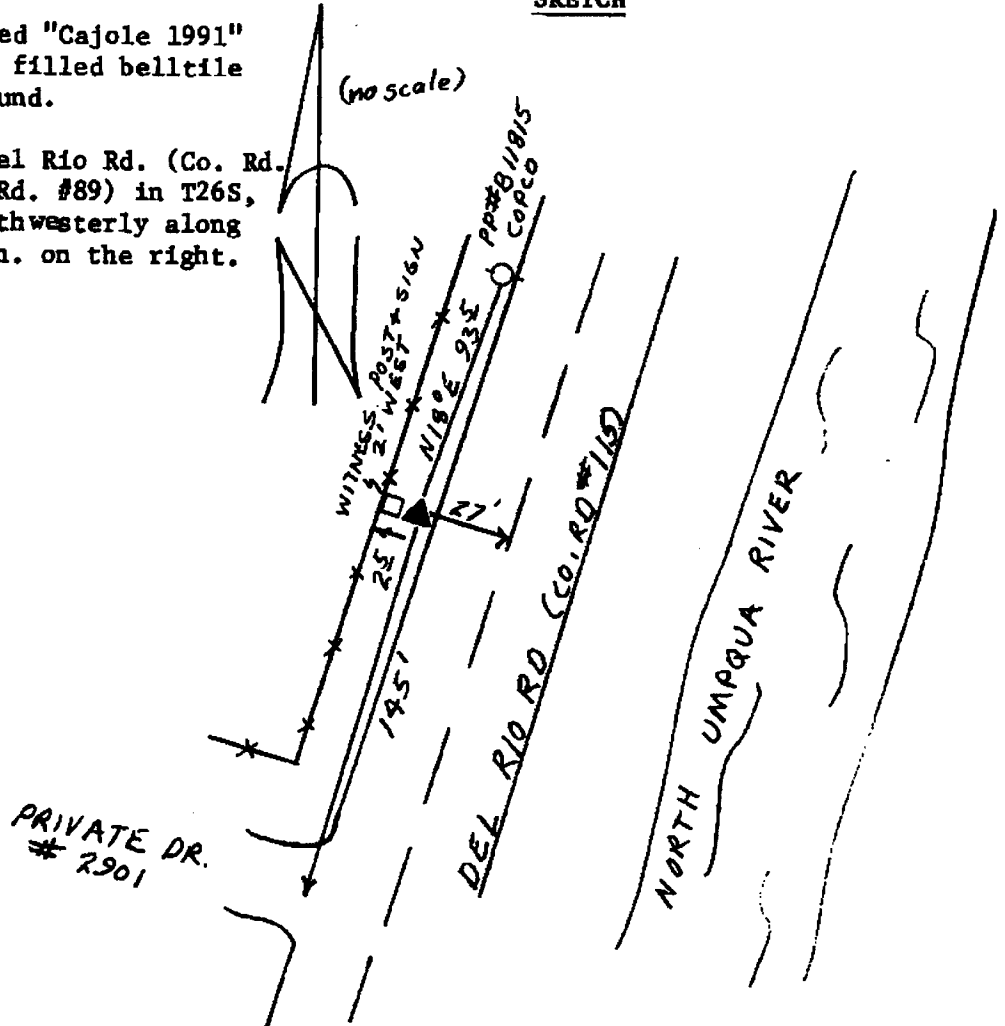

Reference Marks:

Note: For further information, contact the Douglas County Surveyor's Office, Room 205 Douglas County Justice Building, Roseburg, OR 97470. Phone 440-4278. Douglas County residents outside the Roseburg calling area, dial toll free 1-800-452-0991.