

OFFICE OF THE
DOUGLAS COUNTY SURVEYOR

Station: Cemetery 1991

T 26 S, R 4W , Sec 29

Date Set: 1991

Set By (Agency): BPA

Date Recovered: 1991

Recovered By: SJF

Date Recovered: _____

Recovered By: _____

Date Recovered: _____

Recovered By: _____

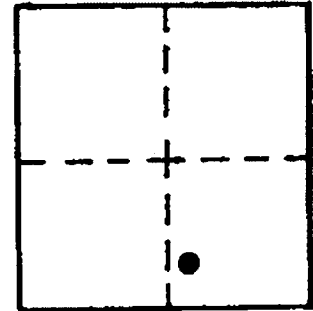

NAD 597674.76 4203131.74
83 43°16'30" 129°11'50"

VERTICAL CONTROL NGVD 29 CORPSONG NAVD 88 662.3 FT

Elevation: 658.8 NGS Line # _____ USGS Line # _____ OSHD Line # _____

Precision: GPS Agency: DCSO Proj. # 2008 Date: 1991

HORIZONTAL CONTROL

South Zone O.C.S. 27: Y(Northing) 597,710.19 X(Easting) 1,282,172.03

South Zone O.C.S. 83: Y(Northing) _____ X(Easting) _____

Precision: 1/25,000 Agency: DCSO Proj. # 2018-3 C.C.64/20 Date: 1991

Approx. NAD 83 Geographic Position: Latitude _____ Longitude _____

DESCRIPTION and TO REACH

SKETCH

Found: A U.S.D.O.E. Bonneville Power disk stamped
'U.S.D.O.E. Bonneville Pwr. Cemetery 1991"
set in concrete flush with the ground.

To Reach: From the intersection of Oak Creek Rd.
(Co. Rd. #4K) and St. Hwy 138 (just northerly from
Foster Ln.) proceed northeasterly along St.
Hwy 138 approx. 0.15 mi. to mon. on the right.

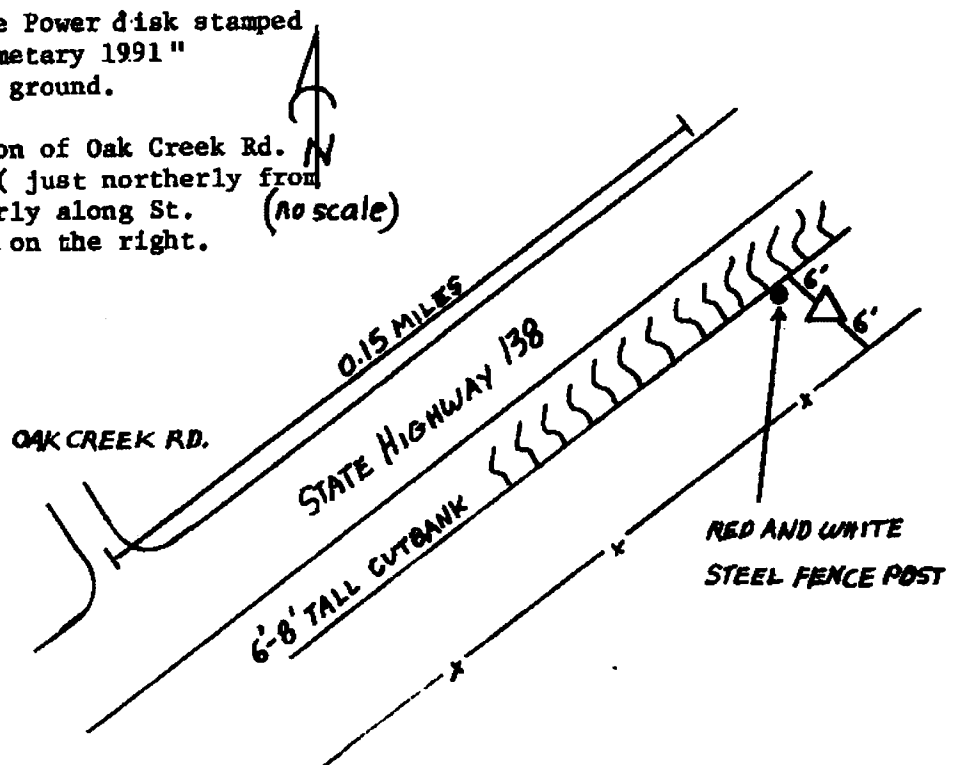

Reference Marks:

Note: For further information, contact the Douglas County Surveyor's Office, Room 205
Douglas County Justice Building, Roseburg, OR 97470. Phone 440-4278. Douglas
County residents outside the Roseburg calling area, dial toll free 1-800-452-0991.