

OFFICE OF THE
DOUGLAS COUNTY SURVEYOR

C-125

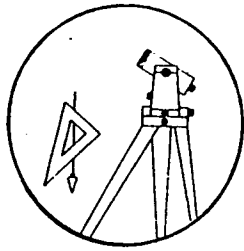

Station: CLUB T 26 S, R 6 W, Sec 34
 Set By (Agency): RLS 1005 (R. WARE)
 Date Set: 1985
 Recovered By RWS, SJF
 Date Recovered 6/13/86 - 1/25/88
 Recovered By 9/2/98
 Date Recovered _____
 Recovered By _____
 Date Recovered _____

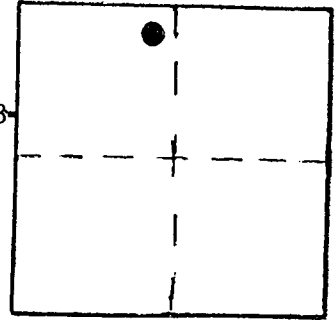

VERTICAL CONTROL

Elevation: 537.30 ft. NGS Line # _____ USGS Line # _____ OSHD Line # _____
 Precision: 3rd Agency: DCSO Proj. # 2007 CS66/027 Date: 1998

HORIZONTAL CONTROL CORPSCON6 NAVD88 540.76 FT.

South Zone State Plane Coordinates: Y(Northing) 598399 X(Easting) 4150028
 Precision: GIS SCALED Agency: DCSO Proj. # _____ Date: 2014
 Approximate Geographic Position: Latitude 43° 16' 20" Longitude 123° 23' 43"

DESCRIPTION and TO REACH

A 2 1/2 in. dia. disk set in an 8 in. dia. concrete post stamped "BM CLUB ELEV 537.05" protrudes 2 in. above ground.

From the intersection of Garden Valley Rd. (Co. Rd. #6) and Fisher Rd. (Co. Rd. #189) in T26S, R6W, Sec. 34, proceed northeasterly along Fisher Rd. approx. 0.8 miles to monument on left.

SKETCH

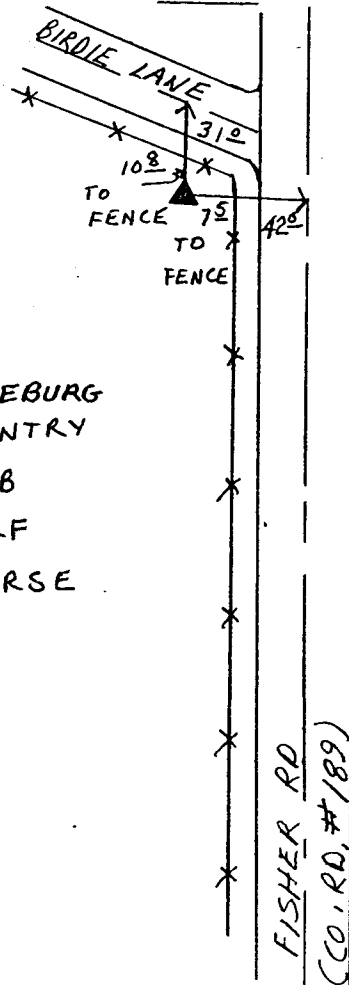

ROSEBURG
COUNTRY
CLUB
GOLF
COURSE

NOTE: ORIGINAL DCSO LEVEL NOTES LOST - THIS MONUMENT NOT CHECKED IN 12/4/00 RERUN.

Reference Marks:

Note: For further information, contact the Douglas County Surveyor's Office, Room 205 Douglas County Justice Building, Roseburg, OR 97470. Phone 440-4278. Douglas County residents outside the Roseburg calling area, dial toll free 1-800-452-0991.