

OFFICE OF THE  
DOUGLAS COUNTY SURVEYOR

Station: Co. Rd. 8 Con Mon # 2 T 22 S, R 4W, Sec 34

Set By (Agency): DCSO

Date Set: 1974

Recovered By G.Q. - T.P.

Date Recovered 1-25-82

Recovered By \_\_\_\_\_

Date Recovered \_\_\_\_\_

Recovered By \_\_\_\_\_

Date Recovered \_\_\_\_\_

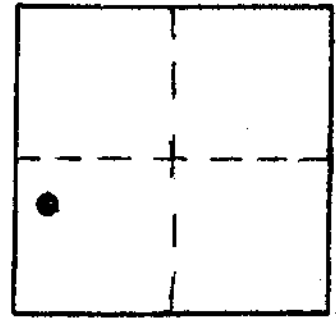

c-102 22S 4W 34  
CON MON #2(Co. Rd. #8)

NAD 719931.63 4215704.01  
83 43°36'41" 123° 9'52"

VERTICAL CONTROL

Elevation: \_\_\_\_\_ NGS Line # \_\_\_\_\_ USGS Line # \_\_\_\_\_ OSHD Line # \_\_\_\_\_

Precision: \_\_\_\_\_ Agency: \_\_\_\_\_ Proj. # \_\_\_\_\_ Date: \_\_\_\_\_

HORIZONTAL CONTROL

South Zone State Plane Coordinates: Y(Northing) 719,966.36 X(Easting) 1,294,743.48

Precision: 1/25,000 Agency: DCSO Proj. # 2004-7 CS 56/50 Date: 1974

Approximate Geographic Position: Latitude 43°36'41" Longitude 123°09'48"

DESCRIPTION and TO REACH

Found a standard DCSO disk in the center of a 6 ft. x 4 ft. boulder protruding several feet above the ground.

To reach: From the intersection of I-5 off ramp, Co. Rd. #7 and Co. Rd. #8 (in sec. 31 T22S, R4W) proceed Northeasterly along Co. Rd. #8 0.35 mi. to junction of Co. Rd. 8 and I-5 on ramp; continue along Co. Rd. 8 Easterly 2.8 mi. to sharp left hand curve and monument on the right. Monument is stamped "Co. Rd 8 Con Mon #2 1974".

SKETCH

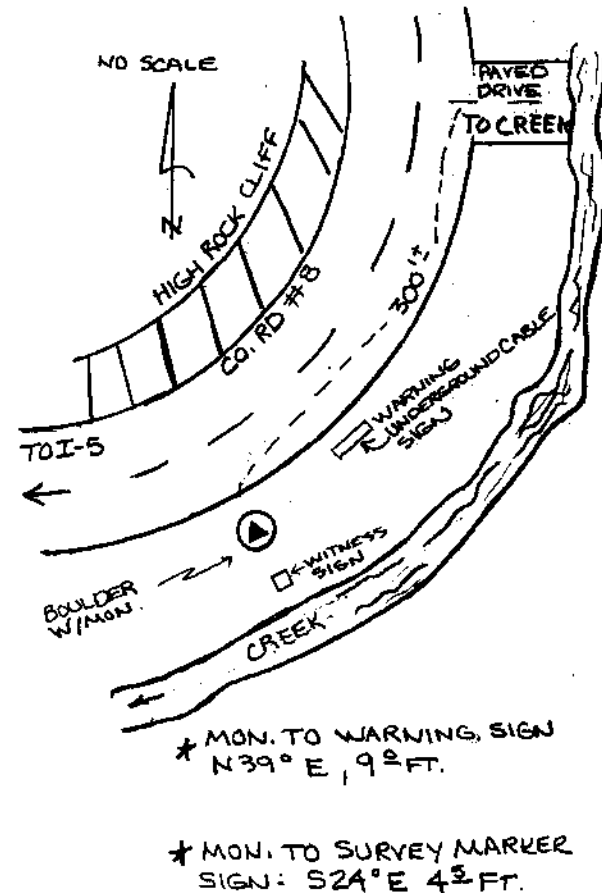

Reference Marks:

Note: For further information, contact the Douglas County Surveyor's Office, Room 205 Douglas County Justice Building, Roseburg, OR 97470. Phone 440-4278. Douglas County residents outside the Roseburg calling area, dial toll free 1-800-452-0991.