

OFFICE OF THE
DOUGLAS COUNTY SURVEYOR



C-101 25S 6W 11
CON MON #1 (Co. Rd. #10)

NAD 647223.16 4155582.76
83 43°24'23" 123°22'55"

Co. Rd. 10
Station: Con. Mon. #1
Date Set: 1974
Set By (Agency): DCSO
Date Recovered: 7-8-91
Recovered By: TF
Date Recovered: _____
Recovered By: _____
Date Recovered: _____
Recovered By: _____

T 25 S, R 6W , Sec 11

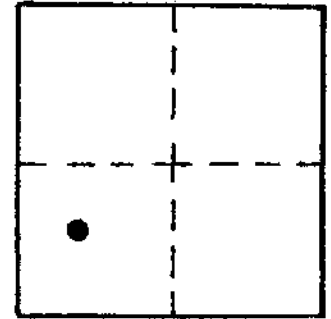

VERTICAL CONTROL

Elevation: 409.9 NGS Line # _____ USGS Line # _____ OSHD Line # _____
Precision: GPS Agency: DCSO Proj. # 2008 Date: 1991

HORIZONTAL CONTROL

South Zone O.C.S. 27: Y(Northing) 647,257.74 X(Easting) 1,234,623.67
South Zone O.C.S. 83: Y(Northing) _____ X(Easting) _____
Precision: 1/25,000 Agency: DCSO Proj. # 2004-6 C.S. 57/1 Date: 1974
Approx. NAD 83 Geographic Position: Latitude _____ Longitude _____

DESCRIPTION and TO REACH

SKETCH

Found: A standard DCSO disk stamped "Con. Mon. #1 1974"
set in a 8"x 42" concrete filled belltile protruding
4" from the ground.

To Reach: From the I-5 exit at Sutherland proceed west along Hwy
138, 2.65 mi. to intersection with Rolling Ridge Rd. Co. Rd. #10F.

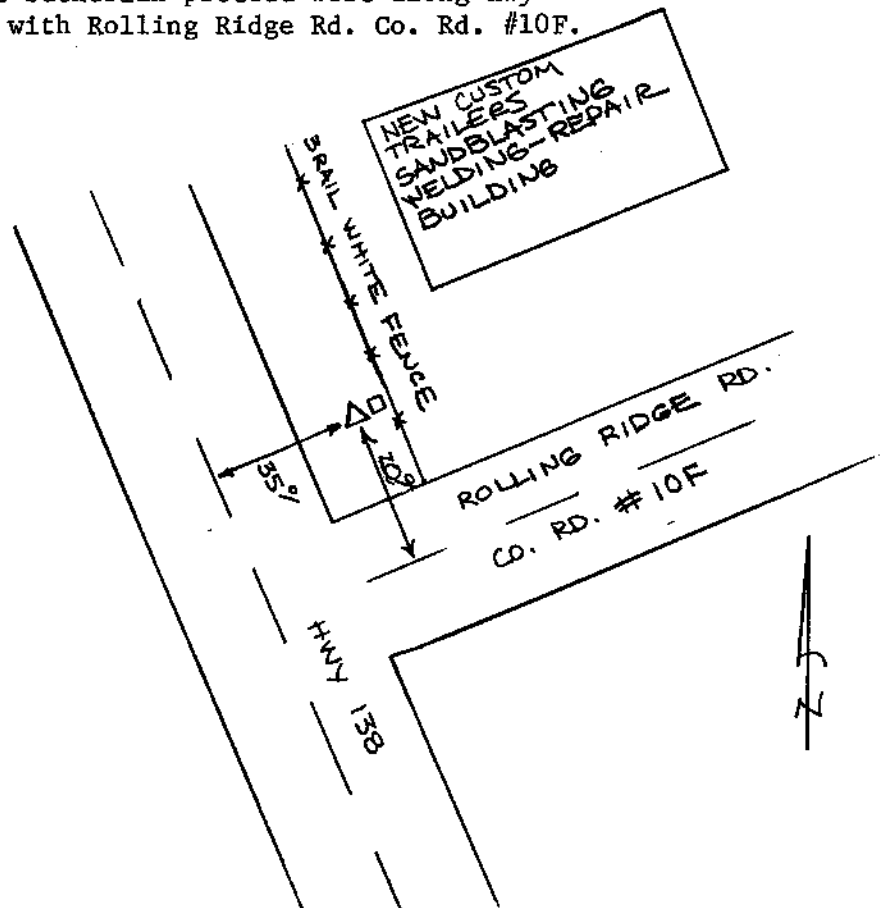

Reference Marks:

Note: For further information, contact the Douglas County Surveyor's Office, Room 205 Douglas County Justice Building, Roseburg, OR 97470. Phone 440-4278. Douglas County residents outside the Roseburg calling area, dial toll free 1-800-452-0991.