

OFFICE OF THE  
DOUGLAS COUNTY SURVEYOR

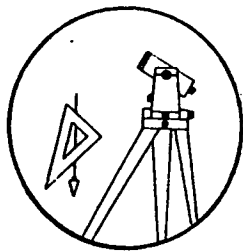

C 079

Station: CHAR T 28 S, R 6 W, Sec 10

Set By (Agency): Loosley (RLS 1507)

Date Set: 1980

Recovered By SJF, RWS

Date Recovered July 19, 1984

Recovered By \_\_\_\_\_

Date Recovered \_\_\_\_\_

Recovered By \_\_\_\_\_

Date Recovered \_\_\_\_\_

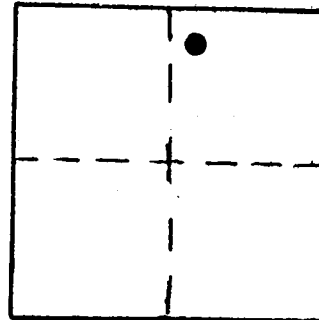

VERTICAL CONTROL NGVD 29

Elevation: 485.01 ft. NGS Line # \_\_\_\_\_ USGS Line # \_\_\_\_\_ OSHD Line # \_\_\_\_\_

Precision: 3rd. Agency: RLS 1507 and Proj. # Vol. 16, page 55 Date: 1985

HORIZONTAL CONTROL CORPSCON6 NAVD88 <sup>DCSO</sup> 488.44 FT. <sup>2013</sup> CS 66/61

South Zone State Plane Coordinates: Y(Northing) 555429 X(Easting) 9149698

Precision: GIS SCALED Agency: DCSO Proj. # \_\_\_\_\_ Date: 2014

Approximate Geographic Position: Latitude 43° 09' 14" Longitude 123° 23' 28"

DESCRIPTION and TO REACH

SKETCH

A disk stamped "BM CHAR RLS 1507 ELEV. 485.00 1980" set in a 10 inch diameter concrete filled tile flush with the ground.

TO REACH:

Go to the intersection of Stella street (Co. Rd. #246) and Char Ave. (Co. Rd. # 375) in Green (T28S, R06W, Sec. 10). Monument is in northwest corner formed by intersection.

\*Char Avenue is approximately 0.2 miles south of the intersection of Austin Rd. (Co. Rd. #207) and Stella St. (Co. Rd. #246).

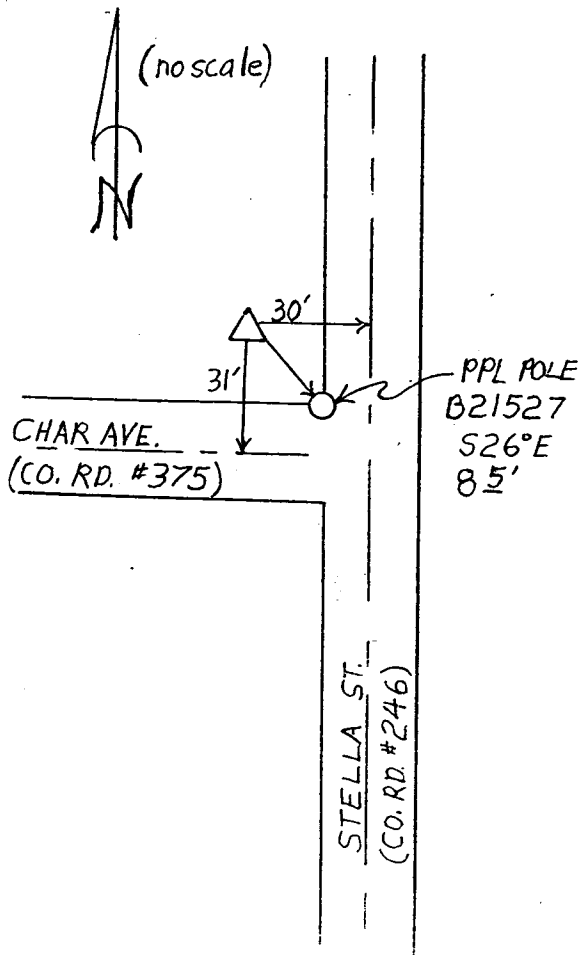

Reference Marks:

Note: For further information, contact the Douglas County Surveyor's Office, Room 205 Douglas County Justice Building, Roseburg, OR 97470. Phone 440-4278. Douglas County residents outside the Roseburg calling area, dial toll free 1-800-452-0991.