

OFFICE OF THE
DOUGLAS COUNTY SURVEYOR

Station: CASKLA T 27 S, R 5W, Sec 18
Set By (Agency): CITY(RSBG.)
Date Set: ?
Recovered By KR,JP,GQ
Date Recovered 6/82
Recovered By _____
Date Recovered _____
Recovered By _____
Date Recovered _____

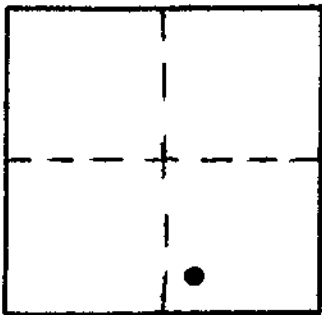

c-073
CASKLA 275 5W 18

NAD 577936.27 4165579.54
83 43°13' 3" 123°20' 8"

VERTICAL CONTROL

Elevation: _____ NGS Line # _____ USGS Line # _____ OSHD Line # _____
Precision: _____ Agency: _____ Proj. # _____ Date: _____

HORIZONTAL CONTROL **NAD 27**

South Zone State Plane Coordinates: Y(Northing) 577,971.49 X(Easting) 1,244,621.25
Precision: 1/20,000 Agency: DCSO Proj. # 2005-2 Date: 1983
Approximate Geographic Position: Latitude 43°13'03" Longitude 123°20'04"

DESCRIPTION and TO REACH

SKETCH

DESCRIPTION:

A brass cap street monument set below pavement with access cover above.

TO REACH:

Go to intersection of Casper St. and Klamath Ave.

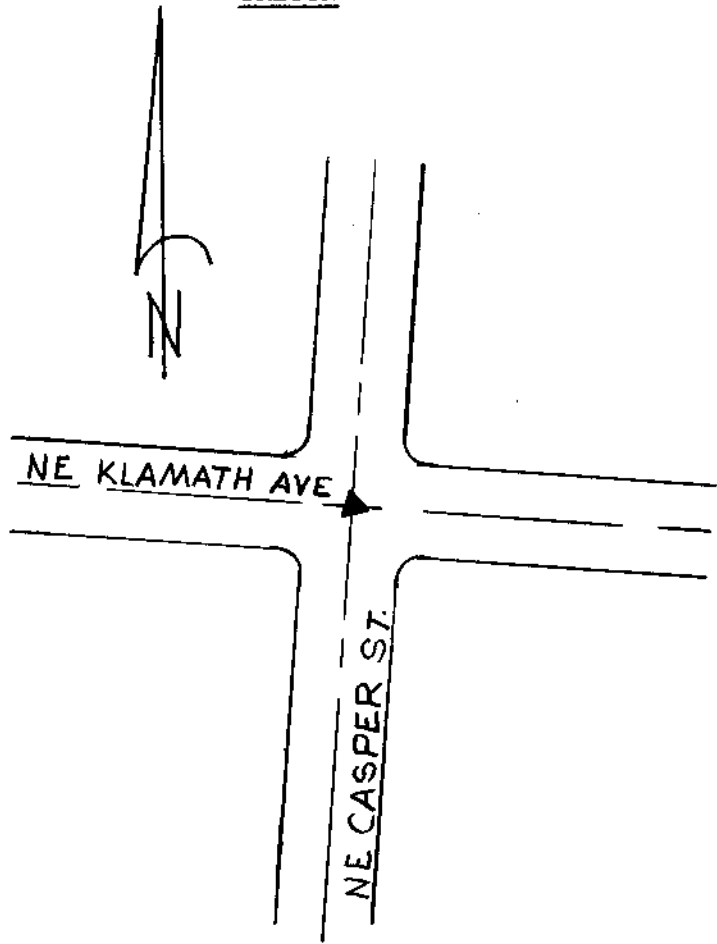

Reference Marks:

Note: For further information, contact the Douglas County Surveyor's Office, Room 205 Douglas County Justice Building, Roseburg, OR 97470. Phone 440-4278. Douglas County residents outside the Roseburg calling area, dial toll free 1-800-452-0991.