

OFFICE OF THE
DOUGLAS COUNTY SURVEYOR

Station: C-133. T 32 S, R 4W , Sec 2

Set By (Agency): DCSO

Date Set: 1973

Recovered By LEM

Date Recovered 12-3-81

Recovered By _____

Date Recovered _____

Recovered By _____

Date Recovered _____

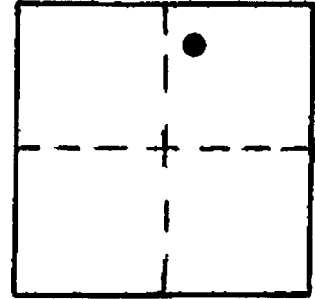

C-038
C-133

325 4W 2

NAD 432810.72 4213433.30
83 42°49'25" 123° 8'20"

VERTICAL CONTROL CORPCON 6 NAVD 88 1903.81 FT

Elevation: 1900.298 NGS Line # _____ USGS Line # _____ OSHD Line # _____

Precision: 2nd Agency: DCSO Proj. # 2006 Date: 1973

HORIZONTAL CONTROL

South Zone State Plane Coordinates: Y(Northing) 432,847.14 X(Easting) 1,292,474.42

Precision: 1/25,000 Agency: DCSO Proj. # 2006 Date: 1973

Approximate Geographic Position: Latitude 42°49'26" Longitude 123°08'16"

DESCRIPTION and TO REACH

SKETCH

Found: A standard DCSO disk stamped "C-133 1973".
Station mark is set 2 ft. South of Northerly end
of a 3ft. (inside) diam. cement culvert and is
6 ft. below Northerly edge of pavement. It lies
North, 33 ft. of centerline of Co Rd. # 36..

To reach: From intersection of Co Rd. # 36 and
BLM Rd. #31-4-27 (McGinnis Creek Rd. (in sec. 27
T31S R4W) proceed Easterly along Co Rd. #36, 3.05 mi.
to monument on the left.

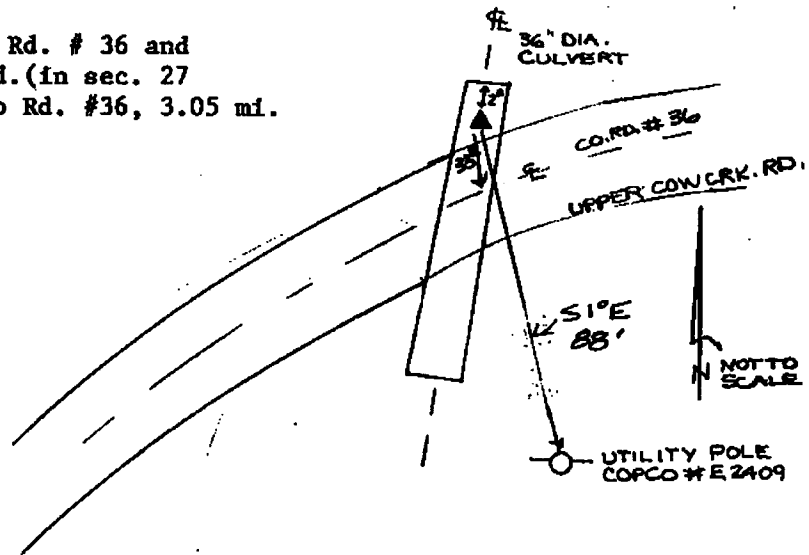

Reference Marks:

Note: For further information, contact the Douglas County Surveyor's Office, Room 205
Douglas County Justice Building, Roseburg, OR 97470. Phone 440-4278. Douglas
County residents outside the Roseburg calling area, dial toll free 1-800-452-0991.