

OFFICE OF THE  
DOUGLAS COUNTY SURVEYOR

Station: C-131 T 31 S, R 4 W, Sec 34

Set By (Agency): DCSO

Date Set: 1973

Recovered By JP, RS

Date Recovered 9/13/83

Recovered By \_\_\_\_\_

Date Recovered \_\_\_\_\_

Recovered By \_\_\_\_\_

Date Recovered \_\_\_\_\_

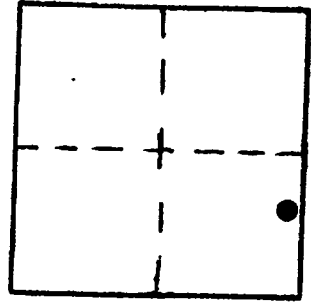

C-036  
C-131      31S 4W 34

NAD      435839.80      4210379.35  
83      42°49'54"      123° 9' 3"

VERTICAL CONTROL NGVD 29 CORCON 6 NAVD 88 1880.924 FT

Elevation: 1877.418      NGS Line # \_\_\_\_\_      USGS Line # \_\_\_\_\_      OSHD Line # \_\_\_\_\_

Precision: 2nd      Agency: DCSO      Proj. # 2006      Date: 1973

HORIZONTAL CONTROL OCS 27

South Zone State Plane Coordinates: Y(Northing) 435,876.19      X(Easting) 1,289,420.48

Precision: 1/25,000      Agency: DCSO      Proj. # 2006      Date: 1973

Approximate Geographic Position: Latitude 42°49'55"      Longitude 123°08'28"

DESCRIPTION and TO REACH

SKETCH

DESCRIPTION:

A DCSO disk stamped "C-131 1973" set in a 6"x39" concrete filled belltile.

TO REACH:

From the intersection of Upper Cow Creek Rd. (Co. Rd. #36) and McGinnis Creek Rd. (BLM Rd. #31-4-27) in T31S,R4W,Sec.27, proceed SE'stly along Co. Rd. #36 1.9 miles to monument on right (on the westerly side of the road).

\* Monument is approx. 0.2 miles easterly of scaling station.

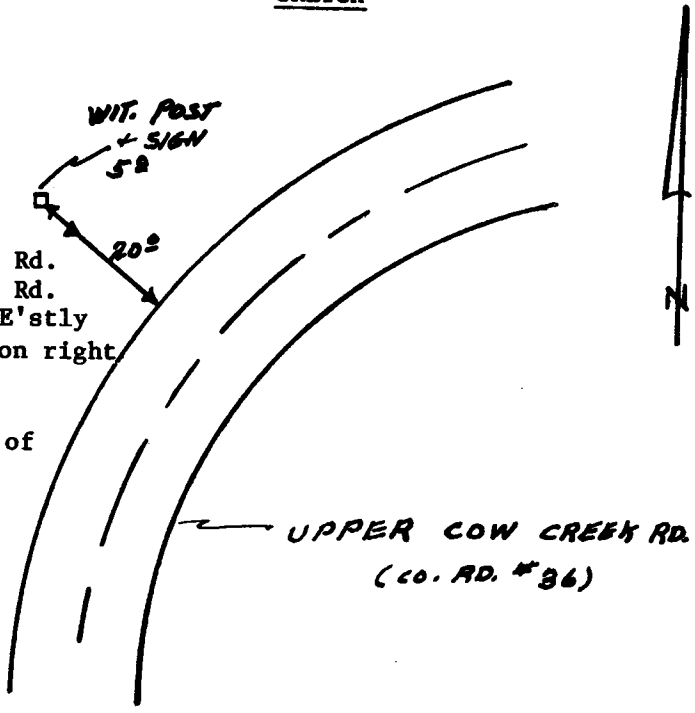

Reference Marks:

Note: For further information, contact the Douglas County Surveyor's Office, Room 205 Douglas County Justice Building, Roseburg, OR 97470. Phone 440-4278. Douglas County residents outside the Roseburg calling area, dial toll free 1-800-452-0991.