

OFFICE OF THE
DOUGLAS COUNTY SURVEYOR

Station: C-128

T 31 S, R 4W, Sec 28

Date Set: 1973

Set By (Agency): DCSO

Date Recovered: 10/90

Recovered By: SJF,TF

Date Recovered: _____

Recovered By: _____

Date Recovered: _____

Recovered By: _____

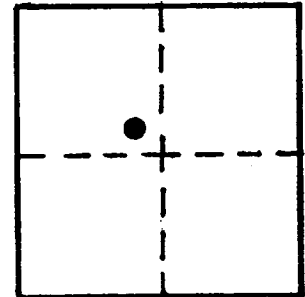

NAD 83 442724.78 42°50'59" 4201759.28 123°11' 1"

VERTICAL CONTROL NAV D 29 CORPCON 6 NAV D 88 1773.767 FT

Elevation: 1770.268 NGS Line # _____ USGS Line # _____ OSHD Line # _____

Precision: 2nd Agency: DCSO Proj. # 2006 Date: 1973

HORIZONTAL CONTROL

South Zone O.C.S. 27: Y(Northing) 442,761.10 X(Easting) 1,280,800.44

South Zone O.C.S. 83: Y(Northing) _____ X(Easting) _____

Precision: 1/25,000 Agency: DCSO Proj. # 2006 Date: 1973

Approx. NAD 83 Geographic Position: Latitude _____ Longitude _____

DESCRIPTION and TO REACH

SKETCH

A DCSO disk stamped "C-28 1973" set in a 6 in. dia. concrete filled belltile protruding 6 in. above ground.

From the intersection of BLM RD.#32-4-4, (White Horse Creek Rd.) and Co.Rd.#36, (Upper Cow Creek Rd.), in T32S,R4W, Sec. 4, proceed northerly along Upper Cow Creek Rd. approx. 2.45 miles to monument on right.

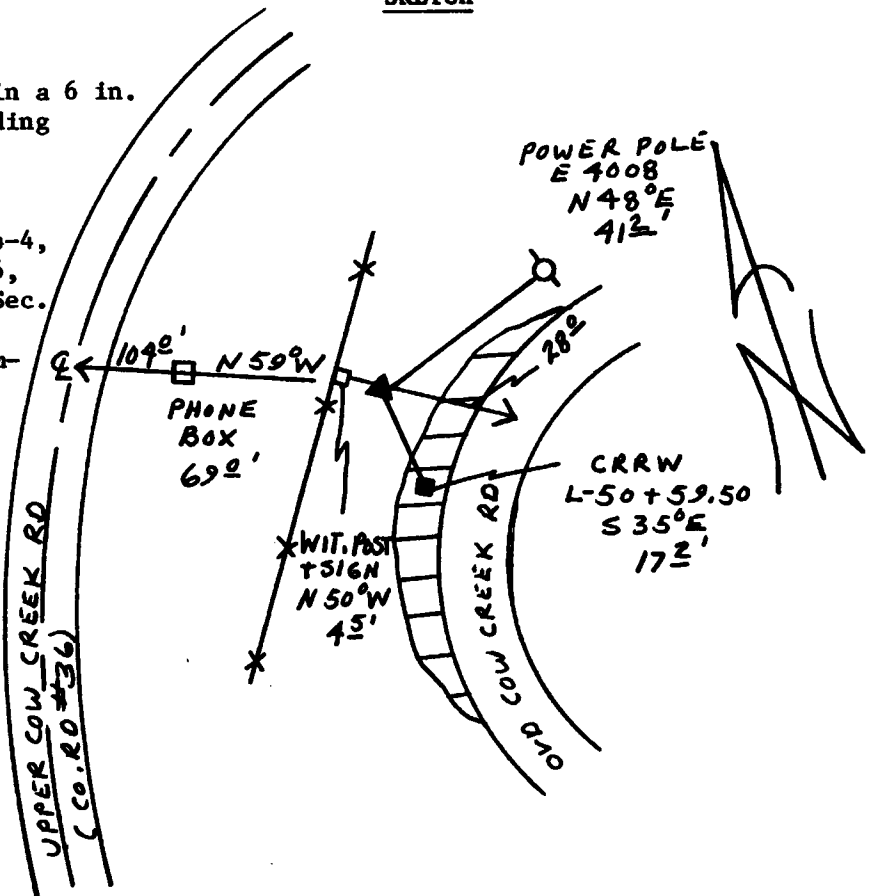

Reference Marks:

Note: For further information, contact the Douglas County Surveyor's Office, Room 205 Douglas County Justice Building, Roseburg, OR 97470. Phone 440-4278. Douglas County residents outside the Roseburg calling area, dial toll free 1-800-452-0991.