

OFFICE OF THE
DOUGLAS COUNTY SURVEYOR

Station: C-126 T 31 S, R 4W, Sec 33

Set By (Agency): DCSO

Date Set: 1973

Recovered By JP, RS

Date Recovered 9/12/90

Recovered By SJF - TF

Date Recovered 10/90

Recovered By _____

Date Recovered _____

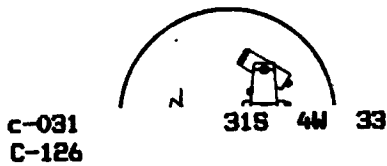
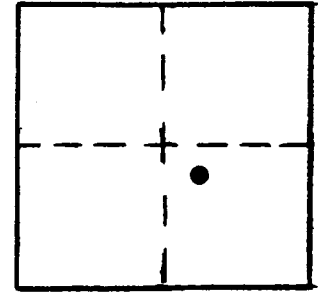

c-031
C-126

NAD 436973.17 4202758.08
83 42°50' 3" 123°10'45"

VERTICAL CONTROL NGVD 29 CORPCON 6 NAVD 88 1727.217 FT

Elevation: 1723.723 NGS Line # _____ USGS Line # _____ OSHD Line # _____

Precision: 2nd Agency: DCSO Proj. # 2006 Date: 1973

HORIZONTAL CONTROL OCS 27

South Zone State Plane Coordinates: Y(Northing) 437,009.51 X(Easting) 1,281,799.24

Precision: 1/25,000 Agency: DCSO Proj. # 2006 Date: 1973

Approximate Geographic Position: Latitude _____ Longitude _____

DESCRIPTION and TO REACH

SKETCH

Set:

A standard DCSO disk stamped "C-126 1773" set flush in boulder.

To Reach:

From the intersection of BLM Rd. #32-4-4 (White Horse Creek Rd.) and Co. Rd. #36 (Upper Cow Creek Rd.) in T32S, R4W, S.4; proceed north-easterly along Co. Rd. #36, 1.0 mi. to mon. on the right. Sta. is approx. 2 ft. lower than rd.

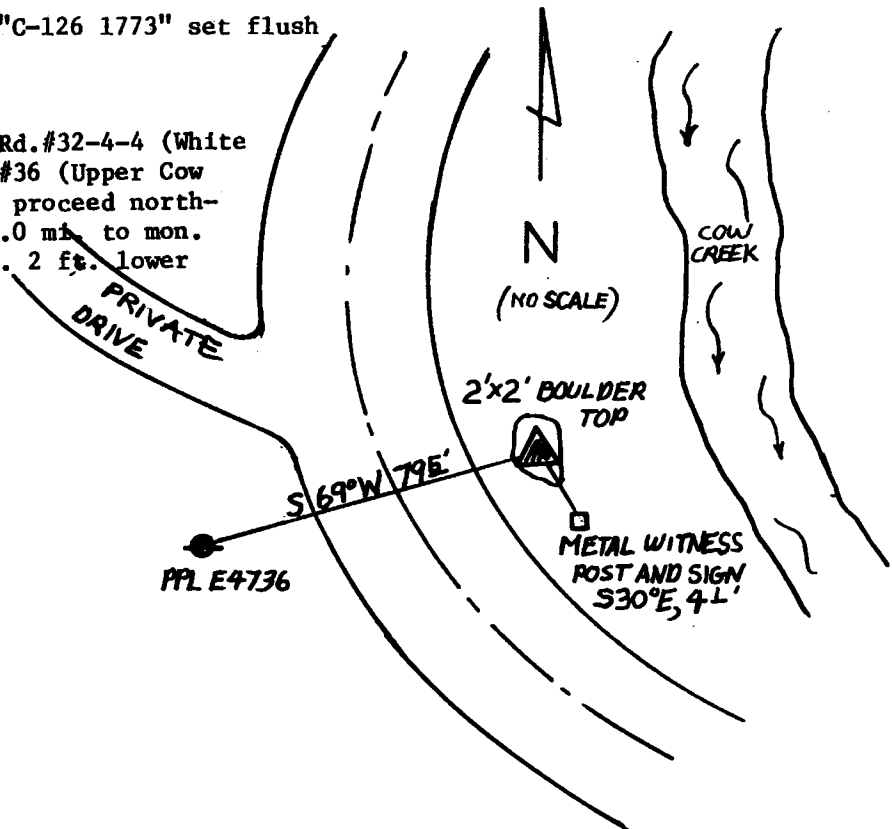

Reference Marks:

Note: For further information, contact the Douglas County Surveyor's Office, Room 205 Douglas County Justice Building, Roseburg, OR 97470. Phone 440-4278. Douglas County residents outside the Roseburg calling area, dial toll free 1-800-452-0991.