

OFFICE OF THE
DOUGLAS COUNTY SURVEYOR

Station: C-103 T 33 S, R 6 W, Sec 4

Set By (Agency): DCSO

Date Set: 1973

Recovered By RS, PB

Date Recovered 11/3/83

Recovered By RWS, SJF

Date Recovered 9/30/85

Recovered By _____

Date Recovered _____

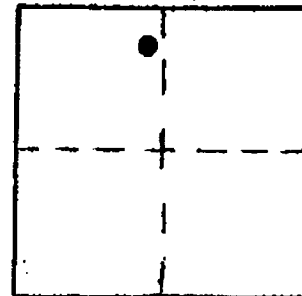

c-008
C-103

33S 6W 4

NAD 404039.27 4137790.42
83 42°44'16" 123°25' 1"

VERTICAL CONTROL CORPCON 6 NAVD 88 1405.093 FT

Elevation: 1401.724 NGS Line # _____ USGS Line # _____ OSHD Line # _____

Precision: 2nd Agency: DCSO Proj. # 2006 Date: 1973

HORIZONTAL CONTROL

South Zone State Plane Coordinates: Y(Northing) 404,075.28 X(Easting) 1,216,831.85

Precision: 1/25,000 Agency: DCSO Proj. # 2006 Date: 1973

Approximate Geographic Position: Latitude 42°44'17" Longitude 123°24'57"

DESCRIPTION and TO REACH

SKETCH

DESCRIPTION:

A DCSO disk stamped "C-103 1973" set flush on concrete curb.

TO REACH:

Go to the intersection of Sether Ave.
(Co. Rd. #313) and Glendale Hwy
(Co. Rd. #12B) in the City of Glendale.

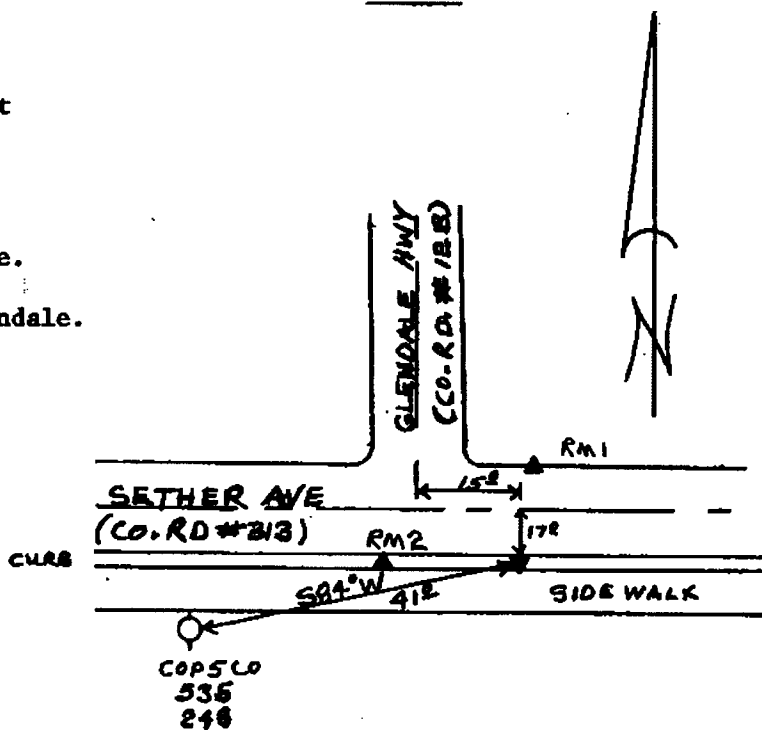

Reference Marks: (Proj. 2013)

A DCSO disk stamped "C-103 RM1 1985"
bears N 13°10'59" E, 68.19 ft. (grid) elev, 140.1374 ft.

A DCSO disk stamped "C-103 RM2 1985"
bears N 86°16'03" W, 62.32 ft. (grid) elev, 1400.202 ft.

Note: For further information, contact the Douglas County Surveyor's Office, Room 205 Douglas County Justice Building, Roseburg, OR 97470. Phone 440-4278. Douglas County residents outside the Roseburg calling area, dial toll free 1-800-452-0991.